

trivTM series rain cover



nuna®



Thank **you!**

You've just purchased a Nuna product, and you can be sure that your child is getting the best there is. Our products are expertly engineered for safety, with luxury fabrics and sophisticated style. Whatever made you fall in love with Nuna, rest assured your adventures with your little one will be easier from now on, freeing you to enjoy more happy family moments together.



IMPORTANT!
KEEP THESE
INSTRUCTIONS FOR
FUTURE REFERENCE!
READ CAREFULLY

Contents

Product Information	4
Warranty	4
Contact	4
Compatibility	4
Warnings	5
Parts List	5
Product Use and Storage	6
Cleaning and Maintenance	10

Product Information

Model Number: _____

Manufactured in (date): _____

Warranty

We have purposely designed our high-quality products so that they can grow with both your child and your family. Because we stand by our product, our gear is covered by a custom warranty per product, starting from the day it was purchased. Please have the proof of purchase, model number and manufactured in date available when you contact us.

For warranty information, please visit:
www.nunababy.com/warranty

Contact

For replacement parts, service, or additional questions, please contact our customer service department.

infousa@nunababy.com
nunababy.com
1.855.NUNA.USA

Compatibility

This rain cover is compatible with Nuna TRIV™ series strollers.

! WARNING

Failure to follow these warnings and instructions could result in serious injury or death.

A child's safety is your responsibility. **NEVER** leave your child unattended.

Use only on the Nuna TRIV™ series stroller. **DO NOT** attempt to use on any other stroller or product.

ALWAYS check ventilation when the rain cover is on the product.

DO NOT place your child in the stroller assembled with rain cover during hot weather.

DO NOT fold the stroller with the rain cover in place.

Clean and dry the rain cover before storing.

Parts List

Make sure all parts are available before assembly. If any part is missing, please contact Nuna (see page 4 for information). No tools are required for assembly.

- 1 Storage Pouch
- 2 Back Strap
- 3 Bottom Strap
- 4 Window

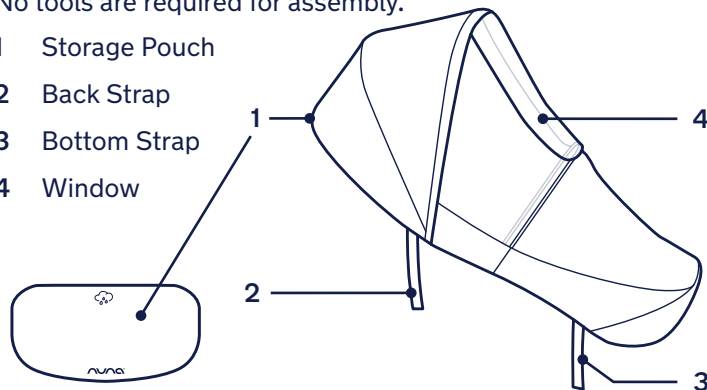

Product Use and Storage

- 1 - Open the stroller canopy.
- 2 - Unzip the storage pouch and pull out the rain cover.
- 3 - Place the rain cover over the stroller.
- 4 - Zip the storage pouch (1) and secure the opening in the rain cover around the recline adjustment button on the back of the stroller canopy (2).
- 5 - Attach the hook and loop on the back strap.
- 6 - Secure the rain cover around the stroller calf support.

(continued on the next page)

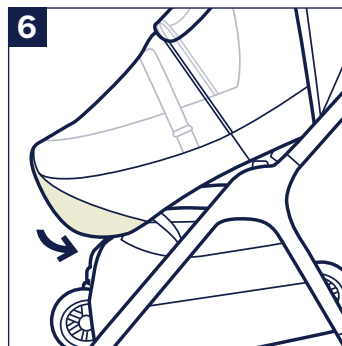
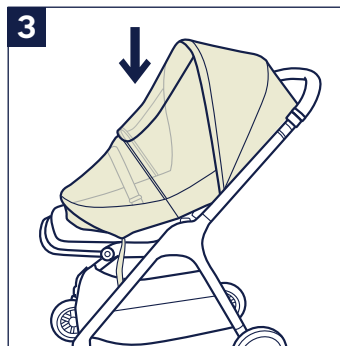
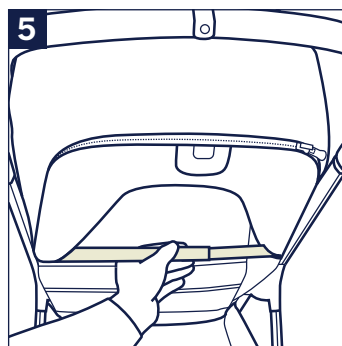
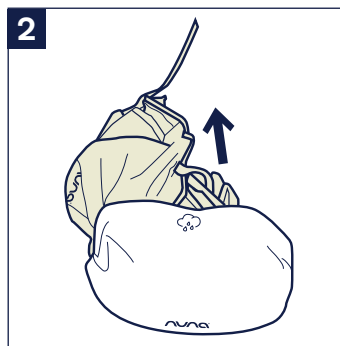
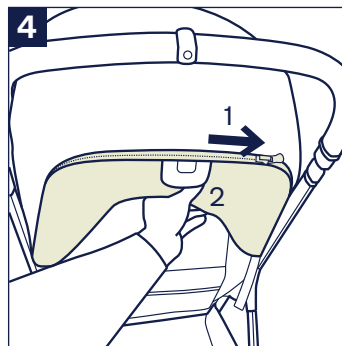
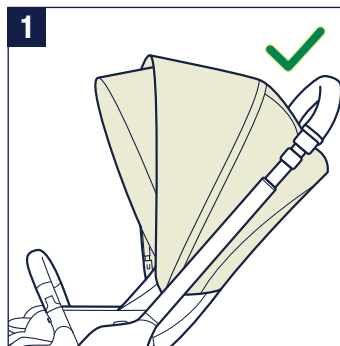

Product Use and Storage *(continued)*

7 - Attach the hook and loop on the bottom strap.

8 - Lift the window to easily reach your child.

9 - To remove the rain cover, reverse steps 3–7.

To store, fold the rain cover and wrap the storage pouch around it. Zip to close.

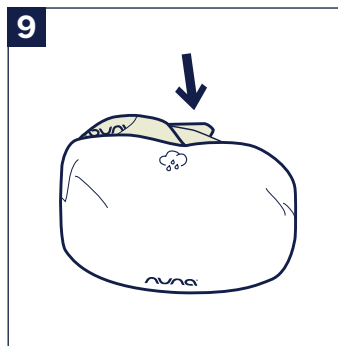
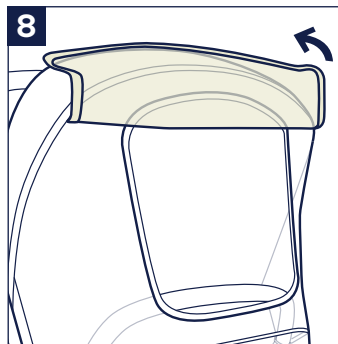
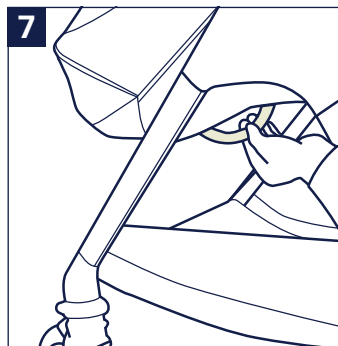

Cleaning and Maintenance

Wipe clean with a damp cloth.

Check regularly if everything functions properly. If any parts are torn, broken, or missing, stop using this product.

