

# 請妥善保存本說明書以備 不時之需!

使用產品前請仔細閱讀本說明書，  
並妥善保存以供日後參照。不依照本說明書的指示  
操作，可能會影響到您寶寶的安全。

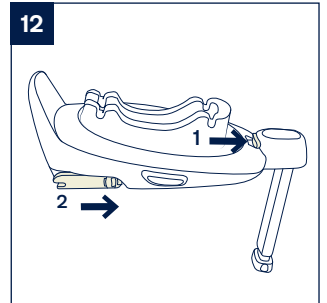

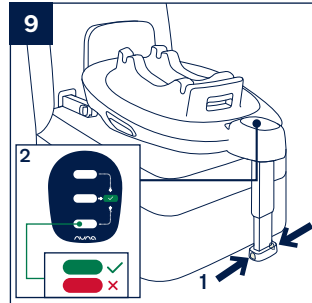

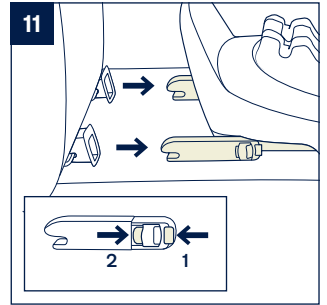
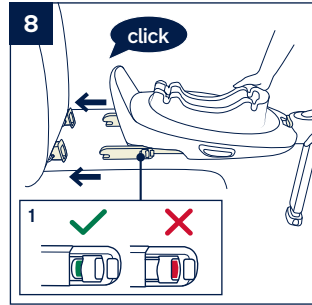
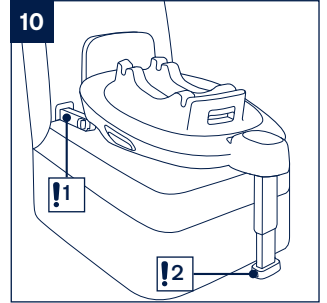
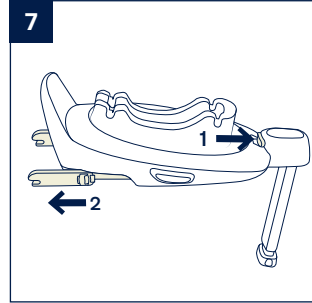
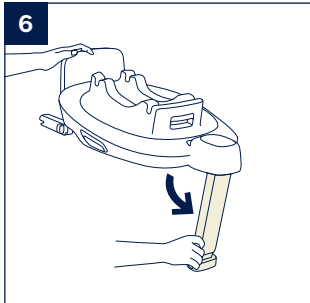
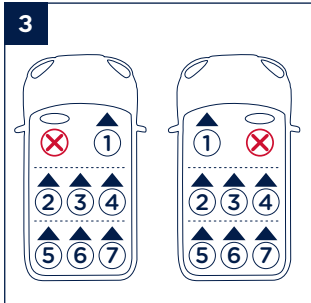
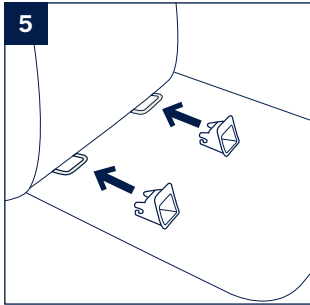
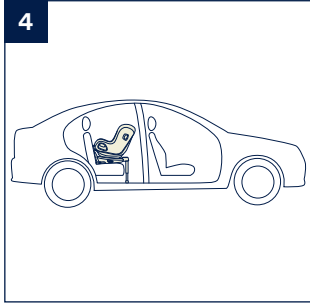
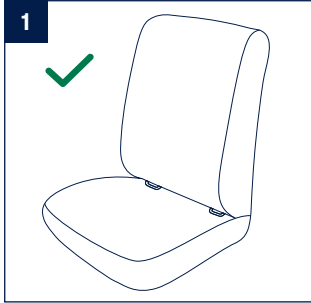
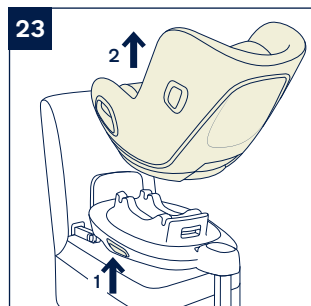
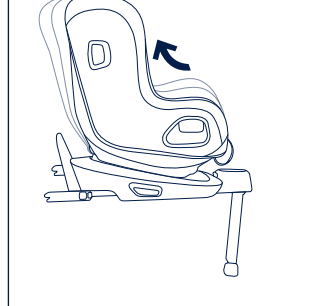
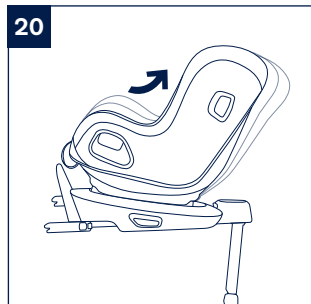
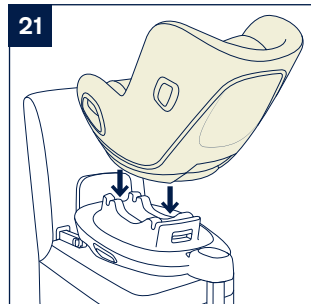
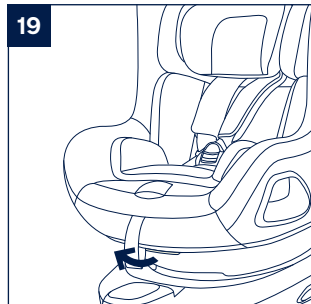
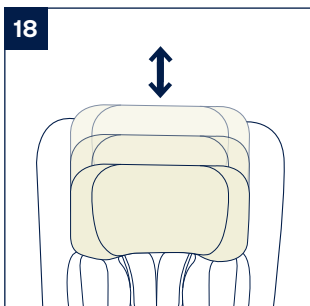
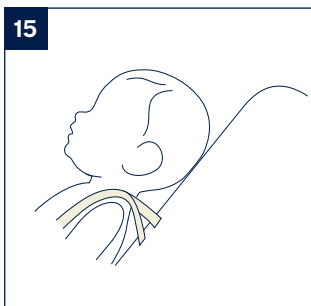
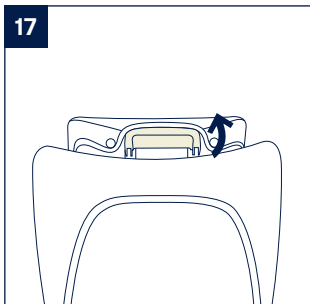
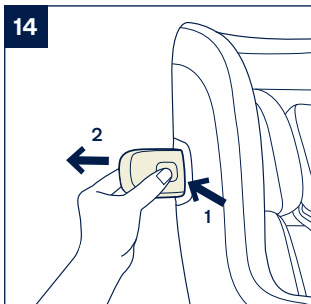
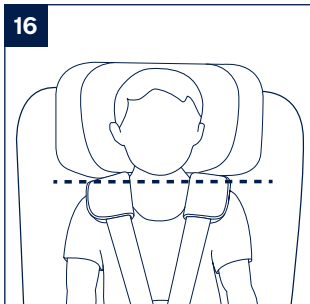
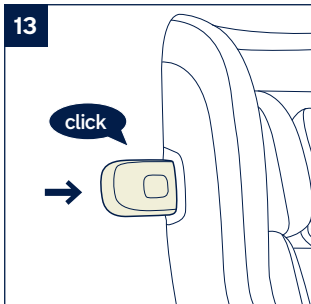
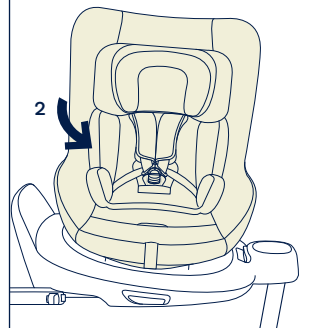
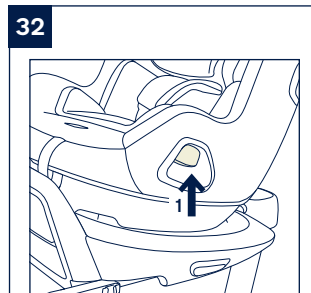
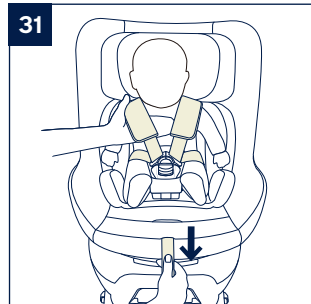
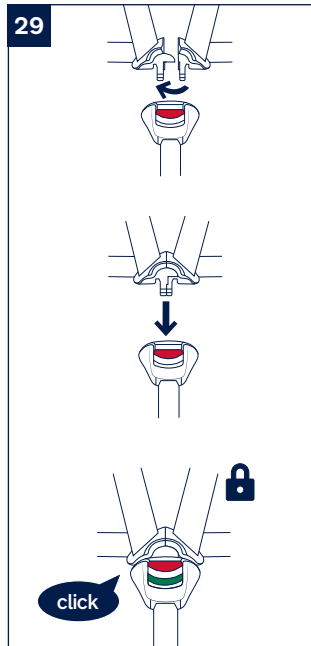
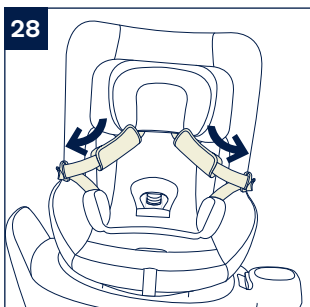
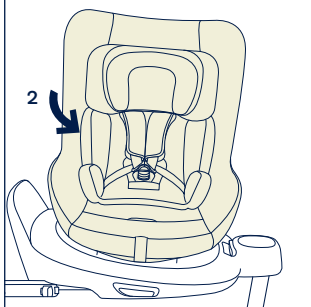
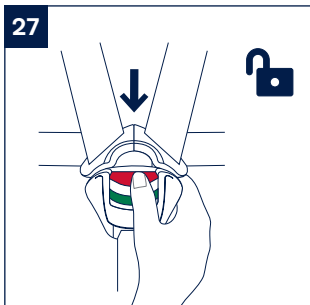
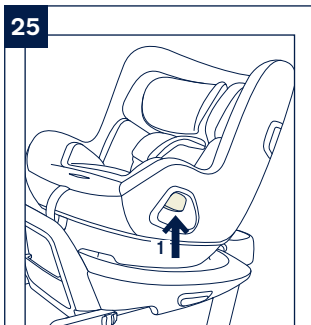
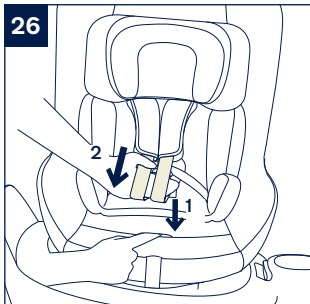
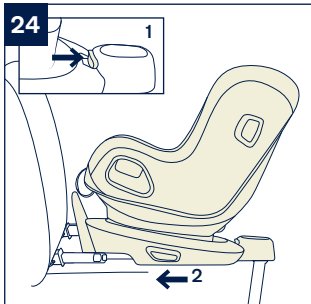

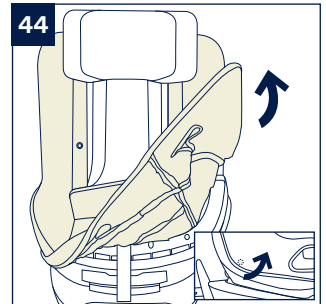
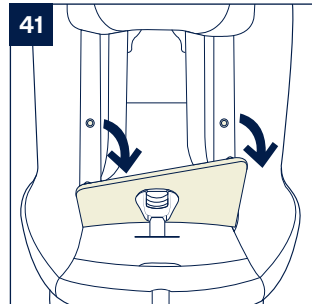
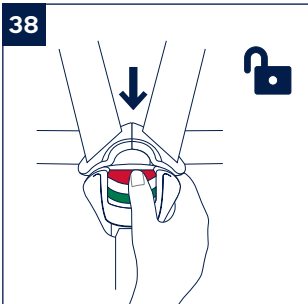
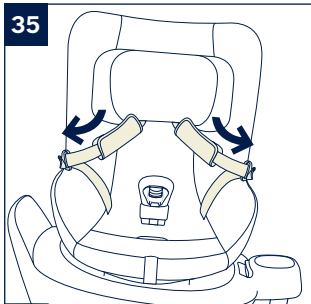
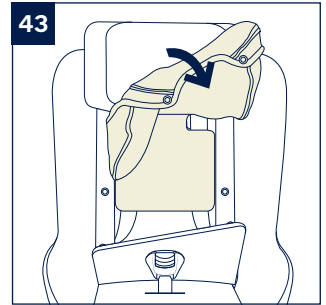
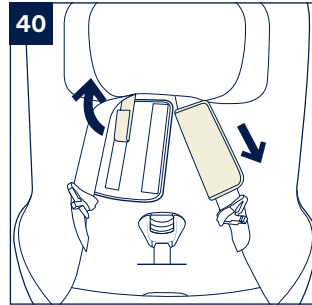
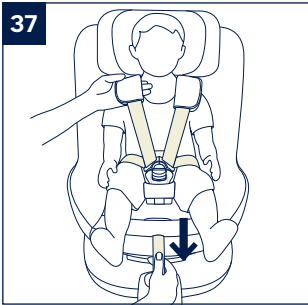
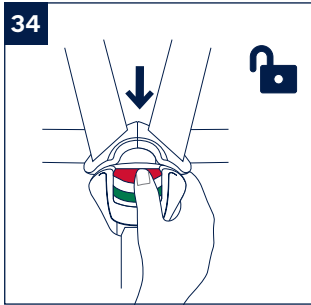
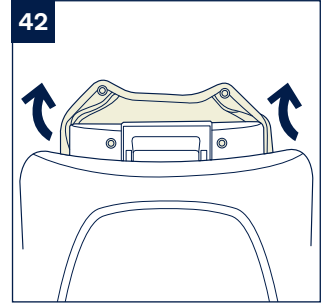
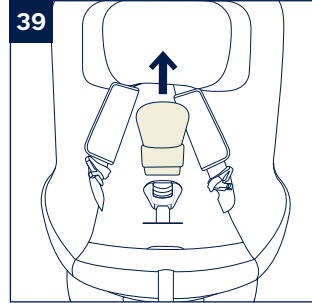
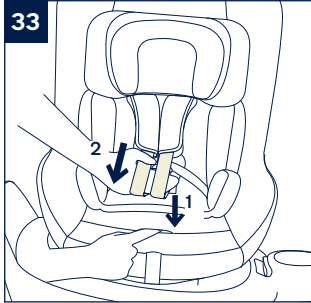

*Designed*  
around your life

## 目錄

產品資訊	3
保固與售後服務	
保固條件	
聯絡我們	
兒童使用要求	5
安全須知與注意事項	5
警告	6
產品組件及各部件名稱	8
產品安裝	9
產品使用	9
維修與保固	12
汽車安裝資訊	13
<b>English</b>	<b>14</b>



## 產品資訊

產品名稱: \_\_\_\_\_

生產日期: \_\_\_\_\_

### 保固與售後服務

產品於保固期間內發生問題，請與零售商聯絡；若零售商無法提供服務，他們會聯絡當地的Nuna經銷商。請留意產品底部的產品型號與生產日期序號。當有保固需求時，請提供以上產品資訊。請至[www.nunababy.com/tw/gear-registration](http://www.nunababy.com/tw/gear-registration)網站登記您購買的產品。

### 保固條件

保固始於產品購買日。我們提供維修服務，但不提供產品退換。保固期限不會因零件更換或維修而延長。Nuna有權利針對產品進行改善設計，此前製造的產品則無更換之義務。

相關保固資訊，詳見官網: [www.nunababy.com/tw/warranty](http://www.nunababy.com/tw/warranty)

### 聯絡我們

我們期望不斷改進並開發新的產品，請隨時告知您對Nuna產品的意見和建議。

[taiwanservice@nunababy.com](mailto:taiwanservice@nunababy.com)  
[www.nunababy.com/tw](http://www.nunababy.com/tw)

品 名	汽車用兒童保護裝置
型 號	TODL next , CS149
適用範圍	18公斤（約4歲）以下的寶寶
質量等級	0+級 / I 級
主要材質	塑膠、五金、布
原 產 地	中國
委 製 商	巧兒宜國際股份有限公司
進 口 商	巧兒宜國際股份有限公司
地 址	台北市內湖區瑞光路431號2樓
電 話	02-27973000
統一編號	52603333
代 理 商	杏豐實業股份有限公司
地 址	台北市中華路一段59號10樓之1
電 話	02-66358858
統一編號	16998578

## 兒童使用要求

您的孩子必須完全符合以下要求，才可以使用本產品：

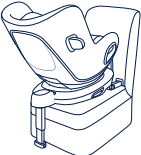
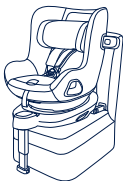
實質體重	安裝模式	安裝圖示	參考年齡	背靠段位	小座墊說明
0-18kg	後向模式		新生兒-4歲	第1-5段	小座墊可以提供完整的側撞保護功能。適用0-6個月的寶寶，也可以依照寶寶的體型調整使用方式。
9-18kg	前向模式		2-4歲	第1-5段	請勿使用小座墊。

## 安全須知與注意事項

- 1- 此為ISOFIX兒童保護裝置。符合標準CNS 11497。用於裝有ISOFIX固定器系統之車輛座椅。
- 2- 它安裝適用於車輛配有經認可之ISOFIX安裝位置。(請參照車輛使用手冊)請依此兒童保護裝置之種類及ISOFIX尺度等級，安裝於附有ISOFIX固定器之車輛座椅上。
- 3- 此兒童保護裝置使用之質量等級為0+級 / I 級，ISOFIX尺寸等級為：B1、C。
- 4- 此兒童保護裝置與底座組合構成“半通用型”兒童保護裝置，符合標準CNS 11497。用於裝有ISOFIX固定裝置的車輛。
- 5- 其他車輛型式亦有可能適用此兒童保護裝置。若有疑問，請洽兒童保護裝置製造商或進口商。

## 警告

必須小心定位和安裝兒童保護裝置，以免被可移動車輛座椅或車門卡住。

對後向兒童保護裝置，不得使用於裝置空氣囊之車輛座椅位置。

兒童保護裝置適用於體重18kg(約4歲)以下的兒童。

前向安裝勿提供2歲以下兒童乘坐，超過2歲兒童，仍宜儘量使用後向安裝。

任何束縛兒童之織帶應根據兒童身體進行調整，且此織帶不應扭曲。

將寶寶放在本兒童保護裝置後，必須正確的扣合及使用兒童保護裝置安全帶，並確保腰部織帶能有效束縛骨盆部位。

本兒童保護裝置若於意外中遭受劇烈撞擊後，不可繼續使用，應立即更換兒童保護裝置。意外可能導致兒童保護裝置產生潛在危險。

請勿擅自改造本兒童保護裝置，或使用其他廠商生產的零件來配合本兒童保護裝置使用，會對寶寶造成危險。沒有認證許可的產品和經過改裝的產品是危險的，沒有製造商提供的安裝說明也是很危險的。

請讓兒童保護裝置遠離日光，以免產品溫度過高對兒童的皮膚造成傷害。

在無人照料下，不得讓兒童留在兒童保護裝置內。

任何行李或其他可能在碰撞中造成傷害之物品應適當牢固。

當本兒童保護裝置沒有座布時，請勿使用，因座布為兒童保護裝置束縛性能之整體構成要件。請勿使用非本製造商推薦的座布，否則會影響兒童保護裝置的總體性能。

不可使用除使用說明書中所標註以外之其他受力點。

使用此兒童保護裝置時，請搭配閱讀車輛使用手冊。



請勿使用其它廠商生產的兒童保護裝置座墊。請與進口商聯繫只可使用Nuna配件更換零件。

不正確使用或安裝本兒童保護裝置，當緊急剎車和急轉彎時，可能會導致嚴重受傷或死亡的危險。

有關零件更換或維修問題，請向進口商諮詢。

請勿使用說明書中未有顯示的任何配件。

請勿將未固定住的兒童保護裝置留在車內，以免緊急剎車時，傷害到其他乘客。若不經常使用兒童保護裝置時，請將其搬離汽車座椅。

請勿使用已經損壞或缺失零件的兒童保護裝置。請勿使用切割過的、磨損的或損壞的兒童保護裝置。

請勿把本兒童保護裝置當作平常的椅子使用，會容易翻倒造成傷害。

請勿讓您的寶寶穿過大的衣物，所穿的衣物必須能讓兒童保護裝置的安全帶適當而安全地扣在寶寶兩腿之間。

請勿使用二手兒童保護裝置或來歷不明的兒童保護裝置，因為它們可能存在危害乘坐兒童安全的潛在危險。

請勿在未閱讀或了解本兒童保護裝置說明書及汽車說明書之前，使用或安裝本兒童保護裝置。因為可能會導致嚴重受傷或死亡的危險。

使用本產品前，請取掉PE袋和包裝材料，並放到嬰兒和兒童觸摸不到的地方。

產品本體必須搭配底座BASE next，單獨使用有安全疑慮。

## 產品組件及各部位名稱

- |           |               |
|-----------|---------------|
| 1 頭靠      | 11 ISOFIX調整按鈕 |
| 2 座墊      | 12 本體釋鎖按鈕     |
| 3 安全扣     | 13 支撐腳        |
| 4 織帶調整按鈕  | 14 支撐腳調整按鈕    |
| 5 調整織帶    | 15 ISOFIX導向器  |
| 6 背靠調整按鈕  | 16 側撞防護盾      |
| 7 旋轉按鈕    | 17 ISOFIX連接器  |
| 8 肩帶護片    | 18 說明書存放處     |
| 9 小座墊     | 19 旋轉按鈕       |
| 10 頭靠調整拉桿 |               |

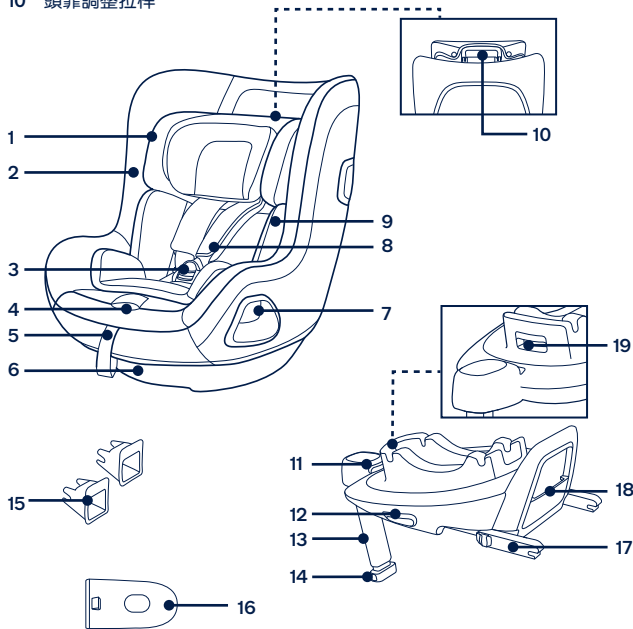

## 產品安裝

### 安裝注意事項

- ! 此兒童保護裝置只適合安裝在設置有ISOFIX固定裝置的汽車座椅上 (1)
- ! 對後向兒童保護裝置，不得使用於裝置空氣囊之車輛座椅位置 (2)
- ! 請勿將此兒童保護裝置安裝在相對於汽車的行駛方向橫向或後向的汽車座椅上 (3)
- ! 請將此兒童保護裝置安裝於汽車後座 (4)
- ! 請勿將此產品安裝於可移動的汽車座椅上。

## 產品使用

### 底座安裝

- 1- 將ISOFIX導向器固定到ISOFIX固定點上 (5)，ISOFIX導向器既可防止汽車座椅表面被刮破，又可為ISOFIX連接器導向。
- 2- 展開底座支撐腳 (6)
- 3- 按壓ISOFIX調整按鈕拉出ISOFIX連接器 (7)
- 4- 按壓ISOFIX調整按鈕調整ISOFIX導向器，將ISOFIX連接器與ISOFIX導向器對齊後，將ISOFIX連接器插到ISOFIX固定點上(8)
  - ! 請確定左右兩邊的ISOFIX連接器都已牢固固定到ISOFIX固定點上。且兩個ISOFIX連接器上的指示器應顯示綠色 (8)-1
  - ! 同時往外拉兩邊的ISOFIX連接器，以確保ISOFIX連接器已固定。
- 5- 將底座置於合適的汽車座椅，將支撐腳延伸到地面 (9)。支撐腳正確安裝時，支撐腳指示器顯示綠色，否則顯示紅色 (9)-2
  - ! 支撐腳有多個調整段位，支撐腳指示器顯示紅色時，表示支撐腳處於錯誤段位，請重新操作至正確位置為止。
  - ! 請確保支撐腳與汽車地面完全接觸。
  - ! 按壓支撐腳調整按鈕可將支撐腳向上調整 (9)-1

底座安裝好後如(10)所示。

- ! ISOFIX連接器須鎖定在ISOFIX固定點上 (10)-1
  - ! 底座支撐腳須正確固定，並以綠色顯示 (10)-2
- 6- 移除底座時，按壓兩側ISOFIX連接器上的第二道安全鎖(11)-1與釋鎖按鈕(11)-2，然後將底座向外拉即可 (11)
  - 7- 按壓ISOFIX調整按鈕可將ISOFIX連接器儲存在底座下方 (12)

### 使用側撞防護盾

- 1- 兒童保護裝置的側撞防護盾必須安裝在最靠近汽車車門的一側。才能更好的保護兒童的安全 (13)
- 2- 按壓釋鎖按鈕即可釋鎖側撞防護盾 (14)

### 頭靠及肩帶高度調整

調整頭靠位置，並且檢查肩帶是否在適當位置 (15) - (18)

- ! 使用後向模式時，肩帶高度需與寶寶的肩膀相同或略低於寶寶的肩膀 (15)
  - ! 使用前向模式時，肩帶高度需與寶寶的肩膀相同 (16)
- 按壓頭靠調整拉桿 (17)，同時上下滑動頭靠到合適高度，頭靠高度共有6個段位，調整如(18)所示。

### 背靠角度調整

- 1- 按壓背靠調整按鈕，即可滑動兒童保護裝置本體，將座椅角度調整到合適段位 (19)
- 2- 後向或前向使用的背靠角度調整都有5個段位，背靠角度如(20)所示。

## 後向模式

(0-18kg/新生兒-4歲的寶寶)

- ! 請先將兒童保護裝置安裝到汽車後座椅上，再讓寶寶乘坐。
- 1- 將兒童保護裝置卡入底座內 (21)，如果兒童保護裝置固定正確，兒童保護裝置指示器將顯示綠色 (22)
  - 2- 釋鎖兒童保護裝置時，先將寶寶抱出，按壓本體釋鎖按鈕 (23)-1，同時將本體往上提即可 (23)-2。僅在後向模式時本體才可以安裝或釋鎖。

- 3- 按壓ISOFIX調整按鈕，將兒童保護裝置緊靠汽車座椅背靠 (24)
- 4- 按壓旋轉按鈕可以旋轉本體，方便兒童從側面進出 (25)
- ! 按壓任意一側的旋轉按鈕都可以旋轉兒童保護裝置本體。
- 5- 按壓織帶調整按鈕，同時將肩帶（從肩帶護片下方）拉出至適當長度 (26)
- 6- 按壓紅色按鈕，鬆開安全扣 (27)
- 7- 將扣具固定在兒童保護裝置兩側有磁鐵的區域 (28)

### 使用小座墊

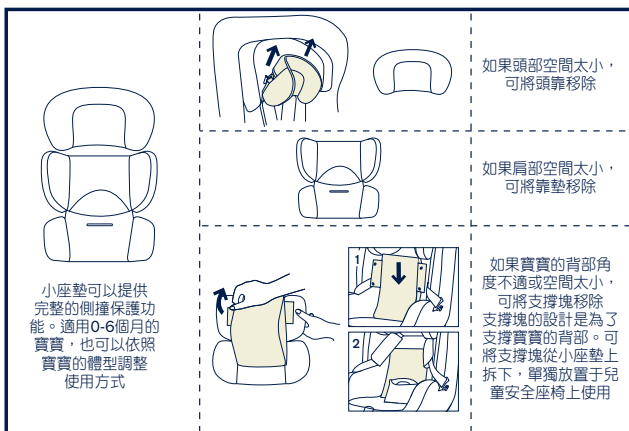

- 8- 將寶寶放入兒童保護裝置內，再將寶寶兩臂穿過安全帶。
- 9- 扣好安全扣 (29)
- 10- 按壓旋轉按鈕，將本體旋轉至後向模式，指示器將顯示綠色 (30)
- 11- 下拉調整織帶，調整肩帶至適當長度，以配合寶寶身形 (31)
- ! 確保寶寶與肩帶之間須可以放進一個手掌的厚度。

## 前向模式

(9-18kg/2-4歲的寶寶)

- ! 請先將兒童保護裝置安裝到汽車後座椅上，再讓寶寶乘坐。
- 1- 按壓旋轉按鈕可以旋轉本體，方便兒童從側面進出 (32)
- ! 按壓任意一側的旋轉按鈕都可以旋轉兒童保護裝置本體。
- 2- 按壓織帶調整按鈕，同時將肩帶（從肩帶護片下方）拉出至適當長度 (33)
- 3- 按壓紅色按鈕，鬆開安全扣 (34)
- ! 前向使用時請勿使用小座墊。
- 4- 將扣具固定在兒童保護裝置兩側有磁鐵的區域 (35)
- 5- 按壓旋轉按鈕，將本體旋轉至前向模式，指示器將顯示綠色 (36)
- 6- 下拉調整織帶，調整肩帶至適當長度，以配合寶寶身形 (37)
- ! 確保寶寶與肩帶之間須可以放進一個手掌的厚度。
- ! 前向安裝勿提供2歲以下兒童乘坐，超過2歲兒童，仍宜儘量使用後向安裝。

### 拆卸和組裝座布

按壓紅色按鈕，鬆開安全扣(38)。參考(39)-(44) 步驟即可拆卸座布。  
反向操作即可組裝座布。

## 維修與保固

請以30度以下水溫清洗。

請勿使用熨斗熨燙。

請勿使用漂白劑及乾洗。

請勿使用未經稀釋的中性清潔劑、汽油或其他有機溶劑清洗兒童保護裝置，否則可能對兒童保護裝置造成損壞。

使用溫和的洗滌劑，水和柔軟的布清洗兒童保護裝置。

請勿大力扭乾，過分大力扭乾可能留下皺褶。

請於陰涼處鋪平晾乾。

當長時間不使用本兒童保護裝置時，請將本兒童保護裝置從汽車座椅上拆除，並存放於陰涼處及寶寶不易接觸的地方。

## 汽車安裝資訊

此兒童保護裝置被歸類為“半通用型”，適用安裝在大部分(並非全部)之車輛座椅位置。下圖中的數字與“汽車安裝資訊”內的數字相對應。其他車輛型式亦有可能適用此兒童保護裝置，以下車型為車款安裝適配性資料。若有疑問，請洽兒童保護裝置製造商或進口商。

前向安裝勿提供2歲以下兒童乘坐，超過2歲兒童，仍宜儘量使用後向安裝。

請勿將本兒童保護裝置安裝在汽車前座上。

切勿將後向兒童保護裝置置於有空氣囊的座位上，防止發生死亡或嚴重傷害。

購買車輛前，請檢查其是否配置有相應的連接裝置。

- 表示汽車座椅可安裝本兒童保護裝置。
- ✘ 表示汽車座椅不可安裝本兒童保護裝置。



表示符合i-Size的車輛。

如果您的汽車品牌未被列入本說明書或未用“●”或“✘”進行標示，請查閱您的汽車手冊或聯絡兒童保護裝置製造商，以進一步了解相關資訊。



**IMPORTANT!**  
**KEEP THESE**  
**INSTRUCTIONS FOR**  
**FUTURE REFERENCE:**  
*READ CAREFULLY*

## Contents

<b>Product information</b>	17
Product Registration	
Warranty	
Contact	
<b>Child Usage Requirements</b>	18
<b>Warning</b>	19
<b>Parts List</b>	21
<b>Product Set Up</b>	23
<b>Product Use</b>	23
<b>Cleaning and Maintenance</b>	28
<b>Vehicle Fitting Information</b>	29

## Product Information

Model Number: \_\_\_\_\_

Manufactured Date: \_\_\_\_\_

### Product Registration

Please fill in the above information. The model number and the manufactured date are located at the bottom of the enhanced child restraint.

To register your product please visit:

[www.nunababy.com](http://www.nunababy.com)

Click the "Register Gear" link on the homepage.

### Warranty

We have purposely designed our high-quality products so that they can grow with both your child and your family. Because we stand by our product, our gear is covered by a custom warranty per product, starting from the day it was purchased. Please have the proof of purchase, model number and manufactured date available when you contact us.

For warranty information please visit:

[www.nunababy.com](http://www.nunababy.com)

Click the "Warranty" link on the homepage.

### Contact

For replacement parts, service, or additional warranty questions, please contact our customer service department.

[info@nunababy.com](mailto:info@nunababy.com)

[www.nunababy.com](http://www.nunababy.com)

**NUNA International B.V.**

Van der Valk Boumanweg 178 C

2352JD Leiderdorp

The Netherlands

**In the United Kingdom:**

[infouk@nunababy.com](mailto:infouk@nunababy.com)

[www.nunababy.com](http://www.nunababy.com)

## Child Usage Requirements

This product is suitable for use with children who meet the following requirements:

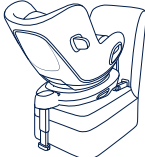
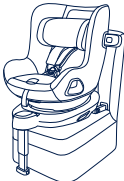
Child's Size	Installation Mode	Figure for Installation	Reference Age	Seat Position	Infant Insert Instructions
40cm-105cm/ ≤18kg	Rearward Facing Mode		<4 years	Position 1-5	We recommend using the full infant insert while the baby is under 60cm and ≤13kg. It can be used until they outgrow the insert. The infant insert increases side impact protection.
76cm-105cm/ ≤18kg	Forward Facing Mode		2 years to 4 years	Position 1-5	Remove the infant insert when forward facing mode.

- 1 - This is an "i-Size" Enhanced Child Restraint System. It is approved according to CNS 11497, for use in, i-Size compatible vehicle seating positions as indicated by vehicle manufacturers in the vehicle users' manual.
- 2 - If in doubt, consult either the Enhanced Child Restraint System manufacturer or the retailer.

## WARNING

Failure to follow these warnings and instructions could result in serious injury or death.

**DO BE** cautious that the rigid items and plastic parts of an enhanced child restraint system shall be located and installed so that they are not liable to become trapped by a moveable seat or in a door of the vehicle.

**DO NOT** use the rearward facing enhanced child restraint system in seating positions where there is an active frontal airbag installed.

To use this enhanced child restraint according to CNS 11497, your child must meet the following requirements.

Rearward Facing:

Child height 40cm-105cm/ Child weight  $\leq 18$ kg;

Forward Facing:

Child height 76cm-105cm/ Child weight  $\leq 18$ kg;

**IMPORTANT - DO NOT USE FORWARD FACING BEFORE THE CHILD'S AGE EXCEEDS 2 YEARS** (Refer to instructions)

Any support-leg should be in contact with the vehicle floor and any straps restraining the child should be adjusted to the child's body. The straps should not be twisted.

Ensure that any lap strap is worn low down, so that the pelvis is firmly engaged, shall be stressed.

This enhanced child restraint should be replaced when it has been subject to violent stresses in an accident. An accident can cause damage to it that you cannot see.

Consider the danger of making any alterations or additions to the device without approval of the adequate authority, and the danger of not following closely to the installation instructions provided by the enhanced child restraint manufacturer.

Please keep this enhanced child restraint away from direct sunlight, otherwise it may become too hot for child's skin. Always test the temperature by touching the enhanced child restraint before placing child in it.

Children should not be left unattended in their enhanced child restraint system.

Any luggage or other objects liable to cause injuries in the event of a collision shall be properly secured.

The enhanced child restraint may not fit in all approved vehicles when used in one of these positions.

The enhanced child restraint system shall **NOT BE USED** without the soft goods.

The soft goods should not be replaced with any other than the one recommended by the manufacturer, because the soft goods constitutes an integral part of the restraint performance.

The instructions should be retained on the enhanced child restraint for its life period.

Please also pay attention to the instructions and warnings in the vehicle manufacturer's handbook.

# Parts List

Make sure all parts are available before assembly. If any part is missing, please contact local retailer. No tools are required for assembly.

- |    |                               |    |  |
|----|-------------------------------|----|--|
| 1  | Head Support                  | 11 | ISOFIX Adjustment Button               |
| 2  | Seat Pad                      | 12 | Child Restraint Release Button         |
| 3  | Buckle                        | 13 | Load Leg                               |
| 4  | Webbing Adjustment Button     | 14 | Load Leg Adjustment Button             |
| 5  | Adjustment Webbing            | 15 | ISOFIX Guides                          |
| 6  | Recline Adjustment Button     | 16 | Side Impact Protection Pod             |
| 7  | Rotating Button               | 17 | ISOFIX Connector                       |
| 8  | Shoulder Harness Covers       | 18 | Instruction Manual Storage Compartment |
| 9  | Infant Insert                 | 19 | Infant Carrier Rotation Button         |
| 10 | Head Support Adjustment Lever |    |  |

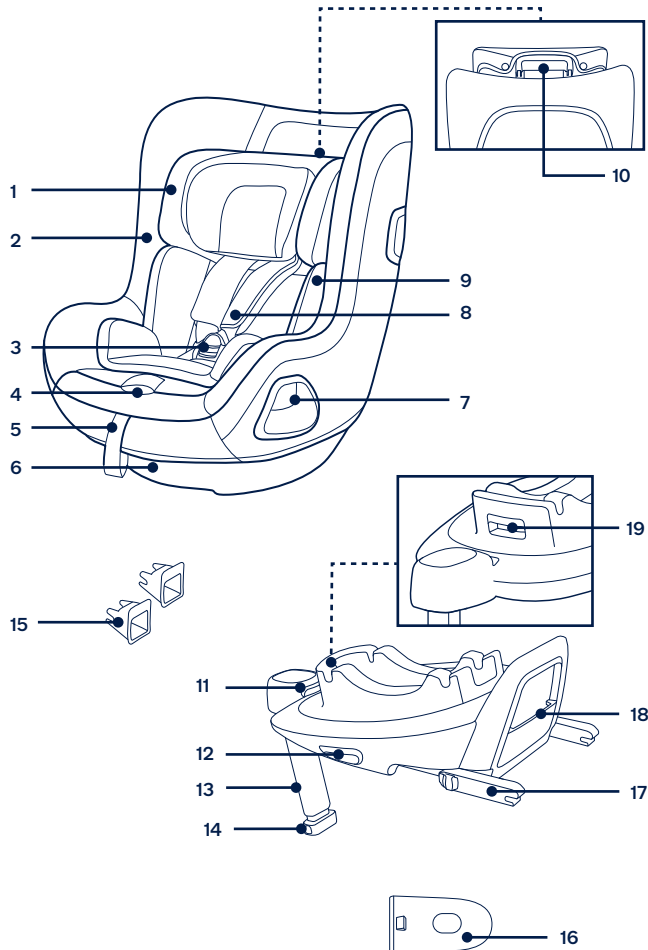



# Product Set Up

## Installation Concerns

This enhanced child restraint system is only suitable for vehicle seats equipped with ISOFIX anchorage bars. (1)

**DO NOT** use the rearward facing enhanced child restraint system in seating positions where there is an active frontal airbag installed. (2) Death or serious injury may occur. Please reference vehicle owner's manual for more information.

**DO NOT** install this enhanced child restraint system on vehicle seats that face sideways or rearward with respect to the moving direction of the vehicle.

Please refer to your vehicle owner's manual for recommended or suggested installation positions. (3)

It is recommended to install this enhanced child restraint on the rear vehicle seat. (4)

**DO NOT** install this enhanced child restraint system on movable vehicle seats.

## Product Use

### Base Installation

- 1 - Attach the ISOFIX guides to the vehicle's ISOFIX anchor bars (see vehicle owner's manual). (5) The ISOFIX guides can protect the surface of the vehicle seat from being torn. They can also guide the ISOFIX connectors. (5)
  - 2 - Unfold the load leg from storage compartment. (6)
  - 3 - Extend the ISOFIX connectors by pressing the ISOFIX adjustment button while pulling on the connector. (7)
  - 4 - Press the ISOFIX adjustment button to adjust the ISOFIX connectors. Line up the ISOFIX connectors with the ISOFIX guides, and then click both ISOFIX connectors into the ISOFIX anchor bars. (8)
- ! Make sure that both ISOFIX connectors are securely attached to the vehicle's ISOFIX anchor bars. There should be two audible clicks and the colors of the indicators on both ISOFIX connectors should be completely green. (8)-1
  - ! Check to make sure the base is securely installed by pulling on both ISOFIX connectors.

- 5 - After placing the base on the vehicle seat, extend the load leg to floor (9). When the load leg is installed correctly, the load leg indicator will show green. Red will be shown when installed incorrectly. (9)-2

- ! The load leg has multiple positions. When the load leg indicator shows red this means the load leg is in the wrong position.
- ! Make sure the load leg is in full contact with the vehicle floor pan.
- ! Squeeze the load leg adjustment button, then shorten the load leg upwards. (9)-1

The completely assembled base is shown as (10).

- ! The ISOFIX connectors must be attached and locked onto the ISOFIX anchor bars. (10)-1
- ! The load leg must be installed correctly with green indicator. (10)-2

- 6 - To remove the base, press the secondary lock button (11)-1 first followed by the button (11)-2 on the ISOFIX connectors before removing the base from the vehicle seat. (11)
- 7 - For transporting, press ISOFIX Adjustment button and move the ISOFIX connectors back into the storage position. (12)

### Use Side Impact Protection

- 1 - The enhanced child restraint is delivered with removable side impact protection pod. This side impact protection pod **MUST** be used on the door side of the vehicle. Installation shown in (13).
- 2 - Press the release button to remove side impact protection pod. (14)

### Height Adjustment

#### for Head Support and Shoulder Harnesses

Please adjust the head support and check if the shoulder harnesses are at the correct height according to (15) - (18).

- ! When used in rearward facing mode, the shoulder harness height must be even with or just below the top of child's shoulders. (15)
- ! When used in forward facing mode, the shoulder harness height must be even with the top of child's shoulders. (16)

Pull the head support adjustment lever (17), meanwhile pull up or down the head support until it snaps into one of the 6 positions. The head support positions are shown as (18).

## EN Recline Adjustment

- 1 - Squeeze the recline adjustment button to adjust the enhanced child restraint to the proper position. (19)
- 2 - Both rear facing mode and forward facing mode have 5 recline positions, the recline angles are shown as. (20)

## Rearward Facing Mode

(Child height 40cm-105cm/ Child weight ≤18kg)

- ! Please install the enhanced child restraint on the rear vehicle seat, and then place the child in the enhanced child restraint.
- 1 - Push the enhanced child restraint down onto the base (21). If the enhanced child restraint is secure, the enhanced child restraint indicator will show green. (22)
  - 2 - To release the enhanced child restraint, first take the child out of the child restraint. Squeeze the child restraint release button (23)-1, then lift the child restraint up (23)-2.  
  
The enhanced child restraint can **ONLY** be installed and released when in rearward facing mode.
  - 3 - Press and hold the ISOFIX adjustment button and push the enhanced child restraint system back until it comes in contact with the vehicle seatback. (24)
  - 4 - Press and hold the rotation button to rotate for easier side loading/unloading of the child, then rotate the seat to the rear facing position. (25)  
  
! Press the rotation button on either side to rotate the enhanced child restraint.
  - 5 - Press the harness adjustment button while pulling the shoulder harnesses to the desired length (Pull from below the fixed shoulder pads to lengthen). (26)
  - 6 - Unlock the buckle of the harnesses by pressing the red button. (27)
  - 7 - Place the buckle tongues against the magnetic area on the outer side of the enhanced child restraint so that the tongues are held in place. (28)

## Use Infant Insert

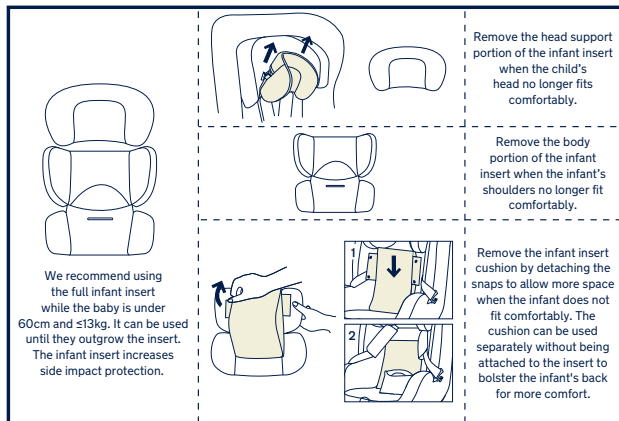

- 8 - Place the child into the enhanced child restraint and pass both arms through the harnesses.
- 9 - Engage the buckle. Please refer to (29).
- 10 - Rotate the enhanced child restraint to rearward facing. The enhanced child restraint indicator will show green. (30)
- 11 - Pull down the adjustment webbing and adjust it to the proper length to make sure your child is properly secured. (31)  
  
! Always keep child secured in harness and properly tightened by removing any slack.

## Forward Facing Mode

(Child height 76cm-105cm/ Child weight ≤18kg)

(Child's Age ≥2 Years)

- ! Please install the enhanced child restraint on the rear vehicle seat, and then place the child in the enhanced child restraint.
- 1 - Press the rotation button to rotate for easier side loading/unloading of the child, then rotate the seat to the forward facing position. **(32)**
- ! Press the rotation button on either side to rotate the enhanced child restraint.
- 2 - Press the harness adjustment button while pulling the shoulder harnesses to the desired length (Pull from below the fixed shoulder pads to lengthen). **(33)**
- 3 - Unlock the buckle of the harnesses by pressing the red button. **(34)**
  - ! Remove the infant insert when in forward facing mode.
- 4 - Place the buckle tongues against the magnetic area on the outer side of the enhanced child restraint so that the tongues are held in place. **(35)**
- 5 - Rotate the enhanced child restraint seat to forward facing, the enhanced child restraint indicator will show green. **(36)**
- 6 - Pull down the adjustment webbing and adjust it to the proper length to make sure your child is properly secured. **(37)**
  - ! Always keep child secured in harness and properly tightened by removing any slack.
  - ! DO NOT use forward facing unless your child is at least 76cm AND 2 years old.

## Detach & Assemble Soft Goods

Press the red button to disengage the buckle. **(38)**

Follow steps **(39)** - **(44)** to detach soft goods.

To re-attach the soft goods please repeat the above steps in reverse.

## Cleaning and Maintenance

Please store the infant insert somewhere out of the child's reach.

Please wash the soft goods with cold water under 30°C.

**DO NOT** iron the soft goods.

**DO NOT** bleach or dry clean the soft goods.

**DO NOT** use undiluted neutral detergent, gasoline or other organic solvent to wash the enhanced child restraint. It may cause damage to the enhanced child restraint.

**DO NOT** twist the soft goods to dry with great force. It may leave the soft goods with wrinkles.

Please hang dry the soft goods in the shade.

Please remove the enhanced child restraint from the vehicle seat if it will not be in use for a long period of time.

# Vehicle Fitting Information

This enhanced child restraint is approved to CNS 11497. It is suitable to fix into seat positions in most cars. The numbers on the diagram below correspond with the vehicle fitting positions listed in the following pages.

Seat positions in other cars may also be suitable to accept the base. If in doubt, consult either the enhanced child restraint manufacturer or the distributor.

**IMPORTANT - DO NOT USE FORWARD FACING BEFORE THE CHILD'S AGE EXCEEDS 2 YEARS** (Refer to instructions).

ALWAYS give priority to the rear seats of your vehicle.

Don't use it on front seat with active airbag when installed in rear facing mode.

Before you purchase the vehicle, check that it is equipped with the appropriate anchorages.

- Your child restraint can be fitted
- X Your child restraint can not be fitted

 i-Size vehicles

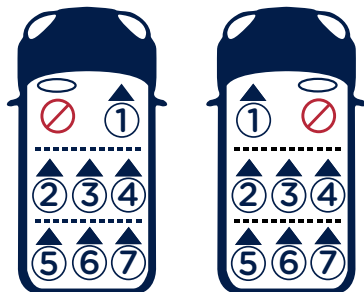

If your vehicle is not listed in this manual or it is not marked with either a "•" or "X" then please refer to your vehicle's handbook or contact the manufacturer for further information.

This fitting-list was carefully prepared using scientific data collected from both vehicle and car seat. No liability is accepted for the accuracy of the list, which is for guidance purposes only. You are advised to check that the seat you purchase is compatible with your car at the time of purchase.



NUNA International B.V. Nuna and all associated logos are trademarks.







## Alfa Romeo



4C Coupe (2014 >)	X	-	-	-	-	-	-
 Giulia (2017 >)	X	•	X	•	-	-	-
Giulietta (2010 >)	X	•	X	•	-	-	-
MiTo (2009 >)	X	•	-	-	-	-	-
 Stelvio (2017 >)	X	•	X	•	-	-	-

## Aston Martin

DB11 (2019 >)	X	X	-	X	-	-	-
DBS (2019 >)	X	X	-	X	-	-	-
Vantage (2019 >)	X	-	-	-	-	-	-

## Audi

A1 Sportback (2012 >)	X	•	X	•	-	-	-
A3 (1996 - 2003)	X	X	X	X	-	-	-
A3 2004 (2005 - 2011)	X	•	X	•	-	-	-
A3 Hatch (2012 >)	X	•	X	•	-	-	-
A3 S3 (2012 >)	X	•	X	•	-	-	-
A3 Saloon (2014 >)	X	•	X	•	-	-	-
A3 e-Tron Sportback (2015 >)	X	•	X	•	-	-	-
A4 2005 (2005 - 2008)	X	•	X	•	-	-	-
 A4 2015 (2015 >)	X	•	X	•	-	-	-
A4 Avant (2008 >)	X	•	X	•	-	-	-
A5 Sportback (2009 >)	X	•	X	•	-	-	-
 A5/S5 Cabriolet 2017 (2017 >)	X	X	-	X	-	-	-
A5/S5 Coupe 2016 (2016 >)	X	•	X	•	-	-	-
 A5/S5 Sportback 2017 (2017 >)	X	•	X	•	-	-	-
A6 Allroad (2011 >)	X	•	X	•	-	-	-
A6 Avant (2011 >)	X	•	X	•	-	-	-
A7 Sportback (2011 >)	X	•	X	•	-	-	-
A7/S7 Sportback (2016 >)	X	•	X	•	-	-	-
A7/S7 Sportback 2018 (2018 >)	X	•	X	•	-	-	-
A8 (2011 >)	X	•	X	•	-	-	-
A8 S8 (2011 >)	X	•	X	•	-	-	-
 A8/S8 2018 (2018 >)	X	•	X	•	-	-	-
 Q2 (2016 >)	X	•	X	•	-	-	-
 Q3 (2011 >)	X	•	X	•	-	-	-
 Q3 (2019 >)	X	•	X	•	-	-	-



	①	②	③	④	⑤	⑥	⑦
Q5 (2009 >)	X	.	X	.	-	-	-
Q5/SQ5 2017 (2017 >)	X	.	X	.	-	-	-
Q7 (2006 >)	X	X	X	X	-	-	-
 Q7 2015 (2015 >)	X	.	X	.	X	.	X
 Q8 (2018 >)	X	.	X	.	-	-	-
TT Coupe (2008 >)	X	X	-	X	-	-	-

	①	②	③	④	⑤	⑥	⑦
X5 2015 (2015 >)	X	.	X	.	X	.	X
X6 (2009 >)	X	.	X	.	-	-	-
X6 2015 (2015 >)	X	.	-	-	-	-	-
i8 (2014 >)	X	X	-	X	-	-	-
Bmw 3GT (2013 >)	X	.	X	.	-	-	-
Bmw i3 (2014 >)	X	.	-	-	-	-	-

## Bentley

Bentley Continental Flying Spur (2005 >)	X	.	X	.	-	-	-
Bentley Continental GT (2003 - 2012)	X	X	-	X	-	-	-
Bentley Continental GT Conv (2006 - 2012)	X	X	-	X	-	-	-
Bentley Mulsanne (2012 >)	X	.	X	.	-	-	-

## BMW

1 Series (f20) (2011 >)	X	.	X	.	-	-	-
1-Series 5dr (2004 - 2010)	X	.	X	.	-	-	-
1-Series Cabrio (2008 >)	X	X	-	X	-	-	-
1-Series Coupe (2008 >)	X	.	-	.	-	-	-
2-Series AC-T (2015 >)	X	.	X	.	-	-	-
2-Series Coupe (2014 >)	X	.	-	-	-	-	-
3 Series (f30) (2012 >)	X	.	X	.	-	-	-
3-Series (E46) Coupe (2002 - 2006)	X	X	X	X	-	-	-
3-Series Coupe (E90) (2007 >)	X	.	-	-	-	-	-
4-Series Gran Coupe (2014 >)	X	X	X	X	-	-	-
5-GT (2010 >)	X	.	X	.	-	-	-
5-Series (F10) (2011 >)	X	.	X	.	-	-	-
5-Series (E60) (2003 - 2010)	X	.	X	.	-	-	-
 5-Series 2018 (2018 >)	X	.	X	.	-	-	-
6-Series Cabrio (2011 >)	X	.	-	-	-	-	-
6-Series Coupe (2Dr) (2011 >)	X	.	-	-	-	-	-
6-Series Gran Coupe (4Dr) (2011 >)	X	X	X	X	-	-	-
7-Series (2010 >)	X	.	X	.	-	-	-
7-Series 2015 (2015 >)	X	.	X	.	-	-	-
X1 (2009 -2015)	X	.	X	.	-	-	-
 X1 2016 (2016 >)	X	.	X	.	-	-	-
X3 (F25) (2011 >)	X	.	X	.	-	-	-
 X3 2018 (2018 >)	X	.	X	.	-	-	-
X4 (2014 >)	X	.	X	.	-	-	-
X5 2000 (2000 - 2006)	X	X	X	X	-	-	-
X5 2007 (2007 - 2014)	X	X	X	X	X	.	X

## Cadillac

Cadillac BLS (2005 - 2012)	X	.	X	.	-	-	-
----------------------------	---	---	---	---	---	---	---



## Chevrolet



Chevrolet Aveo 5 door (2012 >)	X	.	X	.	-	-	-
Chevrolet Captiva (2010 >)	X	.	X	.	-	-	-
Chevrolet Cruze (2011 >)	X	.	X	.	-	-	-
Chevrolet Orlando (2011 >)	X	.	X	.	-	-	-
Chevrolet Spark 5Dr (2012 >)	X	X	X	X	-	-	-
Chevrolet Traxx (2013 >)	X	.	X	.	-	-	-
Chevrolet Volt (2011 >)	X	.	-	-	-	-	-

## Chrysler

300C (2012 >)	X	.	X	.	-	-	-
Delta (2007 >)	X	.	X	.	-	-	-
Grand Voyager (2008 >)	X	.	-	-	X	X	X
Ypsilon (2012 >)	X	.	X	.	-	-	-

## Citroen

Berlingo II (2008 >)	X	.	X	.	-	-	-
Berlingo Multispace (2007 >)	X	X	X	X	X	.	X
 C-Cactus (2015)	X	.	X	.	-	-	-
C1 (2006 >)	X	X	-	X	-	-	-
C1 2015 (2015 >)	X	X	-	X	-	-	-
C3 5Dr (2009 >)	X	.	X	.	-	-	-
C3 5Dr 2005 (2005 - 2009)	X	.	X	.	-	-	-
 C3 5Dr 2016 (2016 >)	X	.	X	.	-	-	-
 C3 Aircross (2017 >)	X	.	X	.	-	-	-
C3 Picasso (2009 >)	X	.	X	.	-	-	-
C4 G-Picasso (2014 >)	X	X	X	X	X	.	X
C4 G-Picasso 2007 (2007 - 2013)	X	X	.	X	X	.	X

	①	②	③	④	⑤	⑥	⑦
C4 Picasso (2007 - 2013)	X	X	X	X	-	-	-
C5 (2008 >)	X	.	X	.	-	-	-
C5 2005 (2005 - 2008)	X	.	X	.	-	-	-
 C5 Aircross (2019 >)	X	X	X	X	-	-	-
C5 Tourer (2009 >)	X	.	X	.	-	-	-
DS3 (2011 >)	X	X	.	-	-	-	-
DS3 Cabrio (2013 >)	X	.	X	.	-	-	-
 DS3 Crossback (2019 >)	X	.	X	.	-	-	-
DS4 (2011 >)	X	.	X	.	-	-	-
DS5 (2013 >)	X	.	X	.	-	-	-
 DS7 (2018 >)	X	.	X	.	-	-	-
Jumpy (2007 - 2016)	X	.	X	.	X	-	X
Nemo (2008 >)	X	.	X	.	-	-	-
Xsara 5Dr (2000 - 2004)	X	X	X	X	-	-	-
Xsara Picasso (2000 - 2012)	X	X	X	X	-	-	-

## Dacia









Duster (2012 >)	X	.	X	.	-	-	-
Logan MCV (2013 >)	X	X	X	X	-	-	-
Logan MCV 2006 (2008/11-2013/7)	X	X	X	X	-	-	-
Sandero (2013 >)	X	X	X	X	-	-	-

## Fiat





124 Spider 2016 (2016 >)	X	-	-	-	-	-	-
500 (2008 >)	X	X	-	X	-	-	-
500L (2013 >)	X	.	X	.	-	-	-
 500X (2015 >)	X	.	X	.	-	-	-
Bravo (2007 >)	X	.	X	.	-	-	-
Doblo (2007 >)	X	.	X	.	-	-	-
Panda (2012 >)	X	X	X	X	-	-	-
Punto 3 Door (Grande Punto) (2006 >)	X	X	X	X	-	-	-
Qubo (2008 >)	X	.	X	.	-	-	-
 Tipo 2016 (2016 >)	X	.	X	.	-	-	-

## Ford

 Galaxy 2016 (2016 >)	X	X	X	X	X	-	X
B-Max (2012 >)	X	.	X	.	-	-	-
C-Max (2003 - 2013)	X	X	X	X	-	-	-
C-Max 2013 (2011 >)	X	X	X	X	-	-	-





	①	②	③	④	⑤	⑥	⑦
 EcoSport (2015 >)	X	.	X	.	-	-	-
Edge (2016 >)	X	.	X	.	X	-	X
Fiesta 2004 3Dr (2004 - 2008)	X	X	X	X	-	-	-
Fiesta 2008 (2008 >)	X	.	X	.	-	-	-
 Fiesta 2017 > (2017 >)	X	.	X	.	-	-	-
Focus (2010 >)	X	.	X	.	-	-	-
Focus 2005 (2005 - 2009)	X	X	X	X	-	-	-
 Focus 2018 (2018 >)	X	.	X	.	-	-	-
Focus EV (2015 >)	X	.	X	.	-	-	-
Focus Mk1 (1998 - 2004)	X	X	X	X	-	-	-
Galaxy (2006 >)	X	X	X	X	-	-	X
Ka (2009 - 2013)	X	X	-	X	-	-	-
 Ka+ 2016 (2016 >)	X	.	X	.	-	-	-
Kuga 2008 (2008 - 2012)	X	.	X	.	-	-	-
Kuga 2013 (2013 >)	X	.	X	.	-	-	-
 Kuga 2017 (2017 >)	X	.	X	.	-	-	-
 Kuga 2020 (2020 >)	X	.	X	.	-	-	-
Mondeo 2000 (2000 - 2007)	X	X	X	X	-	-	-
Mondeo Estate (2007 >)	X	.	X	.	-	-	-
Mustang Cabrio 2015 (2015 >)	X	X	-	X	-	-	-
Mustang Coupe 2015 (2015 >)	X	X	-	X	-	-	-
 New Mondeo 2014 (2014 >)	X	.	X	.	-	-	-
 Puma (2020 >)	X	.	X	.	-	-	-
Ranger Double-Cab Pickup (2019 >)	X	.	X	.	-	-	-
S-Max (2006 >)	X	X	X	X	X	-	X
 S-Max 2015 (2015 >)	X	X	X	X	X	-	X

## Honda

Accord Saloon (2008 >)	X	.	X	.	-	-	-
CR-V (2007 - 2012)	X	.	X	.	-	-	-
CR-V 2012 (2012 >)	X	.	X	.	-	-	-
 CR-V 2019 (2019 >)	X	.	X	.	X	-	X
Civic (2012 >)	X	.	X	.	-	-	-
Civic (2006 - 2011)	X	.	X	.	-	-	-
 Civic 2017 (2017 >)	X	.	X	.	-	-	-
 Civic Saloon 2019 (2019 >)	X	.	X	.	-	-	-
Civic Tourer (2014 >)	X	.	X	.	-	-	-
Elysion (2012 >)	X	.	-	-	X	X	X
FRV (2006 - 2011)	X	X	X	X	-	-	-
 HR-V (2015 >)	X	.	X	.	-	-	-
Insight (2009 >)	X	X	X	X	-	-	-

	①	②	③	④	⑤	⑥	⑦
Jazz (2008 - 2015)	X	.	X	.	-	-	-
Jazz 2002 (2002 - 2008)	X	X	X	X	-	-	-
 Jazz 2016 (2016 >)	X	.	X	.	-	-	-
 Jazz 2020 (2020 >)	X	.	X	.	-	-	-
Odyssey (2010 >)	X	X	-	X	-	-	-



## Hyundai





Genesis Sedan (2016 >)	X	.	X	.	-	-	-
Getz (2005 - 2011)	X	.	X	.	-	-	-
 Ioniq Hybrid (2016 >)	X	.	X	.	-	-	-
Ix20 (2011 >)	X	.	X	.	-	-	-
 Kona 2017 > (2017 >)	X	.	X	.	-	-	-
Santa Fe (2012 >)	X	.	X	.	X	-	X
Santa Fe 2007 (2007 - 2012)	X	.	X	.	X	-	X
 Tucson 2015 (2015 >)	X	.	X	.	-	-	-
Veloster (2012 >)	X	.	-	-	-	-	-
i10 (2008 >)	X	X	X	X	-	-	-
 i10 2014 (2014 >)	X	X	X	X	-	-	-
i20 2014 > (2014 >)	X	.	X	.	-	-	-
i20 2015 (2015 >)	X	.	X	.	-	-	-
i20 Hatch (2009 >)	X	.	X	.	-	-	-
i30 Hatch (2012 >)	X	.	X	.	-	-	-
i30 Hatch 2015 (2015 - 2017)	X	.	X	.	-	-	-
 i30 Hatch 2017 (2017 >)	X	.	X	.	-	-	-
i40 (2011 >)	X	.	X	.	-	-	-
i800/H1 (2008 >)	X	.	X	.	X	X	X
ix35 (2010 >)	X	.	X	.	-	-	-

## Infiniti

EX SUV (2009 >)	X	.	X	.	-	-	-
FX SUV (2009 >)	X	.	X	.	-	-	-
G Coupe (2009 >)	X	X	-	X	-	-	-
G Saloon (2009 >)	X	.	X	.	-	-	-
M Saloon (2010 >)	X	.	X	.	-	-	-

## Jaguar







 E-Pace (2018 >)	X	.	X	.	-	-	-
 F-Pace (2016 >)	X	.	X	.	-	-	-
F-Type Coupe (2014 >)	X	-	-	-	-	-	-

	①	②	③	④	⑤	⑥	⑦
 I-Pace (2018 >)	X	.	X	.	-	-	-
X-Type (2001 - 2010)	X	X	X	X	-	-	-
 XE (2015 >)	X	.	X	.	-	-	-
XF (2008 >)	X	.	X	.	-	-	-
 XF 2015 (2015 >)	X	.	X	.	-	-	-
 XF Estate 2015 (2015 >)	X	.	X	.	-	-	-
XF Sportbrake (2012 >)	X	.	X	.	-	-	-
XJ (2010 >)	X	.	X	.	-	-	-
XK Coupe (2006 >)	X	X	-	X	-	-	-

## Jeep

Cherokee 2014 (2014 >)	X	.	X	.	-	-	-
Compass (2011 >)	X	.	X	.	-	-	-
Grand Cherokee (2011 >)	X	.	X	.	-	-	-
 Renegade 2015 (2015 >)	X	.	X	.	-	-	-
Wrangler 5Dr (2007 >)	X	X	X	X	-	-	-

## Kia





Sorento 2015 (2015 >)	X	.	X	.	X	-	X
Soul EV (2015 >)	X	.	X	.	-	-	-
Carens 2013 (2013 >)	X	X	X	X	X	-	X
Cee'D Hatch (2012 >)	X	.	X	.	-	-	-
Cee'D Hatch (2012 >)	X	.	X	.	-	-	-
 Niro 2017 > (2017 >)	X	.	X	.	-	-	-
Optima (2011 >)	X	.	X	.	-	-	-
 Optima 2016 (2016 >)	X	.	X	.	-	-	-
Picanto (2008 >)	X	X	X	X	-	-	-
Picanto 2012 (2011 - 2015)	X	.	X	.	-	-	-
 Picanto 2017 > (2017 >)	X	.	X	.	-	-	-
Rio (2012 >)	X	.	X	.	-	-	-
 Rio 2017 > (2017 >)	X	.	X	.	-	-	-
Sorento (2012 >)	X	.	X	.	-	-	-
Sorento (2003 - 2009)	X	.	X	.	-	-	-
Soul (2009 >)	X	.	X	.	-	-	-
Sportage (2011 >)	X	.	X	.	-	-	-
 Sportage 2016 (2016 >)	X	.	X	.	-	-	-
 Stonic 2017 > (2017 >)	X	.	X	.	-	-	-
Venga (2011 >)	X	.	X	.	-	-	-

① ② ③ ④ ⑤ ⑥ ⑦





## Lancia

Thema (2012 >)	X	.	X	.	.	.	.
Voyager (2010 >)	X	.	.	.	X	X	X
Ypsilon (2012 >)	X	.	X	.	.	.	.

## Land Rover

 Defender 2020 (2020 >)	X	.	X	.	X	.	X
Discovery 4 (2009 >)	X	X	X	X	.	.	.
 Discovery 5 2017 (2017 >)	X	.	X	.	X	.	X
Discovery Sport (2015 >)	X	.	X	.	X	.	X
Freelander 2 (2006 >)	X	.	X	.	.	.	.
Range Rover (2002 - 2012)	X	.	X	.	.	.	.
Range Rover 2013 (2013 >)	X	.	X	.	.	.	.
Range Rover Evoque (2011 >)	X	.	X	.	.	.	.
 Range Rover Evoque (5dr) 2019 (2019 >)	X	.	X	.	.	.	.
Range Rover Evoque 5 door (2011 >)	X	.	X	.	.	.	.
Range Rover Sport (2005 - 2012)	X	.	X	.	.	.	.
Range Rover Sport (2013 >)	X	.	X	.	.	.	.
 Range Rover VELAR (2017 >)	X	.	X	.	.	.	.

## Lexus



CT (2011 >)	X	.	X	.	.	.	.
 ES Hybrid (2019 >)	X	.	X	.	.	.	.
GS (2013 >)	X	.	X	.	.	.	.
IS (2005 >)	X	.	X	.	.	.	.
IS 200 (2004) (1999 >)	X	.	X	.	.	.	.
 NX (2014 >)	X	.	X	.	.	.	.
RX (2010 >)	X	.	X	.	.	.	.
 RX 2016 (2017 >)	X	.	X	.	.	.	.
 UX (2019 >)	X	.	X	.	.	.	.

## Maserati









Maserati Ghibli 2014 (2014 >)	X	.	X	.	.	.	.
Gran Turismo 2007 (2007 >)	X	X	.	X	.	.	.
Levante (2017 >)	X	.	X	.	.	.	.
Quattroporte 2016 (2016 >)	X	.	X	.	.	.	.

① ② ③ ④ ⑤ ⑥ ⑦

## Mazda

2 (2007 >)	X	.	X	.	.	.	.
 2 2015 (2015 >)	X	.	X	.	.	.	.
3 Hatch (2009 - 2013)	X	.	X	.	.	.	.
3 Hatchback 2014 (2014 >)	X	.	X	.	.	.	.
5 ( 2005 - 2010)	X	.	X	.	.	.	.
6 (2007 - 2012)	X	.	X	.	.	.	.
 6 2018 (2018 >)	X	.	X	.	.	.	.
6 Estate (2013 >)	X	.	X	.	.	.	.
6 Saloon (2013 >)	X	.	X	.	.	.	.
 CX-3 (2015 >)	X	.	X	.	.	.	.
CX-5 (2011 >)	X	.	X	.	.	.	.
CX-7 (2007 >)	X	.	X	.	.	.	.
MX-5 2015 (2016 >)	X	.	.	.	.	.	.

## Mercedes-Benz

A Class (2005 - 2012)	X	.	X	.	.	.	.
A-Class (2013 >)	X	.	X	.	.	.	.
 A-Class Hatchback 2019 (2019 >)	X	.	X	.	.	.	.
 A-Class Saloon 2019 (2020 >)	X	.	X	.	.	.	.
B-Class (2012 >)	X	X	X	X	.	.	.
B-Class EV (2015 >)	X	X	X	X	.	.	.
C-Class 2015 Estate (2015 >)	X	X	X	X	.	.	.
C-Class Coupe (2011 >)	X	.	.	.	.	.	.
C-Class Estate (2008 >)	X	.	X	.	.	.	.
CLA (2013 >)	X	.	X	.	.	.	.
 CLA 2019 (2020 >)	X	.	X	.	.	.	.
 CLA Shooting-Brake (2015 >)	X	.	X	.	.	.	.
CLS Coupe (2011 >)	X	.	X	.	.	.	.
CLS Shooting Brake (2012 >)	X	.	X	.	.	.	.
E-Class 2006 (2006 - 2009)	X	.	X	.	.	.	.
E-Class Cabriolet 2017 (2017 >)	X	.	.	.	.	.	.
E-Class Coupe (2009 >)	X	X	.	X	.	.	.
 E-Class Coupe 2017 (2017 >)	X	.	.	.	.	.	.
E-Class Estate (2013 >)	X	.	X	.	.	.	.
 E-Class Estate 2016 (2016 >)	X	.	X	.	.	.	.
E-Class Saloon 2013 (2013 >)	X	.	X	.	.	.	.
GL Class (2012 >)	X	.	X	.	X	.	X
 GLC (2016 >)	X	.	X	.	.	.	.
 GLC Coupe (2019 >)	X	.	X	.	.	.	.





	①	②	③	④	⑤	⑥	⑦
GLE (2015 >)	X	.	X	.	-	-	-
ML-Class (2005 - 2012)	X	.	X	.	-	-	-
R-Class (2006 - 2012)	X	X	X	X	-	-	-
S Class 2015 (2014 >)	X	.	X	.	-	-	-
S-Class (2006 - 2013)	X	.	X	.	-	-	-
SL-Class (2012 >)	X	-	-	-	-	-	-
SLK (2012 >)	X	-	-	-	-	-	-
V-Class (2015 >)	X	.	X	.	X	X	X

## MG

 GS (2016 >)	X	.	X	.	-	-	-
Motor MG6 (2012 >)	X	.	X	.	-	-	-

## Mini

Countryman (2010 >)	X	.	X	.	-	-	-
Coupe (2009 >)	X	-	-	-	-	-	-
Hatch (2006 >)	X	X	-	X	-	-	-
Hatchback 3Dr 2014 (2014 >)	X	X	-	X	-	-	-
Hatchback 3dr (2000 - 2006)	X	X	-	X	-	-	-
Hatchback 5dr 2015 (2015 >)	X	.	X	.	-	-	-
Paceman (2013 >)	X	X	-	X	-	-	-
 Clubman 2016 (2016 >)	X	.	X	.	-	-	-
 Countryman 2017 (2017 >)	X	.	X	.	-	-	-

## Mitsubishi

ASX (2010 >)	X	.	X	.	-	-	-
Colt (2007 - 2013)	X	.	X	.	-	-	-
 Eclipse Cross (2019 >)	X	.	X	.	-	-	-
Lancer (2008 - 2011 >)	X	-	-	-	-	-	-
Lancer Sportback (2008 - 2011 >)	X	-	-	-	-	-	-
Mirage (2012 >)	X	X	X	X	-	-	-
Outlander (2007 - 2013)	X	.	X	.	-	-	-
Outlander (2013 >)	X	.	X	.	-	-	-
Outlander PHEV (2015 >)	X	.	X	.	-	-	-
Shogun (2007 >)	X	.	X	.	-	-	-

## Nissan

2008 X-Trail (2008 >)	X	.	X	.	-	-	-
-----------------------	---	---	---	---	---	---	---







	①	②	③	④	⑤	⑥	⑦
Juke (2010 >)	X	.	X	.	-	-	-
Leaf EV (2010 - 2017)	X	.	X	.	-	-	-
Micra (2011 >)	X	.	X	.	-	-	-
Micra 2017 > (2017 >)	X	.	X	.	-	-	-
Murano 2016 (2016 >)	X	.	X	.	-	-	-
Navara 2015 > (2015 >)	X	.	X	.	-	-	-
Note (2006 - 2013)	X	.	X	.	-	-	-
Note 2014 (2014 >)	X	.	X	.	-	-	-
Pulsar 2015 (2015 >)	X	.	X	.	-	-	-
Qashqai 2007 (2006 -2013)	X	.	X	.	-	-	-
Qashqai 2014 (2014 >)	X	.	X	.	-	-	-
Qashqai+2 (2008 >)	X	.	X	.	-	-	-
Quest MPV (2012 >)	X	.	-	-	X	X	X
X-Trail 2015 (2015 >)	X	.	X	.	X	-	X

## Opel

Adam (2013 >)	X	X	-	X	-	-	-
Agila (2008 >)	X	.	X	.	-	-	-
Ampera (2011 >)	X	.	-	.	-	-	-
Antara (2007 >)	X	.	X	.	-	-	-
Astra 2003 5dr (2003 - 2009)	X	.	X	.	-	-	-
Astra 2010 5 door (2010 >)	X	X	X	X	-	-	-
 Astra 2015 (2015 >)	X	.	X	.	-	-	-
Astra GTC (2011 >)	X	.	X	.	-	-	-
Corsa 5dr 2015 (2015 >)	X	.	X	.	-	-	-
Corsa Hatch 5 door (2006 >)	X	.	X	.	-	-	-
Insignia Hatch (2009 >)	X	.	X	.	-	-	-
Karl (2015 >)	X	.	X	.	-	-	-
Meriva (2010 >)	X	X	X	X	-	-	-
Mokka (2013 >)	X	.	X	.	-	-	-
Vectra 2005 (2002 - 2008)	X	.	X	.	-	-	-
Zafira (2005 >)	X	.	X	.	-	-	-
Zafira Tourer (2012 >)	X	X	X	X	X	-	X

## Peugeot

107 (2005 - 2013)	X	.	-	.	-	-	-
108 (2015 >)	X	.	-	.	-	-	-
2008 (2013 >)	X	.	X	.	-	-	-
 2008 2020 (2020 >)	X	.	X	.	-	-	-
206 3Dr (1998 - 2009)	X	.	X	.	-	-	-



	①	②	③	④	⑤	⑥	⑦
207 3 Door Hatchback (2006 - 2012)	X	.	X	.	-	-	-
207 5 Door (2012 >)	X	.	X	.	-	-	-
 208 2020 5dr (2020 >)	X	.	X	.	-	-	-
208 5DR (2012 >)	X	.	X	.	-	-	-
 208 EV 2020 5dr (2020 >)	X	.	X	.	-	-	-
3008 (2009 >)	X	.	X	.	-	-	-
 3008 2017 (2017 >)	X	.	X	.	-	-	-
307 Hatchback (2001 - 2007)	X	.	X	.	-	-	-
308 (2014) (2014 >)	X	.	X	.	-	-	-
308 Hatchback (2007 >)	X	.	X	.	-	-	-
407 (2004 - 2011)	X	.	X	.	-	-	-
5008 (2011 >)	X	X	.	X	X	-	X
 5008 (2018 >)	X	X	.	X	X	-	X
508 (2011 >)	X	.	X	.	-	-	-
 508 2019 (2018 >)	X	.	X	.	-	-	-
 508 Estate PHEV 2019 (2019 >)	X	.	X	.	-	-	-
Bipper Teepee (2008 >)	X	.	X	.	-	-	-
Expert Teepee (2008 >)	X	.	X	.	X	-	X
Partner Combi (2004 - 2010)	X	X	X	X	-	-	-
Partner Teepee (2008 >)	X	.	X	.	-	-	-
RCZ (2011 >)	X	X	-	X	-	-	-
Traveller 2016 (2016 >)	X	.	.	.	.	.	.

## Porsche

Cayenne (2011 >)	X	.	X	.	-	-	-
 Cayenne 2017 (2017 >)	X	.	X	.	-	-	-
Cayenne E-Hybrid (2015 >)	X	.	X	.	-	-	-
Macan (2014 >)	X	.	X	.	-	-	-
Panamera (2011 >)	X	.	.	.	-	-	-
Panamera E-Hybrid (2015 >)	X	.	.	.	-	-	-

## Renault

Captur (2015 >)	X	X	X	X	-	-	-
Clio (2005 - 2013)	X	.	X	.	-	-	-
Espace (2003 - 2012)	X	X	.	X	X	-	X
Grand Espace (2003 - 2012)	X	X	.	X	X	-	X
Kadjar (2015 >)	X	.	X	.	-	-	-
Laguna Sport Tourer (2008 - 2012)	X	.	X	.	-	-	-
Megane Hatch (2008 >)	X	.	X	.	-	-	-
Megane Hatch (2002 - 2009)	X	.	X	.	-	-	-

	①	②	③	④	⑤	⑥	⑦
 Megane Hatch 2016 (2016 >)	X	.	.	.	-	-	-
Modus (2004 - 2012)	X	.	.	.	-	-	-
New Clio (2013 >)	X	.	.	.	-	-	-
Scenic (2009 >)	X	X	X	X	-	-	-
Scenic 2003 (2003 - 2009)	X	X	X	X	-	-	-
 Scenic 2017 (2017 >)	X	X	X	X	-	-	-
Twingo (2007 >)	X	X	-	X	-	-	-
Twingo 2015 (2015 >)	X	.	.	.	-	-	-



## Rover

25 / Streetwise (1999 - 2005)	X	X	-	X	-	-	-
-------------------------------	---	---	---	---	---	---	---

## SAAB









93 Sport Wagon (2005 - 2012)	X	.	X	.	-	-	-
New 95 (2011 - 2012)	X	.	X	.	-	-	-







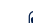

## SEAT





Alhambra (2010 >)	X	.	.	.	.	X	-	X
Altea (2004 - 2012)	X	.	X	.	-	-	-	-
Arosa (1997 - 2004)	X	X	-	X	-	-	-	-
 Ateca 2018 (2018 >)	X	X	X	X	-	-	-	-
Exeo ST (2008 >)	X	.	X	.	-	-	-	-
 Ibiza 2018 (2018 >)	X	.	X	.	-	-	-	-
Ibiza HATCH 5 door (2008 - 2013)	X	.	X	.	-	-	-	-
Leon FR (2006 - 2012)	X	.	X	.	-	-	-	-
Leon (2000 - 2005)	X	X	X	X	-	-	-	-
New Toledo (2013 >)	X	.	X	.	-	-	-	-
mii (2011 >)	X	X	X	X	-	-	-	-
Leon 2013 (2013 >)	X	.	X	.	-	-	-	-

## Skoda







Citigo (2011 >)	X	X	X	X	-	-	-
Citigo 5dr (2012 >)	X	X	-	X	-	-	-
Fabia 2015 (2015 >)	X	.	X	.	-	-	-
Fabia Hatch (2007 >)	X	X	X	X	-	-	-
 Karoq 2017 > (2017 >)	X	X	X	X	-	-	-
 Kodiaq 2017 > (2017 >)	X	.	X	.	X	-	X
Octavia (2004 - 2012)	X	.	X	.	-	-	-

	①	②	③	④	⑤	⑥	⑦
Octavia Hatch 2013 (2013 >)	X	.	X	.	-	-	-
Rapid (2013 >)	X	.	X	.	-	-	-
 Roomster (2006 >)	X	X	X	X	-	-	-
 Superb 2015 (2015 >)	X	.	X	.	-	-	-
Superb Combi/Estate (2008 >)	X	.	X	.	-	-	-
Yeti (2009 >)	X	X	X	X	-	-	-
<b>Smart</b>							
For Two Coupe (2007 - 2011)	X	-	-	-	-	-	-
FourFour 2015 (2015 >)	X	X	-	X	-	-	-
<b>Ssangyong</b>							
Actyon (2006 - 2011)	X	.	X	.	-	-	-
Korando (2011 >)	X	.	X	.	-	-	-
Musso Pickup 2016 (2016 >)	X	.	-	.	-	-	-
Rexton (2014 - 2016)	X	.	X	.	-	-	-
Tivoli (2015 >)	X	.	X	.	-	-	-
Turismo (2014 >)	X	.	-	.	X	X	X
<b>Subaru</b>							
BRZ (2012 >)	X	X	-	X	-	-	-
Forester (2013 >)	X	.	X	.	-	-	-
Impreza 5dr (2007>)	X	.	X	.	-	-	-
Impreza Hatchback 2013 (2013 >)	X	.	X	.	-	-	-
Legacy (2012 >)	X	.	X	.	-	-	-
 Levorg 2014 (2014 >)	X	.	X	.	-	-	-
Outback (2012 >)	X	.	X	.	-	-	-
XV Hatchback (2011 >)	X	.	X	.	-	-	-
<b>Suzuki</b>							
 Alto (2009 >)	X	X	-	X	-	-	-
 Baleno 2016 (2016 >)	X	.	X	.	-	-	-
 Celerio 2016 (2015 >)	X	X	X	X	-	-	-
Grand Vitara (2005 >)	X	.	X	.	-	-	-
 Ignis 2016 (2016 >)	X	.	-	.	-	-	-
SX-4 5dr (2006 >)	X	.	X	.	-	-	-
Splash (2008 >)	X	X	X	X	-	-	-
 Swift 2017 (2017 >)	X	.	X	.	-	-	-
Swift Sport 5dr (2011 >)	X	.	X	.	-	-	-

	①	②	③	④	⑤	⑥	⑦
Vitara 2015 (2015 >)	X	.	X	.	-	-	-
<b>Tesla</b>							
Model S (2012 >)	X	.	X	.	-	-	-
Model X (2015 >)	X	.	-	.	X	-	X
<b>Toyota</b>							
2013 Verso (2013 >)	X	X	X	X	-	-	-
Auris (2007 - 2013)	X	.	X	.	-	-	-
Auris (2013 >)	X	.	X	.	-	-	-
Avensis Hatch (2003 - 2011)	X	.	X	.	-	-	-
 Aygo 2014 (2014 >)	X	X	-	X	-	-	-
 Aygo 2019 (2019 >)	X	X	-	X	-	-	-
Aygo 3 Door (2005 >)	X	X	-	X	-	-	-
 C-HR (2017 >)	X	.	X	.	-	-	-
 Corolla 2018 (2018 >)	X	.	X	.	-	-	-
EZ Mpv (2013 >)	X	X	X	X	-	-	-
GT86 (2012 >)	X	X	-	X	-	-	-
Highlander (2013 >)	X	.	X	.	-	-	-
Land Cruiser (2003 - 2009)	X	.	X	.	-	-	-
Landcruiser (2009 >)	X	.	X	.	-	-	-
Prius 2 (2004 - 2009)	X	.	X	.	-	-	-
Prius 3 (2010 >)	X	.	X	.	-	-	-
 Prius 4 (2016) (2015 >)	X	.	X	.	-	-	-
Prius PHEV 3 (2015>)	X	.	X	.	-	-	-
Prius Plus+ (2012 >)	X	X	X	X	-	-	-
RAV 4 (2006 - 2012)	X	.	X	.	-	-	-
RAV4 (2013 >)	X	.	X	.	-	-	-
 RAV4 2019 (2019 >)	X	.	X	.	-	-	-
 RAV4 Hybrid (2015 >)	X	.	X	.	-	-	-
RAV4 Hybrid (2015 >)	X	.	X	.	-	-	-
Verso (2009 - 2012)	X	X	X	X	-	-	-
Yaris 2017 > (2017 >)	X	.	X	.	-	-	-
 Yaris 2019 (2019 >)	X	.	X	.	-	-	-
Yaris Hatch (2011 >)	X	.	X	.	-	-	-
Yaris Hatch (2006 - 2011)	X	.	X	.	-	-	-
<b>Vauxhall</b>							
Adam (2013 >)	X	X	-	X	-	-	-











	①	②	③	④	⑤	⑥	⑦
Agila (2008 >)	X	.	X	.	-	-	-
Ampera (2011 >)	X	.	-	.	-	-	-
Antara (2007 >)	X	.	X	.	-	-	-
Astra 2010 5 door (2010 >)	X	X	X	X	-	-	-
 Astra 2015 (2015 >)	X	.	X	.	-	-	-
Astra GTC (2011 >)	X	.	X	.	-	-	-
Astra Saloon (1998 - 2004)	X	X	X	X	-	-	-
Corsa 5dr 2015 (2015 >)	X	.	X	.	-	-	-
Corsa Hatch 5 door (2006 >)	X	.	X	.	-	-	-
Insignia Hatch (2009 >)	X	.	X	.	-	-	-
Meriva (2010 >)	X	X	X	X	-	-	-
Mokka (2013 >)	X	.	X	.	-	-	-
Vectra 2005 (2005 - 2008)	X	.	X	.	-	-	-
Viva (2015 >)	X	X	X	X	-	-	-
Zafira (2005 >)	X	.	X	.	-	-	-
 Zafira Tourer (2012 >)	X	X	X	X	X	-	X
 Opel Crossland X (2018 >)	X	.	X	.	-	-	-
 Opel Grandland X (2019 >)	X	.	X	.	-	-	-
 Opel Insignia 2018 (2018 >)	X	.	X	.	-	-	-

### Volvo

C30 (2007 - 2013)	X	X	-	X	-	-	-
S40 (2004 - 2012)	X	.	X	.	-	-	-
 S90 2016 (2016 >)	X	.	X	.	-	-	-
V40 (2013 >)	X	.	X	.	-	-	-
V40 Cross County (2013 >)	X	.	X	.	-	-	-
V50 (2004 - 2012)	X	.	X	.	-	-	-
V60 (2011 >)	X	.	X	.	-	-	-
V60 Plug-In (2015 >)	X	.	X	.	-	-	-
 V60 (2018 >)	X	.	X	.	-	-	-
 V90 2016 (2016 >)	X	.	X	.	-	-	-
 XC40 (2018 >)	X	.	X	.	-	-	-
XC60 (2013 >)	X	.	X	.	-	-	-
 XC60 2017 (2017 >)	X	.	X	.	-	-	-
XC70 (2008 >)	X	.	X	.	-	-	-
XC90 (2003 - 2015)	X	X	X	X	-	-	-
 XC90 2016 (2016 >)	X	.	X	.	X	-	X

### VW

 Arteon 2017 > (2017 >)	X	X	X	X	-	-	-
--	---	---	---	---	---	---	---

	①	②	③	④	⑤	⑥	⑦
Beetle (2012 >)	X	.	-	.	-	-	-
Beetle 1999 (1999 - 2005)	X	X	-	X	-	-	-
Caddy Maxilife (2010 >)	X	.	X	.	X	-	X
E-Golf Hatch Mk7 (2015 >)	X	.	X	.	-	-	-
E-UP! (2015 >)	X	.	X	.	-	-	-
Golf Cabriolet (2009 >)	X	X	-	X	-	-	-
Golf GTE Hatch Mk7 (2015 >)	X	.	X	.	-	-	-
Golf Hatch (2009 - 2013)	X	.	X	.	-	-	-
Golf Hatch Mk5 (2004 - 2008)	X	.	X	.	-	-	-
Golf Hatch Mk7 (2012 >)	X	.	X	.	-	-	-
Golf Plus (2009 - 2013)	X	.	X	.	-	-	-
Jetta (2011 >)	X	.	X	.	-	-	-
Lupo (1999 - 2005)	X	X	-	X	-	-	-
Multivan Caravelle (2008 >)	X	.	-	.	.	.	X
Passat CC (2008 >)	X	.	X	.	-	-	-
Passat Estate (2005 - 2011)	X	.	X	.	-	-	-
Passat Estate (2011-2015)	X	.	X	.	-	-	-
 Passat Estate 2015 (2015 >)	X	.	X	.	-	-	-
Passat Saloon (2005 - 2011)	X	.	X	.	-	-	-
Passat Saloon (2011-2015)	X	.	X	.	-	-	-
 Passat Saloon 2015 (2015 >)	X	.	X	.	-	-	-
 Polo 2017 (2017 >)	X	.	X	.	-	-	-
Polo 3 Door (2009 >)	X	.	X	.	-	-	-
Polo 5 Door (2009 >)	X	.	X	.	-	-	-
Scirocco (2011 >)	X	.	-	-	-	-	-
Sharan (2010 >)	X	.	.	.	X	-	X
 T-Cross (2019 >)	X	.	X	.	-	-	-
 T-Roc (2017 >)	X	.	X	.	-	-	-
Tiguan (2008 >)	X	.	X	.	-	-	-
 Tiguan 2016 (2016 >)	X	.	X	.	-	-	-
 Tiguan Allspace 2017 > (2017 >)	X	.	X	.	X	-	X
Touareg (2012 >)	X	.	X	.	-	-	-
 Touareg (2003 - 2010)	X	X	X	X	-	-	-
 Touareg 2018 (2018 >)	X	.	X	.	-	-	-
Touran (2010 >)	X	X	X	X	X	-	X
 Touran 2016 (2016 >)	X	.	.	.	.	X	-
UP! (2015 >)	X	.	X	.	-	-	-