

*Designed*  
**around your life**

**nuna®**

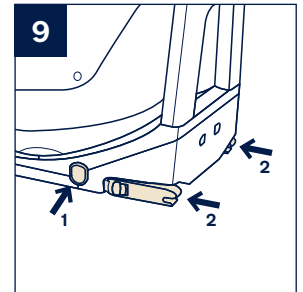

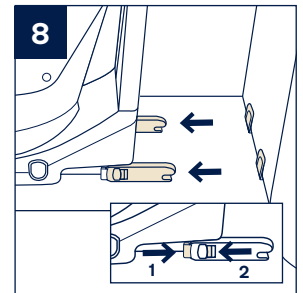

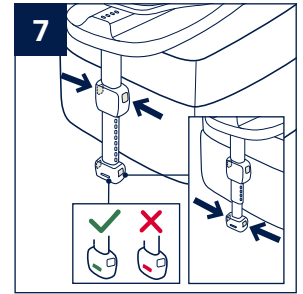
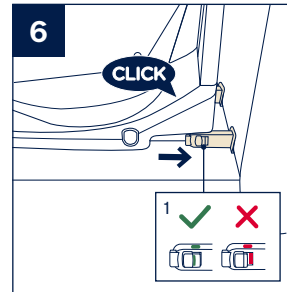
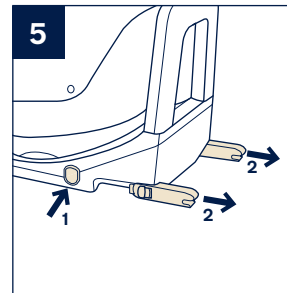
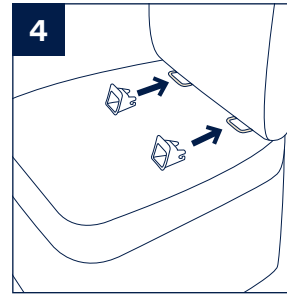
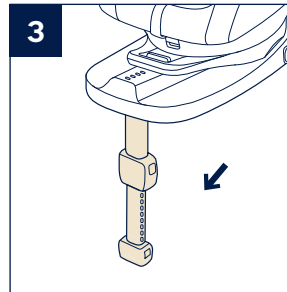
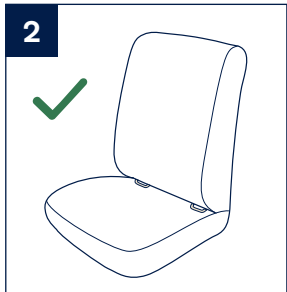
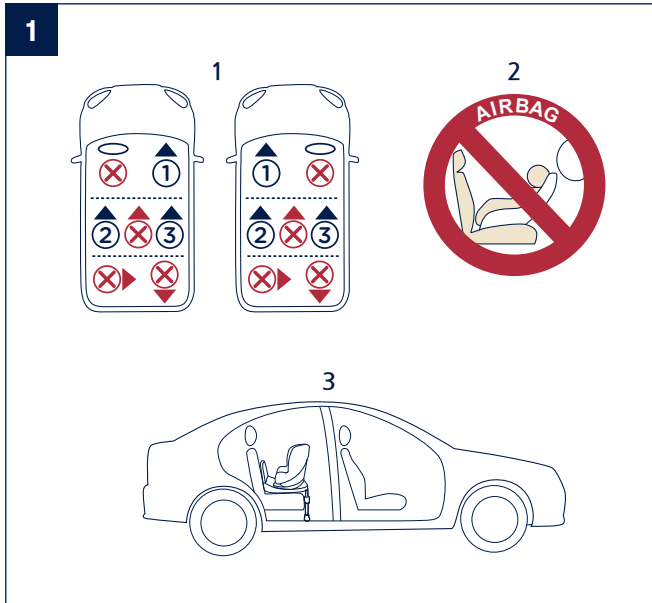
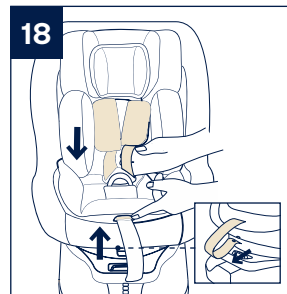
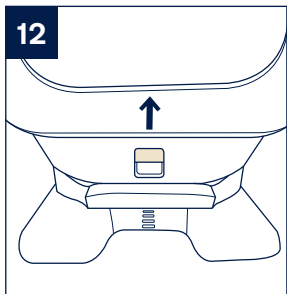
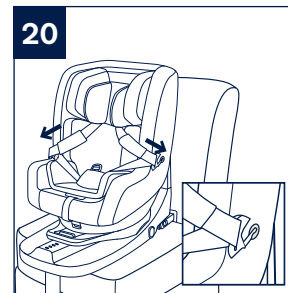
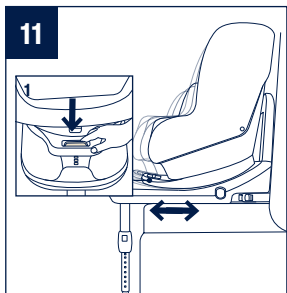
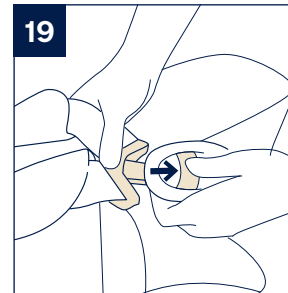
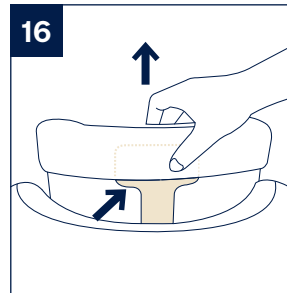
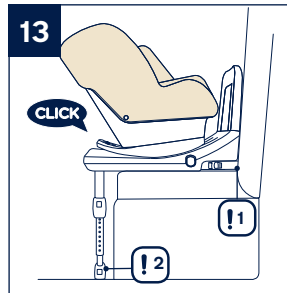
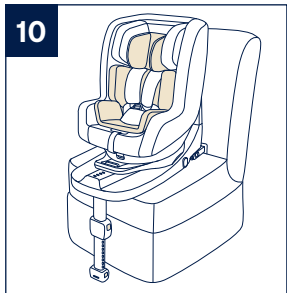
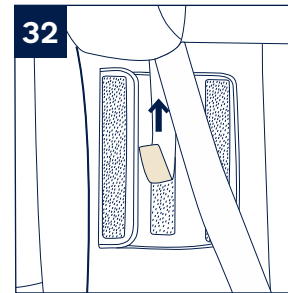
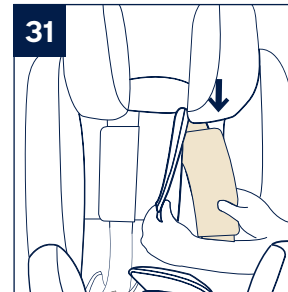
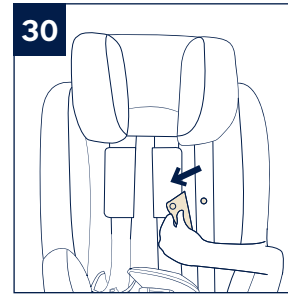
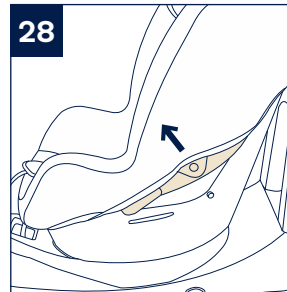
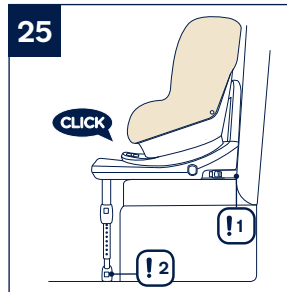
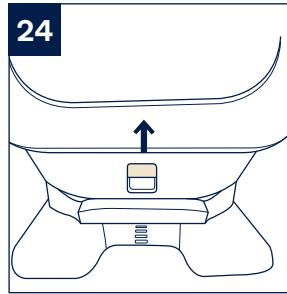
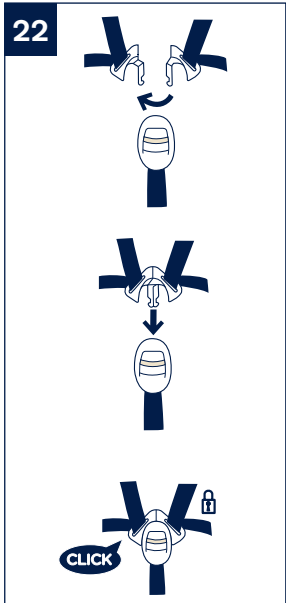

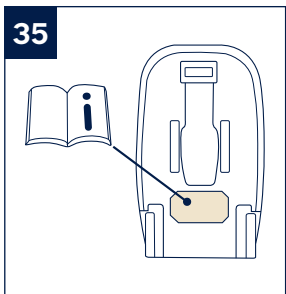
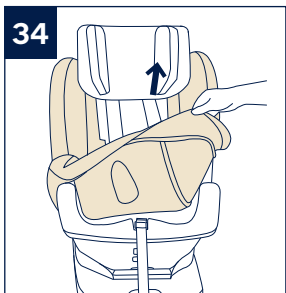
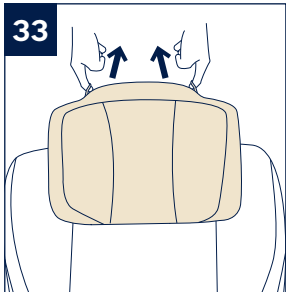

**IMPORTANT!  
KEEP THESE  
INSTRUCTIONS FOR  
FUTURE REFERENCE:**  
*READ CAREFULLY*

## Contents

<b>Product information</b>	3
Product Registration	
Warranty	
<b>Child Usage Requirements</b>	4
<b>For Use with Base</b>	5
<b>Parts List</b>	7
<b>Warnings</b>	8
<b>Product Use</b>	13
<b>Cleaning and Maintenance</b>	20
<b>Vehicle Fitting Information</b>	21
繁中	23

## Product Information

Model Number: \_\_\_\_\_

Manufactured Date: \_\_\_\_\_

### Product Registration

Please fill in the above information. The model number and the manufactured in date are located on the bottom of the REBL plus.

**To register your product please visit:**

<https://nunababy.com/tw/gear-registration>

### Warranty



We have purposely designed our high-quality products so that they can grow with both your child and your family. Because we stand by our product, our gear is covered by a custom warranty per product, starting from the day it was purchased. Please have the proof of purchase, model number and manufactured in date available when you contact us.

**For warranty information please visit:**

[www.nunababy.com/tw/warranty](http://www.nunababy.com/tw/warranty)

## Child Usage Requirements

This product is suitable for use with children who meet the following requirements:

	Installation Mode	Installation	Recline Position
Rearward facing	Child height 40cm–105cm/ Child weight ≤ 18kg		1-7
Forward facing	Child height 76cm–105cm/ Child weight 9-18kg		1-7

## For use with base

- 1 The Enhanced Child Restraint with base is a Universal ISOFIX Class ISO/F2X, ISO/R2 Enhanced Child Restraint and should be fitted using the ISOFIX connections.
- 2 It is for use in “i-Size compatible” vehicle seating positions as indicated by vehicle manufacturers in the vehicle users’ manual.
- 3 If in doubt, consult either the Enhanced Child Restraint System manufacturer or the retailer.

This is an i-Size ISOFIX Enhanced Child Restraint SYSTEM. This Enhanced Child Restraint and base is also approved for use in ISOFIX compatible vehicles. Please refer to the vehicle manufacturer’s website or consult your dealer.

It will fit vehicles with positions approved as i-Size ISOFIX positions (as detailed in the vehicle handbook), depending on the category of the Enhanced Child Restraint and of the fixture. If in doubt, consult either the Enhanced Child Restraint manufacturer or vehicle manufacturer.



## Parts List

- |                              |                                  |
|------------------------------|----------------------------------|
| 1 Head Support               | 10 ISOFIX Adjustment Button      |
| 2 Infant Insert              | 11 Rotating Button               |
| 3 Seat Pad                   | 12 Buckle                        |
| 4 Adjustment Webbing         | 13 Shoulder Strap                |
| 5 Recline Adjustment Button  | 14 Head Support Adjustment Lever |
| 6 Load Leg Adjustment Button | 15 Rebound Bar                   |
| 7 Load Leg                   | 16 ISOFIX Connector              |
| 8 Load Leg Indicator         | 17 ISOFIX Guides                 |
| 9 Load Leg Adjustment Button | 18 ISOFIX Release Button         |

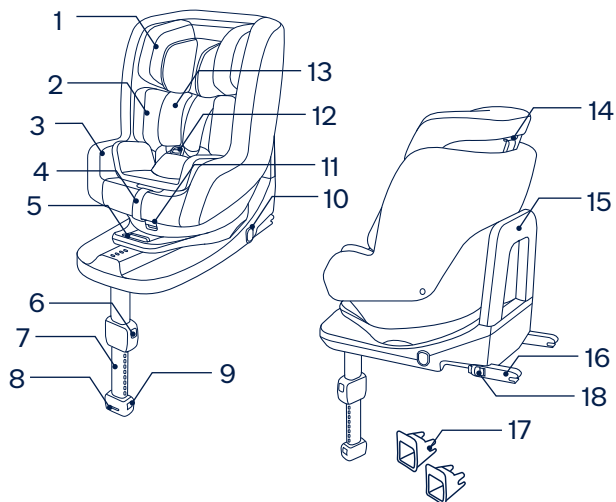

## WARNING

**NO** Enhanced Child Restraint can guarantee full protection from injury in an accident. However, proper use of this Enhanced Child Restraint will reduce the risk of serious injury or death to your child.

Always secure child in Enhanced Child Restraint, even on short trips, as this is when most accidents occur.

Be sure that the Enhanced Child Restraint is installed in such a way that no part of it interferes with movable seats or in the operation of vehicle doors.

**DO NOT** use the rearward facing Enhanced Child Restraint Systems in seating positions where there is an active frontal airbag installed. Death or serious injury may occur. Please reference vehicle owner's manual for more information.

To use this Enhanced Child Restraint with the ISOFIX connections, your child must meet the following requirements.

Rearward Facing: Child height 40cm–105cm/  
Child weight ≤18kg;

Forward Facing: Child height 76cm–105cm/  
Child weight ≤18kg;

**DO NOT** use forward facing before the child's age exceeds 2 years. Keep your child rearward facing as long as possible as rearward facing is the safest position.

The support-leg should be in contact with the vehicle floor and any straps restraining the child should be adjusted to the child's body, and that straps should not be twisted.

After your child is placed in this Enhanced Child Restraint, the child harness must be used correctly, and ensure that any lap strap is worn low down, so that the pelvis is firmly engaged.

**DO NOT** continue to use this Enhanced Child Restraint after it has suffered any type of crash, even a minor one. Replace immediately as there may be invisible, structural damage from the crash.

**DO NOT** install this Enhanced Child Restraint without following the instructions in this manual or you may put your child at serious risk of injury or death.

**NEVER** leave your child unattended with this Enhanced Child Restraint.

**DO NOT** make any modification to this Enhanced Child Restraint or use it along with component parts from other manufacturers.

**DO NOT** use this Enhanced Child Restraint if it has damaged or missing parts.

**DO NOT** use the Enhanced Child Restraint without the soft goods.

Please keep this Enhanced Child Restraint without a textile cover away from sunlight, because it may be too hot for child's skin. Always touch the Enhanced Child Restraint before placing child in it.

The Enhanced Child Restraint soft goods should not be replaced with any other than the ones recommended by the manufacturer, because the soft goods constitute an integral part of the restraint performance.

Any luggage or other objects liable to cause injuries in the event of a collision shall be properly secured.

**DO NOT** have your child in large/oversized clothes because this may prevent your child from being properly and securely fastened by the shoulder harness straps and the crotch strap between the legs.

**DO NOT** leave this Enhanced Child Restraint, or other items unbelted or unsecured in your vehicle because an unsecured Enhanced Child Restraint can be thrown around and may injure occupants in a sharp turn, sudden stop, or collision.

**NEVER** use a second-hand Enhanced Child Restraint or an Enhanced Child Restraint whose history you do not know because it may have structural damage that endangers your child's safety.

**NEVER** use ropes or any other substitutes to secure Enhanced Child Restraint in vehicle or to secure child into Enhanced Child Restraint.

**DO NOT** put anything other than the recommended inner cushions in this Enhanced Child Restraint.

The Enhanced Child Restraint may not fit in all approved vehicles when used in one of these positions.

Remove this Enhanced Child Restraint from the vehicle seat when it is not in regular use.

Consult the distributor for issues concerning maintenance, repair and part replacement.

To avoid the risk of falling out, always secure the child using the safety harness when the child is placed in Enhanced Child Restraint, even when the Enhanced Child Restraint is not in the vehicle.

Before carrying the Enhanced Child Restraint by hand, ensure that the child is fastened with the safety harness.

To avoid serious injury or death, **NEVER** place Enhanced Child Restraint on elevated surface seat with child in it.

The parts of this Enhanced Child Restraint should not be lubricated in any way.

Frequently check the ISOFIX guides for dirt and clean them if necessary. Reliability can be effected by ingress of dirt, dust, food particles etc.

**DO NOT** place any objects in the load leg area in front of your Enhanced Child Restraint.

Correct Installation is only permitted by use of the ISOFIX connectors.

**DO NOT** use any load bearing contact points other than those described in the instructions and marked on the Enhanced Child Restraint.

**Must** use the rebound bar.

## Product Use

**DO NOT** install this Enhanced Child Restraint on vehicle seats that face sideways **(1)** or rearward **(1)** with respect to the moving direction of the vehicle.

**DO NOT** place rear-facing Enhanced Child Restraint on front seat with air bag. Death or serious injury may occur. **(1)** Please reference vehicle owner's manual for more information.

It is recommended to install this Enhanced Child Restraint on the rear vehicle seat. **(1)**

This Enhanced Child Restraint is suitable for vehicle seats with i-Size ISOFIX anchor points. **(2)**

**DO NOT** install this Enhanced Child Restraint on vehicle seats unstable during installation.

### Installation

- 1** - Unfold the load leg from the storage compartment. **(3)**
- 2** - Fit the ISOFIX guides into the ISOFIX anchor points. **(4)** The ISOFIX guides can protect the surface of the vehicle seat from being torn. They will also guide the ISOFIX connectors.
- 3** - Press the ISOFIX release button on either side of the base, then pull out the ISOFIX connectors. **(5)**
- 4** - Line up the ISOFIX connectors with the ISOFIX guides, and then click both ISOFIX connectors into the ISOFIX anchor points. **(6)**

- !** Make sure that both ISOFIX connectors are securely attached to their ISOFIX anchor points. There should be two audible clicks and the colors of the indicators on the both ISOFIX connectors should be completely green. **(6)-1**
- !** Check to make sure the Enhanced Child Restraint is securely installed by pulling on the both ISOFIX connectors.
- 5** - There are 9 adjustable positions for ISOFIX. Press the ISOFIX release button and push the base back against the vehicle seat until tight.
- 6** - After placing the Enhanced Child Restraint on the vehicle seat, extend the load leg to floor. The load leg indicator will show green when installed correctly, red means it is installed incorrectly. **(7)**

The load leg has 24 positions. When the load leg indicator shows red this means the load leg is in the wrong position.

- !** Make sure the load leg is secure by pressing down on the front of the Enhanced Child Restraint.
- !** To shorten the load leg, squeeze the load leg release button and pull the load leg upwards.
- 7** - To remove the Enhanced Child Restraint, press the ISOFIX release button **(5)-1** and pull the base away from the seat, then while squeezing the button and secondary lock on the ISOFIX connectors remove from the vehicle. **(8)**

- 8** - Press the ISOFIX release button to store the ISOFIX. **(9)**

The completely assembled Enhanced Child Restraint is shown as **(10)**

## Recline Adjustment

Squeeze the recline adjustment button **(11)**-1, to adjust the Enhanced Child Restraint to the proper position. The recline angles are shown as **(11)**.

Please recheck the load leg position after reclining.

There are 7 recline angles for baby mode and 7 positions for toddler mode.

## Rearward Facing Mode

### Rearward Facing

Child height 40cm-105cm/Child weight ≤ 18kg

### Recline position

Position 1-7

- 1** - Press the rotating button to rotate the seat facing the rear of the vehicle. **(12)(13)**
- !** Please recline the seat to be in positions 3 through 7 for ease of rotation.
- 2** - Rearward facing mode assembled as **(13)**
- !** The ISOFIX connectors must be attached and locked onto the ISOFIX anchor points. **(13)**-1

- !** The load leg must be installed correctly with green indicator. **(13)**-2

## Height Adjustment for Head Support and Shoulder Harnesses

Check that Shoulder Harness Straps are set at the proper height.

Shoulder Harness Straps must be at a height nearest to your child's shoulders **(14)**, but not above the shoulder line. **(15)**

If the Shoulder Harness Straps are not at the proper height, the child might be ejected the Enhanced Child Restraint if there is a crash.

Squeeze the head support adjustment lever **(16)**, while pulling up or down on the head support until it snaps into one of the 8 positions. The head support positions are shown as **(17)**.

## Securing Child

After the child is placed into the seat, check whether the Shoulder Harness Straps are at proper height.

- 1** - While pressing the adjustment button located at the front of the Enhanced Child Restraint, pull the two Shoulder Harness Straps of the Enhanced Child Restraint. **(18)**
- 2** - Unlock the buckle of the harnesses by pressing the red button. **(19)**

**3** - Fix the buckles on the both sides of seat to make placing the baby more convenient. **(20)**

**4** - Use Infant Insert

Infant insert is for children's protection. **(21)**

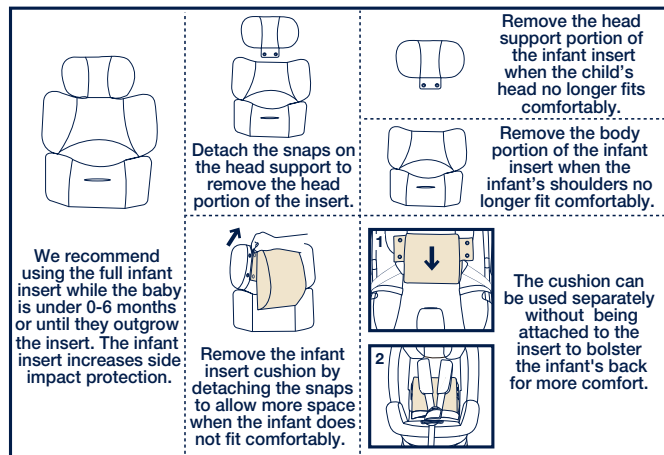

**5** - Place the child into the Enhanced Child Restraint and lock the buckle. Please refer to. **(22)**

**6** - Tighten the shoulder harness straps by pulling the adjustment webbing. **(23)**

Make sure the space between the child and the Shoulder Harness Straps is about the thickness of one hand.

## Forward Facing Mode

### Forward Facing

Child height 76cm-105cm/Child weight≤18kg

### Recline position

Position 1-7

**!** NOT allowed to use forward facing before the age of 2 years.

**1** - Press the rotating button to rotate the seat facing the vehicle's moving direction. **(24)(25)**

**!** Please recline the seat to be in positions 3 through 7 for ease of rotation.

**2** - Forward facing mode assembled as **(25)**

**!** The ISOFIX connectors must be attached and locked onto the ISOFIX anchor points. **(25)-1**

**!** The load leg must be installed correctly with green indicator. **(25)-2**

## Securing Child

After the child is placed into the seat, check whether the Shoulder Harness Straps are at the proper height. **(26)**

**1** - While pressing the adjustment button located at the front of the Enhanced Child Restraint, pull the two Shoulder Harness Straps of the Enhanced Child Restraint. **(18)**

- 2 - Unlock the buckle of the harnesses by pressing the red button. **(19)**
  - 3 - When installing the Enhanced Child Restraint in the toddler mode, do not use the infant insert.
  - 4 - Fix the buckles on the both sides of seat to make placing the baby more convenient. **(20)**
  - 5 - Place the child into the Enhanced Child Restraint and lock the buckle. Please refer to. **(22)**
  - 6 - Tighten the shoulder harness straps by pulling the adjustment webbing. **(27)**
- !** Make sure the space between the child and the Shoulder Harness Straps is about the thickness of one hand.

## Detach Soft Goods

- 1 - Open the buckle, then remove the infant insert.
- 2 - Open the snaps. **(28)**
- 3 - Push the crotch strap through the crotch strap opening. **(29)**
- 4 - Open the snaps on the main seat pad behind shoulder harnesses. **(30)** Move the shoulder harnesses behind the flap below the headrest. **(31)**
- 5 - Detach the hook and loop fasteners to remove the shoulder belt cover. **(32)**
- 6 - Unfasten the elastic on the bottom of headrest to remove the head support soft goods. **(33)**

## 7 - Remove the soft goods. **(34)**

To assemble winter soft goods according to reversed steps above.

Please keep the instruction manual in the storage compartment at the bottom of the Enhanced Child Restraint **(35)**.

## Cleaning and Maintenance

After removing the wedge from the insert, please store it somewhere that the child cannot access it.

Please wash the bottom seat pad and the top seat cover with cold water under 30°C.

Do not iron the soft goods.

Do not bleach or dry clean the soft goods.

Do not use undiluted detergents, gasoline or other organic solvents to wash the Enhanced Child Restraint. It may cause damage to the product.

Use only mild detergent, water and a soft cloth to clean the Enhanced Child Restraint shell and harness straps.

Do not twist the soft goods to dry with great force. It may leave the soft goods with wrinkles.

Please hang dry the soft goods in the shade.

Please remove the Enhanced Child Restraint from the vehicle seat if not in use for a long period of time. Put the Enhanced Child Restraint in a cool, dry place and somewhere your child can not access it.

## Vehicle Fitting Information

The child restraint with base is classified for “Semi-Universal” or ISOFIX child restraint system use. It is suitable for fixing into the seat positions of most cars. The letters on the diagram below correspond with the vehicle fitting positions listed in the following pages.

Seat positions in other cars may also be suitable to accept the child restraint. If in doubt, consult either the child restraint manufacturer or the distributor.

DO NOT install this child restraint on the front vehicle seats.

NEVER install this child restraint on any vehicle seat equipped with safety airbags when used with baby mode.

If your child restraint can be fitted, it is marked with ●

If your child restraint cannot be fitted, it is marked with ○

If your vehicle is not listed in this manual or it is not marked with either a ● or ○ then please refer to your vehicle’s handbook or contact the manufacturer for further information.





## 請妥善保存本說明書 以備不時之需!

使用產品前請仔細閱讀本說明書，並妥善保存以供日後參照。不依照本說明書的指示操作，可能會影響到您寶寶的安全。

## 目錄

產品資訊	25
保固與售後服務	
保固條件	
寶寶使用要求	26
產品資訊	27
產品組件及各部件名稱	29
警告	30
安裝注意事項	33
維修與保養	38
汽車安裝資訊	39

# 產品資訊

產品名稱： \_\_\_\_\_

生產日期： \_\_\_\_\_

## 保固與售後服務

產品於保固期間內發生問題，請與零售商聯絡；若零售商無法提供服務，他們會聯絡當地的Nuna經銷商。請留意產品底部的產品型號與生產日期序號。當有保固需求時，請提供以上產品資訊

請至[nunababy.com/tw/gear-registration](http://nunababy.com/tw/gear-registration)網站登記您購買的產品。

## 保固條件

保固始於產品購買日，我們提供維修服務，但不提供產品退換。保固期限不會因零件更換或維修而延長。Nuna有權利針對產品進行改善設計，此前製造的產品則無更換義務。相關保固資訊，詳見官網：

[www.nunababy.com/tw/warranty](http://www.nunababy.com/tw/warranty)

品名	汽車用兒童保護裝置
型號	REBL plus、CS-30-001TW
適用範圍	新生兒-18公斤(0 - 4歲)的寶寶
主要材質	塑膠、五金、布
原產地	中國

## 寶寶使用要求

本產品適合於滿足下列要求的寶寶：

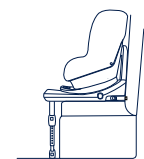
安裝模式	安裝圖示	座椅段位
後向 安裝模式		1-7
前向 安裝模式		1-7

# 產品資訊

- 1 本兒童安全座椅與底座組合構成“半通用類”ISOFIX兒童約束系統。ISOFIX尺寸等級為A、C和D級。質量等級: O+級，I級。
- 2 請參考本說明書“汽車安裝資訊”相關章節。此兒童保護裝置符合安全標準CNS 11497及歐盟安全標準ECE R129/03。作為兒童保護裝置，適合大多數，而不是全部的汽車座椅。
- 3 如有疑問，請諮詢兒童保護裝置製造商或進口商。

## 用ISOFIX固定裝置安裝

這是一個符合安全標準CNS 11497和歐盟安全標準ECE R129/03的ISOFIX兒童保護裝置，可在有ISOFIX固定裝置的汽車上。

根據兒童保護裝置的類別和固定裝置的種類，安裝在ISOFIX固定的位置(如汽車手冊所述)。如有疑問，請諮詢兒童保護裝置製造商或車輛使用手冊。

ISOFIX尺寸等級為A、C和D級。

# 產品組件及各部件名稱

- |           |               |
|-----------|---------------|
| 1 頭靠      | 10 ISOFIX收合按鈕 |
| 2 小座墊     | 11 座椅旋轉按鈕     |
| 3 座墊      | 12 安全扣        |
| 4 調整織帶    | 13 肩帶護片       |
| 5 背靠調整按鈕  | 14 頭靠調整手把     |
| 6 支撐腳調整按鈕 | 15 頂杆         |
| 7 支撐腳     | 16 ISOFIX連接器  |
| 8 支撐腳指示器  | 17 ISOFIX導向器  |
| 9 支撐腳調整按鈕 | 18 ISOFIX釋鎖按鈕 |

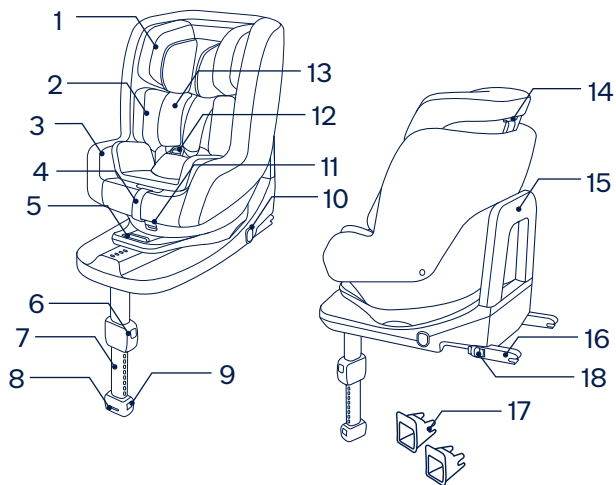

## 警告

沒有任何兒童安全座椅可以保證100%遠離傷亡，然而正確使用本兒童安全座椅可以降低寶寶傷亡的機率。

本兒童安全座椅適用於體重18公斤(約4歲)以下的兒童。

任何束縛兒童之織帶應根據兒童身體進行調節，且此織帶不應扭曲。

前向安裝勿提供2歲以下兒童乘坐，超過2歲兒童，仍宜儘量使用後向安裝。

請勿在未閱讀或了解本兒童安全座椅說明書及汽車說明書之前，使用或安裝本兒童安全座椅。因為可能會導致嚴重受傷或死亡的危險。

請勿擅自改造本兒童安全座椅或使用其他廠商生產的零件來配合本兒童安全座椅使用，會對寶寶造成危險。

本兒童安全座椅如有任何損壞或零件缺失時，請勿繼續使用。

請勿讓您的寶寶穿着過大的衣物，所穿的衣物必須能讓兒童安全座椅的安全帶適當而安全地扣在寶寶兩腿之間。

任何行李或其他可能在碰撞中造成傷害之物品應適當牢固。

將寶寶放在本兒童安全座椅後，必須正確的扣合及使用兒童安全座椅安全帶，並確保腰部織帶能有效束縛骨盆部位。

請勿讓您的寶寶單獨留在兒童安全座椅內無人照顧。

請勿將本兒童安全座椅安裝在汽車前座上。

後向使用時，嚴禁將本兒童安全座椅裝置於有空氣囊的座位上使用。

請勿使用二手兒童安全座椅或來歷不明的兒童安全座椅，因為它們可能會有危害寶寶安全的潛在危險。

請讓兒童安全座椅遠離日光，以免產品溫度過高對兒童的皮膚造成傷害。

請勿把本兒童安全座椅當作平常的椅子使用，會容易翻倒造成傷害。

當本兒童安全座椅沒有座布時，請勿使用。

請勿使用非本製造商推薦的座布，否則會影響兒童安全座椅的總體性能。

請勿在兒童安全座椅內放置其他內墊物品。

請勿讓汽車車門卡住兒童安全座椅的任何組件。

本兒童安全座椅若意外中遭受劇烈撞擊，不可繼續使用，應立即更換兒童安全座椅。意外可能導致兒童安全座椅產生潛在危險。

長期不使用兒童安全座椅時，請將其搬離汽車座椅。

使用本產品前，請取掉PE袋和包裝材料，並放到嬰兒和兒童觸摸不到的地方。

有關零件更換或維修問題，請向進口商諮詢。

請勿將任何物品置於支撐腳附近。

請勿搬運乘坐着兒童的安全座椅。

請時常查看ISOFIX導向器是否有髒污，必要時請清洗導向器。髒污、灰塵、食物殘渣等會影響產品安裝的穩定性。

不可使用除使用說明書中所標注以外之其他受力點。

請勿將未使用ISOFIX固定住的兒童安全座椅留在車內，以免緊急剎車時，傷害到其他乘客。若不經常使用兒童安全座椅時，請將其搬離汽車座椅。

以下汽車座椅不能安裝本兒童安全座椅:

- 1 二點式或三點式安全帶的汽車座椅。
- 2 相對於汽車的行駛方向，橫向或後向的汽車座椅。
- 3 安裝時不穩定的汽車座椅。

必須使用頂杆。

# 安裝注意事項

請勿將此兒童安全座椅安裝在相對於汽車的行駛方向橫向(1)或後向(1)的汽車座椅上。

後向使用時，請勿將此兒童安全座椅安裝在有空氣囊的位置上，防止意外發生時造成實質傷亡。(1)

必須將此兒童安全座椅安裝於汽車後座。(1)

此兒童安全座椅適合安裝在設置有ISOFIX固定裝置的汽車上。(2)

請勿將此產品安裝於可移動的汽車座椅上。

## 安裝底座

- 1 展開底座支撐腳。(3)
  - 2 將ISOFIX導向器固定到ISOFIX固定點上(4)，ISOFIX導向器既可防止汽車座椅表面被刮破，又可為ISOFIX連接器安裝導向。
  - 3 按壓底座的ISOFIX收合按鈕，拉出ISOFIX連接器。(5)
  - 4 將ISOFIX連接器與ISOFIX導向器對齊後，將ISOFIX連接器連接到ISOFIX固定點上。(6)
- ！ 請確定左右兩邊的ISOFIX連接器都已固定到ISOFIX固定點上，且聽到兩次“咔嚓”聲和兩個ISOFIX連接器上的指示器應顯示綠色。(6)-1
- ！ 同時往外拉兩邊的ISOFIX連接器，以確保ISOFIX連接器已固定。

- 5 ISOFIX有9個段位可調。按壓ISOFIX收合按鈕，移動兒童安全座椅，確保兒童安全座椅與汽車座椅背靠緊貼。
- 6 將兒童安全座椅置於合適的汽車座椅，將支撐腳延伸到地面(7)。支撐腳正確安裝時，支撐腳指示器顯示綠色，否則顯示紅色。(7)

支撐腳有24個調整段位，支撐腳指示器顯示紅色時，表示支撐腳處於錯誤段位，請重新操作至正確位置為止。

- ！ 請確保支撐腳與汽車地面完全接觸。
- ！ 按壓支撐腳釋鎖按鈕可將支撐腳向上調整。
- 7 移除兒童安全座椅時，按壓ISOFIX收合按鈕(5)-1，將兒童安全座椅與汽車座椅背靠分離，再按壓兩側的ISOFIX連接器上的第二道安全鎖與釋鎖按鈕，同時將兒童安全座椅往外拉即可。(8)
  - 8 按壓ISOFIX收合按鈕收合ISOFIX連接器。(9)
- 兒童安全座椅安裝完成如(10)所示。

## 座椅背靠角度調整

按壓座椅背靠調整按鈕(11)-1，即可滑動兒童安全座椅本體，並將兒童安全座椅角度調至適當位置，角度調整後如(11)所示。

- ！ 請在座椅調整後再次檢查支撐腳是否正確安裝。後向使用和前向使用的背靠角度調整都有7個段位。

# 後向使用

未滿18公斤/0-4歲的寶寶

參考年齡 新生兒- 4歲

座椅段位 1-7段

1 按壓座椅旋轉按鈕，將兒童安全座椅面向汽車座椅(12)(13)

！ 座椅在3-7段時可以旋轉。

2 後向安裝模式如(13)所示。

！ ISOFIX連接器須鎖定在ISOFIX固定點上。(13)-1

！ 底座支撐腳須正確固定，並以綠色顯示。(13)-2

## 頭靠與肩帶高度調整

檢查肩帶是否在適當位置。

！ 肩帶高度需與寶寶肩膀相同或略低於寶寶的肩膀(14)而不能高於寶寶的肩膀。(15)

！ 如果肩帶沒有在適當的高度，在意外撞擊中，小孩可能會從汽車椅中脫出。

按壓頭靠調整手把(16)，同時上下滑動頭靠到合適高度，頭靠高度共有8個段位，調整如(17)所示。

## 寶寶乘坐

將寶寶放入兒童安全座椅後，請確認肩帶高度是否調整在適當位置。

1 按壓織帶調整器，同時將肩帶拉出至適當長度。(18)

2 按壓紅色按鈕，鬆開安全扣。(19)

3 將安全帶扣具固定在座椅兩側方便放置寶寶。(20)

4 使用小座墊。

小座墊為寶寶提供保護作用。(21)

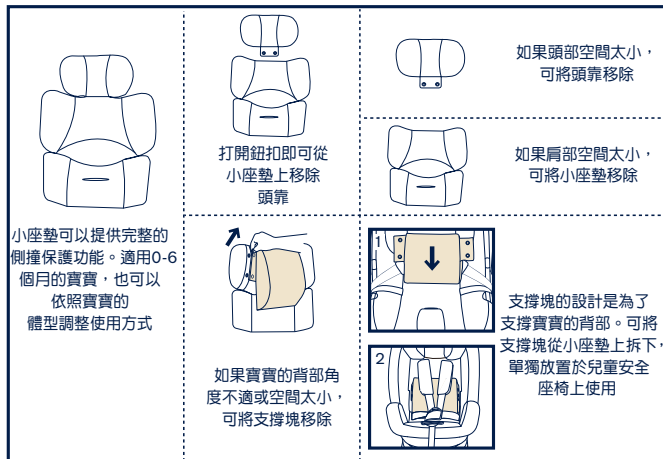

5 扣好安全扣。(22)

6 下拉調整織帶，調整肩帶至適當長度，以配合寶寶身形。(23)

確保寶寶與肩帶之間須可以放進一個手掌的厚度。

## 前向使用

9-18公斤/2-4歲的寶寶

參考年齡 2-4歲

座椅段位 1-7段

1 按壓座椅旋轉按鈕，將兒童安全座椅面向汽車行駛方向。  
(24)(25)

! 座椅在3-7段時可以旋轉。

2 前向安裝模式如(25)所示。

! ISOFIX連接器須鎖定在ISOFIX固定點上。(25)-1

! 底座支撐腳須正確固定，並以綠色顯示。(25)-2

## 寶寶乘坐

將寶寶放入兒童安全座椅後，請確認肩帶高度是否調整在適當位置。(26)

1 按壓織帶調整器，同時將肩帶拉出至適當長度。(18)

2 按壓紅色按鈕，鬆開安全扣。(19)

3 當兒童安全座椅前向使用時，請勿使用小座墊。

4 將安全帶扣具固定在座椅兩側方便放置寶寶。(20)

5 扣好安全扣。(22)

6 下拉調整織帶，調整肩帶至適當長度，以配合寶寶身形。  
(27)

! 確保寶寶與肩帶之間須可以放進一個手掌的厚度。

## 拆卸座布

1 打開安全扣，移除小座墊。

2 打開兩側的鈕扣和固定片。(28)

3 將胯帶穿過胯帶孔。(29)

4 解開鈕扣，將肩帶移到頭靠後面。(30)(31)

5 解開黏扣帶移除肩帶護片。(32)

6 解開頭靠上的鬆緊帶，然後移除頭靠。(33)

7 移除座墊。(34)

反向操作即可組裝冬夏兩用座布。說明書儲存位置如(35)所示。

## 維修與保養

小座墊支撐塊拆除後，請將其存放於寶寶無法接觸到的地方。

請以30度以下水溫清洗。

請勿使用熨斗熨燙。

請勿使用漂白劑及乾洗。

請勿使用未經稀釋的中性清潔劑、汽油或其他有機溶劑清洗兒童保護裝置，否則可能對兒童保護裝置造成損壞。

使用溫和的洗滌劑，水和柔軟的布清洗兒童安全座椅。

請勿大力扭乾，過分大力扭乾可能留下皺褶。

請於陰涼處鋪平晾乾。

當長時間不使用本兒童安全座椅時，請將本兒童安全座椅從汽車座椅上拆除，並存放於陰涼處及寶寶不易接觸的地方。



# 汽車安裝資訊

本兒童安全座椅為“半通用類” ISOFIX兒童保護裝置，適合大多數，而不是全部的汽車座椅。下圖中的數字與“汽車安裝資訊”內的數字相對應。其他汽車內的座椅位置也可能可以安裝本兒童保護裝置，以下車型為車款安裝適配性資料。如有疑問，請諮詢兒童保護裝置製造商或進口商。

請勿將本兒童安全座椅安裝在汽車前座上。

後向使用時，嚴禁將本兒童安全座椅裝置於有空氣囊的座位上使用。

● 表示汽車座椅可安裝本兒童保護裝置。

○ 表示汽車座椅不可安裝本兒童保護裝置。

如果您的汽車品牌未被列入本說明書或未用“●”或“○”進行標示，請查閱您的汽車手冊或聯絡兒童保護裝置製造商，以進一步了解相關資訊。



Alfa Romeo

①      ②      ③

Guilietta (2010 >) ○ ● ●  
Mito (2009 >) ○ ● ●

Audi

A1 (2011 >) ○ ● ●  
A1 Sportback (2012 >) ○ ● ●  
A3 Hatchback (2012 >) ○ ● ●  
A3 S3 (2012 >) ○ ● ●  
A4 (2005) ○ ● ●  
A4 Allroad (2009 >) ○ ● ●  
A4 Av ant (2008 >) ○ ● ●  
A4 Saloon (2008 >) ○ ● ●  
A4 S4 (2009 >) ○ ● ●  
A4 S4 Avant (2009 >) ○ ● ●  
A5 (2007 >) ○ ● ●  
A5 Sportback (2009 >) ○ ● ●  
A5 S5 Sportback (2007 >) ○ ● ●  
A6 (2011 >) ○ ● ●  
A6 Allroad (2011 >) ○ ● ●  
A6 Avant (2011 >) ○ ● ●  
A6 S6 (2011 >) ○ ● ●  
A7 Sportback (2011 >) ○ ● ●  
A8 (2011 >) ○ ● ●  
A8 S8 (2011 >) ○ ● ●  
Q3 (2013 >) ○ ● ●  
Q5 (2009 >) ○ ● ●  
Q7 (2006 >) ○ ● ●  
TT Coupe (2006 >) ○ ● ●

Bentley

Continental GT (2003 - 2011) ○ ● ●  
Continental Flying Spur (2005 - 2012) ○ ● ●

①      ②      ③

Continental GTC (2005 - 2012) ○ ● ●  
Mulsanne (2010 >) ○ ● ●

BMW

1 Series Convertible (2008 >) ○ ● ●  
1 Series Coupe (2008 >) ○ ● ●  
1 Series F20 (2011 >) ○ ● ●  
3 Series Coupe (2007 >) ○ ● ●  
3 Series F30 (2012 >) ○ ● ●  
5 Series M5 (2005 - 2011) ○ ● ●  
5 Series Saloon (2003 - 2010) ○ ● ●  
5 Series Touring (2011 >) ○ ● ●  
5 Series Touring (2003 - 2010) ○ ● ●  
5 Series (2011 >) ○ ● ●  
6 Series Coupe (2011 >) ○ ● ●  
6 Series Convertible (2011 >) ○ ● ●  
6 Series Gran Coupe (2011 >) ○ ● ●  
7 Series (2010 >) ○ ● ●  
X1 (2010 >) ○ ● ●  
X3 F25 (2011 >) ○ ● ●  
X5 (2007 >) ○ ● ●  
X6 (2008 >) ○ ● ●  
X6 M (2008 >) ○ ● ●  
3-GT (2013 >) ○ ● ●  
5-GT (2010 >) ○ ● ●

Cadillac

BLS Saloon (2006 - 2011) ○ ● ●

Chevrolet

Aveo (2012 >) ○ ● ●  
Captiva (2007 >) ○ ● ●  
Cruze (2009 >) ○ ● ●  
Spark (2012 >) ○ ○ ○

	①	②	③
Volt (2011 >)	○	●	●
Matiz (2005 - 2009)	○	●	●
Orlando (2011 >)	○	●	●
Traxx (2013 >)	○	●	●
<b>Chrysler</b>			
Grand Voyager (2008 >)	○	●	●
300 C (2012 >)	○	●	●
Delta (2011 >)	○	●	●
Ypsilon (2011 >)	○	●	●
<b>Citroen</b>			
Berlingo Multispace (2007 >)	○	○	○
C1 (2005 >)	○	●	●
C3 5 Door (2009 >)	○	●	●
C3 Picasso (2009 >)	○	●	●
C4 (2010 >)	○	●	●
C4 Picasso (2007 >)	○	○	○
C5 Saloon (2008 >)	○	○	○
C5 Tourer (2008 >)	○	○	○
DS3 (2010 >)	○	●	●
DS4 (2011 >)	○	●	●
DS5 (2013 >)	○	○	○
<b>Dacia</b>			
Duster (2012 >)	○	●	●
Sandero (2013 >)	○	●	●
<b>Fiat</b>			
500 (2008 >)	○	●	●
500 C (2009 >)	○	●	●
Abarth 500 (2009 >)	○	●	●
Bravo (2007 >)	○	●	●

	①	②	③
500L (2013 >)	○	●	●
Panda (2012 >)	○	●	●
Grande Punto (2006 >)	○	●	●
Abarth Grande Punto (2008 - 2011)	○	●	●
<b>Ford</b>			
B Max (2012 >)	○	●	●
C Max (2003 >)	○	○	○
Escape (2002)	○	○	○
Fiesta (2008 >)	○	●	●
Focus (2010 >)	○	●	●
Focus CMax (2003 - 2010)	○	○	○
Galaxy (2006 >)	○	○	○
KA (2009 >)	○	●	●
Kuga (2013 >)	○	●	●
Mondeo Estate (2007 >)	○	●	●
Mondeo Hatchback (2007 >)	○	●	●
Mondeo Saloon (2007 >)	○	●	●
S Max (2006 >)	○	○	○
<b>Honda</b>			
Accord Saloon (2008 >)	○	●	●
Accord Tourer (2008 >)	○	●	●
Civic (2012 >)	○	●	●
Civic (2006 - 2011)	○	●	●
Civic Hybrid Saloon (2006 - 2010)	○	●	●
Civic Type R (2007 - 2010)	○	●	●
CRV (2007 - 2013)	○	●	●
FRV (2006 - 2011)	○	●	●
Insight (2009 >)	○	●	●
Jazz (2008 >)	○	●	●

	①	②	③
<b>Hyundai</b>			
i10 Hatchback (2008 >)	○	●	●
i20 Hatchback (2009 >)	○	●	●
i30 (2012 >)	○	●	●
i40 (2011 >)	○	●	●
iX20 (2010 >)	○	●	●
iX35 (2010 >)	○	●	●
SantaFe (2012 >)	○	●	●
Tucson (2010 >)	○	●	●
Veloster (2012 >)	○	●	●

<b>Infiniti</b>			
EX (2009 >)	○	●	●
FX (2009 >)	○	●	●
G Coupe (2009 >)	○	○	○
G Saloon (2009 >)	○	○	○
M (2010 >)	○	●	●

<b>Jaguar</b>			
X-Type (2001 - 2010)	○	●	●
X-Type estate (2004 - 2010)	○	●	●
XF (2008 >)	○	●	●
XF R (2009 >)	○	●	●
XF Sportbrake (2013 >)	○	●	●
XJ (2010 >)	○	●	●
XK (2006 >)	○	●	●
XK Convertible (2006 >)	○	●	●
XK R (2006 >)	○	●	●

<b>Jeep</b>			
Grand Cherokee (2011 >)	○	●	●
Compass (2011 >)	○	●	●

	①	②	③
<b>Kia</b>			
Ceed Hatchback (2012 >)	○	●	●
Optima (2012 >)	○	●	●
Picanto (2008 >)	○	●	●
Rio (2012 >)	○	●	●
Sorento (2012 >)	○	●	●
Soul (2009 >)	○	●	●
Sportage (2011 >)	○	●	●
Venga (2010 >)	○	○	○

<b>Land Rover</b>			
Discovery 4 (2009 >)	○	●	●
Freelander 2 (2006 >)	○	●	●
Range Rover (2013 >)	○	●	●
Range Rover (2002 - 2012)	○	●	●
Range Rover Sport (2005 - 2012)	○	●	●
Range Rover Sport (2013 >)	○	●	●
Range Rover Evoque (2011 >)	○	●	●

<b>Lancia</b>			
Thema (2012 >)	○	●	●
Voyager (2010 >)	○	●	●
Ypsilon (2012 >)	○	●	●

<b>Lexus</b>			
CT (2011 >)	○	●	●
GS (2013 >)	○	●	●
IS Saloon (2005 - 2012)	○	●	●
RX (2010 >)	○	●	●

<b>Mazda</b>			
CX-5 (2011 >)	○	●	●
CX-7 (2007 - 2011)	○	●	●

	①	②	③
2 (2007 >)	○	●	●
2 Saloon (2007 >)	○	●	●
3 (2010)	○	●	●
3 Hatchback (2009 >)	○	●	●
3 Saloon (2009 >)	○	●	●
5 (2005 >)	○	●	●
6 Estate (2008 - 2012)	○	●	●
6 Hatchback (2007 - 2012)	○	●	●
6 Saloon (2007 - 2009)	○	●	●
6 Saloon (2013 >)	○	●	●
6 Estate (2012 >)	○	●	●

### Mercedes-Benz

A Class (2005 - 2012)	○	●	●
A Class (2013 >)	○	●	●
B Class (2012 >)	○	●	●
C Class (2008 >)	○	●	●
C Class Estate (2008 >)	○	●	●
C Class Coupe (2011 >)	○	●	●
CLA (2013 >)	○	●	●
CLS Shootingbrake (2012 >)	○	●	●
CLS Coupe (2011 >)	○	●	●
E Class (2009 >)	○	●	●
E Class Coupe (2009 >)	○	●	●
E Class Estate (2009 >)	○	●	●
E-Class Saloon (2013 >)	○	●	●
GL Class (2006 - 2012)	○	●	●
M/ML Class (2005 - 2012)	○	●	●
R Class (2006 - 2012)	○	●	●
S Class (2006 - 2013)	○	●	●
SL Class (2012 >)	○	-	-
SLK (2011 >)	○	-	-

### Mini

	①	②	③
Mini Hatchback (2006 >)	○	●	●
Mini Cooper S (2006 >)	○	●	●
Mini Coupe (2009 >)	○	-	-
Mini Countryman (2010 >)	○	●	●

### Mitsubishi

Colt Plus (2014)	○	○	○
ASX (2010 >)	○	●	●
Colt (2007 >)	○	●	●
Miev (2009 - 2012)	○	●	●
Lancer (2008 - 2011)	○	●	●
Lancer Sportback (2008 - 2011)	○	●	●
Lancer Ralliart (2009 - 2011)	○	●	●
Outlander (2007 - 2013)	○	●	●
Shogun (2007 >)	○	●	●

### Nissan

Tiida (2012)	○	○	○
Livina (2007)	○	○	○
Sentra (2004)	○	○	○
Juke (2010 >)	○	●	●
Micra (2011 >)	○	●	●
Note (2006 >)	○	●	●
Qashqai+2 (2008 >)	○	●	●
X-Trail (2007 >)	○	●	●

### Opel

Adam (2013 - >)	○	●	●
Agila (2008 >)	○	●	●
Ampera (2011 >)	○	●	●
Antara (2007 >)	○	●	●
Astra 5dr (2010 >)	○	●	●
Astra Estate (2010 >)	○	●	●

	①	②	③
Astra GTC (2011 >)	○	●	●
Corsa D (2007 - 2012)	○	●	●
Corsa 3dr Hatchback (2006 >)	○	●	●
Corsa 5dr Hatchback (2006 >)	○	●	●
Corsa VXR (2007 >)	○	●	●
Insignia Hatchback (2009 >)	○	●	●
Insignia Saloon (2009 >)	○	●	●
Insignia Sports Tourer (2009 >)	○	●	●
Meriva (2010 >)	○	●	●
Mokka (2013 >)	○	●	●
Zafira (2005 >)	○	●	●
Zafira VXR (2005 >)	○	●	●

## Peugeot

107 (2005 >)	○	●	●
207 3dr (2006 - 2012)	○	●	●
207 5dr (2006 - 2012)	○	●	●
207 SW (2007 - 2012)	○	●	●
208 3dr (2013 >)	○	●	●
208 5dr (2013 >)	○	●	●
307 (2001 - 2007)	○	●	●
307 Estate (2002 - 2007)	○	●	●
308 Hatchback (2008 >)	○	●	●
308 SW (2008 >)	○	●	●
3008 (2009 >)	○	○	○
4008 (2011 >)	○	●	●
508 (2011 >)	○	●	●
508 SW (2011 >)	○	●	●
508 RXH (2013 >)	○	●	●
5008 (2010 >)	○	○	○
RCZ (2011 >)	○	○	○

## Porsche

Cayenne (2011 >)	○	●	●
Panamera (2011 >)	○	●	●

## Renault

	①	②	③
Clio (2005 - 2012)	○	●	●
Clio Renault Sport (2006 - 2012)	○	●	●
Clio Sport Tourer (2007 - 2012)	○	●	●
Clio (2013 >)	○	●	●
Laguna (2008 - 2012)	○	●	●
Laguna Sport Tourer (2008 - 2012)	○	●	●
Megane Hatchback (2008 >)	○	●	●
Megane Saloon (2006 - 2009)	○	●	●
Megane Tourer (2006 - 2009)	○	●	●
Megane Sport (2006 - 2009)	○	●	●
Megane Sport Tourer (2009 >)	○	●	●
Modus (2004 - 2012)	○	●	●
Grand Modus (2008 - 2012)	○	●	●
Scenic (2009 >)	○	○	○
Twingo (2012 >)	○	●	●

## Saab

9-3 (2002 - 2012)	○	●	●
9-3 Sport Wagon (2005 - 2012)	○	●	●
9-3 X (2009 - 2012)	○	●	●
9-5 Estate (2005 - 2010)	○	●	●
9-5 (2011 - 2012)	○	●	●

## Seat

Alhambra (2010 >)	○	●	●
Altea (2004 - 2011)	○	●	●
Altea XL (2007 - 2011)	○	●	●
Altea Freerack4 (2007 - 2009)	○	●	●
Exeo (2008 >)	○	●	●
Exeo ST Estate (2008 >)	○	●	●
Ibiza Cupra (2009 >)	○	●	●

	①	②	③
Ibiza FR (2009 >)	○	●	●
Ibiza Hatchback (2008 >)	○	●	●
Leon Cupra (2007 - 2011)	○	●	●
Leon FR (2006 - 2012)	○	●	●
Leon Hatchback (2005 - 2012)	○	●	●
Leon (2013 >)	○	●	●
Mii (2012 >)	○	●	●
Toledo (2013 >)	○	●	●

## Skoda

Citigo (2012 >)	○	●	●
Fabia Estate Combi (2008 >)	○	●	●
Fabia Hatchback (2007 >)	○	●	●
Octavia Estate Combi (2005 - 2013)	○	●	●
Octavia Hatchback (2004 - 2013)	○	●	●
Octavia Scout (2007 - 2013)	○	●	●
Octavia Hatchback (2013 >)	○	●	●
Rapid (2013 >)	○	●	●
Roomster (2006 >)	○	●	●
Superb Combi Estate (2008 >)	○	●	●
Superb (2008 >)	○	●	●
Yeti (2009 >)	○	●	●

## Smart

For Two Coupe (2007 >)	○	-	-
------------------------	---	---	---

## Ssangyong

Kyron (2005 - 2011)	○	●	●
---------------------	---	---	---

## Suzuki

Alto (2009 >)	○	●	●
Grand Vitara (2006 >)	○	●	●
Splash (2008 >)	○	●	●

	①	②	③
Swift (2011 >)	○	●	●
SX-4 (2006 >)	○	●	●
SX-4 Saloon (2009 >)	○	●	●

## Subaru

BRZ (2012 >)	○	●	●
--------------	---	---	---

## Toyota

Corolla Altis (2011)	○	○	○
Vios (2011)	○	○	○
Camry (2011)	○	○	○
Wish (2011)	○	●	●
Auris (2007 - 2012)	○	●	●
Avensis Hatchback (2009 >)	○	●	●
Auris (2013 >)	○	●	●
Avensis Tourer (2009 >)	○	●	●
Aygo (2005 >)	○	●	●
GT86 (2012 >)	○	●	●
Land Cruiser (2003 - 2009)	○	●	●
Land Cruiser (2009 >)	○	●	●
Prius (2004 - 2009)	○	●	●
Prius (2009 >)	○	●	●
Prius Plus + (2012 >)	○	●	●
Rav 4 MK3 (2006 - 2011)	○	●	●
RAV4 (2013 >)	○	●	●
Verso (2009 - 2011)	○	●	●
Verso (2012 >)	○	○	○
Yaris Hatchback (2011 >)	○	●	●
Yaris SR (2007 - 2009)	○	●	●

## Vauxhall

Adam (2013 >)	○	●	●
Agila (2008 >)	○	●	●
Ampera (2011)	○	●	●

	①	②	③
Antara (2007 >)	○	●	●
Astra 5dr (2010 >)	○	●	●
Astra Estate (2010 >)	○	●	●
Astra GTC (2011 >)	○	●	●
Corsa D (2007 >)	○	●	●
Corsa 3dr Hatchback (2006 >)	○	●	●
Corsa 5dr Hatchback (2006 >)	○	●	●
Corsa VXR (2007 >)	○	●	●
Insignia Hatchback (2009 >)	○	●	●
Insignia Saloon (2009 >)	○	●	●
Insignia Sports Tourer (2009 >)	○	●	●
Meriva (2010 >)	○	●	●
Mokka (2013 >)	○	●	●
Zafira (2005 >)	○	●	●
Zafira VXR (2005 - 2010)	○	●	●

## Volkswagen

Beetle (2012 >)	○	●	●
Multivan Caravelle (2003 >)	○	●	●
Golf Cabriolet (2009 - 2012)	○	●	●
Golf Hatchback (2009 - 2012)	○	●	●
Golf Hatchback MK7 (2012 >)	○	●	●
Golf GTI (2009 - 2012)	○	●	●
Golf Plus (2009 - 2011)	○	●	●
Jetta (2011 >)	○	●	●
Passat (2010 >)	○	●	●
Passat (2005 - 2010)	○	●	●
Passat Alltrack (2012 >)	○	●	●
Passat CC (2008 >)	○	●	●
Passat Estate (2005 >)	○	●	●
Polo 3dr (2009 >)	○	●	●
Polo 5dr (2009 >)	○	●	●
Scirocco (2008 >)	○	●	●
Sharan (2010 >)	○	●	●
Tiguan (2008 >)	○	●	●

	①	②	③
Touareg (2012 >)	○	●	●
Touran (2003 - 2010)	○	●	●
Touran (2010 >)	○	○	○
UP! (2012 >)	○	●	●
<b>Volvo</b>			
C30 (2007 - 2012)	○	●	●
S60 (2010 >)	○	●	●
S80 (2007 >)	○	●	●
V40 (2012 >)	○	●	●
V40 Cross Country (2012 >)	○	●	●
V60 (2011 >)	○	●	●
V70 (2008 >)	○	●	●
XC60 (2008 >)	○	●	●
XC60 (2013 >)	○	●	●
XC70 (2008 >)	○	●	●
XC90 (2003 >)	○	●	●
<b>Luxgen</b>			
U6 Turbo (2013)	○	○	○
U7 Turbo (2010)	○	●	●