

pipa relx™ base



nuna®

IM-000030F



Nuna Baby Essentials, Inc.

70 Thousand Oaks Blvd. | Morgantown, PA 19543

1.855.NUNA.USA | nunababy.com



Easy Installation

Our products are designed to make your life easier, so installing this child restraint doesn't require outside assistance.

While we encourage the use of Certified Child Passenger Safety Technicians to ensure you have installed the seat correctly, you can install the restraint in your vehicle without these professionals by carefully reading and following these instructions.



**IMPORTANT!
KEEP THESE
INSTRUCTIONS
FOR FUTURE
REFERENCE!**
*READ
CAREFULLY*

Contents

Product Information	4
Product Registration	4
Recall Information	4
Warranty	5
Contact	5
Child Usage Requirements	6
Warnings	6
Car Seat/Base Use after a Crash	11
Vehicle Compatibility	12
Parts List	16
Stability Leg	18
Installation	22
Rigid Latch	22
Lap/Shoulder or Lap Belt	28
Cleaning and Maintenance	36

Product Information

Model Number: _____

Manufactured in (date): _____

Product Registration

Please fill in the above information. The model number and the manufactured in date are located on a label on the bottom of the base. Fill out the prepaid registration postcard attached to the seat pad and mail it today.

Child restraints could be recalled for safety reasons. You must register this restraint to be reached in a recall. Send your name, address, e-mail address if available and the restraint's model number and manufacturing date to:

Nuna Baby Essentials Inc.
70 Thousand Oaks Blvd.
Morgantown, PA 19543
or call 1.855.NUNA.USA

Recall Information

For recall information, call the U.S. Government's Vehicle Safety Hotline at: 1.888.327.4236 (TTY: 1.800.424.9153) or go to <http://www.NHTSA.gov>

Warranty

We have purposely designed our high-quality products so that they can grow with both your child and your family. Because we stand by our product, our gear is covered by a custom warranty per product, starting from the day it was purchased. Please have the proof of purchase, model number and manufactured in date available when you contact us.

For warranty information, please visit: nunababy.com/warranty

Contact

For replacement parts, service, or additional warranty questions, please contact our customer service department.

In the USA:
infousa@nunababy.com
nunababy.com
1.855.NUNA.USA

Child Usage Requirements

This base is suitable for use with children who meet the following requirements:

Weight: 4 to 32 lb (2 to 14.5 kg)

Height: less than 32 inches (81 cm)

It is recommended to keep your child rear facing as long as possible, until at least 2 years old.

This base is compatible with all USA PIPA series infant car seats **except** the PIPA urbn. You **MUST** follow all warnings and instructions provided with the original PIPA series infant car seat. Never attempt to use another manufacturer's seat on this base.

WARNING

DEATH OR SERIOUS INJURY can occur if you fail to follow the warnings, instructions and labels on the child restraint.

A child's safety is your responsibility. **NEVER** leave your child unattended.

Read all instructions before use of this child restraint or installation in a vehicle. In addition, read the

vehicle owner's manual for information on child restraint installation.

Use the bottom of the base for instruction manual storage.

Register your child restraint with the manufacturer.

Secure this child restraint with the vehicle's child restraint anchorage system if available, or with a vehicle belt.

This child restraint can **ONLY** be used in a rear facing position when using in a vehicle. The child restraint cannot be properly secured in a forward facing position, and will be unsafe. Use only with children who weigh between 4 and 32 pounds (2 and 14.5 kg) and whose height is 32 inches (81 cm) or less. Exceeding these height and weight limits is unsafe.

Cover the child restraint when your vehicle is parked in sunlight. Parts of a child restraint can become very hot if left in the sun, and can burn a child's skin. Check for hot parts before putting your child in the child restraint.

NEVER use a car seat that has been involved in a moderate to severe crash. **See page 11** to learn what is classified as a moderate to severe crash.

Snugly adjust the belts provided with this child restraint around your child.

If straps are not snugly adjusted, child may be ejected from seat in the event of an accident.

A snug strap should not allow any slack. It lies in a relatively straight line without sagging. It does not press on the child's flesh or push the child's body into an unnatural position.

EXPIRATION DATE Check the label on the underside of the base or child restraint for expiration date information.

FALL HAZARD Child's activity can move carrier. **NEVER** place carrier on counter tops, tables, or any other elevated surface. Always stay within arm's reach whenever carrier is not on floor/ground. Be sure handle locks into position before lifting carrier.

The carrier can fall from a shopping cart. **DO NOT** use on a shopping cart.



STRANGULATION HAZARD Children have strangled in loose or partially buckled harness straps. Fully restrain the child at all times even when carrier is used outside the vehicle.

SUFFOCATION HAZARD Infant carrier can roll over on soft surfaces and suffocate child. **NEVER** place carrier on beds, sofas, or other soft surfaces.

ALWAYS check child restraint to base connection.

DO NOT allow child restraint or handle to contact the vehicle interior (side of car door or seat in front) when installed on base.

DO NOT use child restraint if it has frayed or cut harness straps, or is damaged in any way. To find out if damaged parts are replaceable, call 1-855-NUNA-USA.

NEVER modify any part of the child restraint.

DO NOT allow anyone who has not read the instruction manual to install or use this child restraint.

DO NOT use any products or accessories with this child restraint unless they are approved by Nuna for use with this child restraint. Doing so may be unsafe and may void the warranty.

DO NOT leave child restraint and base in vehicle when uninstalled, even when unoccupied. In a crash, it could become a projectile and injure other vehicle occupants.

NEVER use clothing or blankets that interfere with providing a properly tightened harness. An unsecured or improperly harnessed child can come out of the restraint during a crash. Place blankets over child **AFTER** harness has been properly tightened.

Only use with Nuna strollers or appropriate Nuna adapters designed for use with other strollers.

Car Seat and Base Use after a Crash

The National Highway Traffic Safety Administration (NHTSA) recommends that car seats be replaced following a moderate or severe crash. Car seats do not automatically need to be replaced following a minor crash.

What defines a minor crash?

A minor crash is one in which **ALL** of the following apply:

- The vehicle was able to be driven away from the crash site.
- The vehicle door nearest the car seat was not damaged.
- None of the passengers in the vehicle sustained any injuries in the crash.
- If the vehicle has air bags, none of the air bags deployed during the crash; and
- There is no visible damage to the car seat.

NEVER use a car seat that has been involved in a moderate to severe crash. Contact Nuna with questions or concerns about your seat.

Information from nhtsa.gov

Vehicle Compatibility

You **MUST** read and understand **ALL** child restraint related instructions and warnings in your vehicle owner's manual to correctly and safely use this child restraint in your vehicle.

This child restraint can **ONLY** be installed on vehicle seats that face forward. **DO NOT** install in seats that face to the sides or rear of the vehicle.

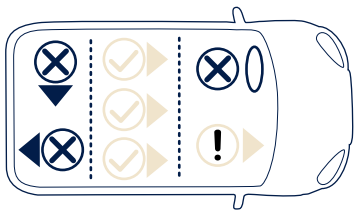

NEVER install this child restraint rear facing in a vehicle seating position with a frontal air bag unless it is

turned off. Airbags inflate with great force and can cause severe injury to a child's neck and spine. If your vehicle is equipped with passenger

side air bags, check your vehicle owner's manual for child restraint installation instructions.

According to accident statistics, children are safer when properly restrained in the rear seating positions than in the front seating positions.

Vehicle Belt Use

Refer to your vehicle owner's manual to determine if the belts in your vehicle lock by switching the seat belt's retractor **OR** if they have a locking latch plate that locks the vehicle's seat belt so they will hold the child restraint tightly without loosening.

(Vehicle Belt Use continued on the next page)

These vehicle belts **CANNOT BE USED** with your child restraint. Install with lower anchors instead.

1 - Motorized Belts (Automatic)

These should not be used unless the shoulder belt can be removed, the lap belt is locked and use is allowed by the vehicle manufacturer.

2 - Dual Retractor Belts

If allowed by the manufacturer, the lap belt only may be used to secure the child restraint in accordance with this manual and the vehicle owner's manual.

3 - Non-Locking (ELR) Lap Belts

This belt locks in a crash or sudden stop and should only be used with a belt shortening clip. Contact your vehicle manufacturer if needed.

4 - Airbag/Inflatable Belts

This belt cannot be used to install this child restraint.

5 - Door Mounted Belts

This belt cannot be used to install this child restraint.

6 - Lap Belts forward of Seat Bight

This belt (Where the seat bottom and seat back meet) should not be used to install this child restraint.

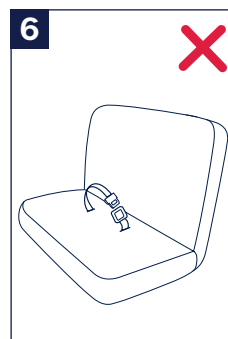
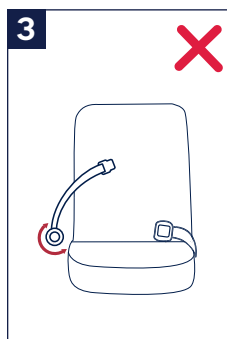
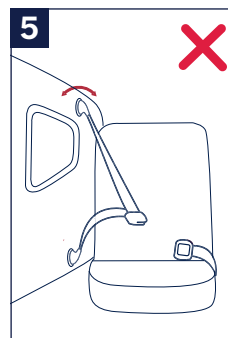
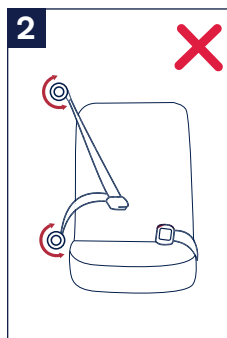
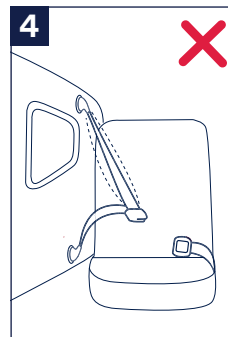
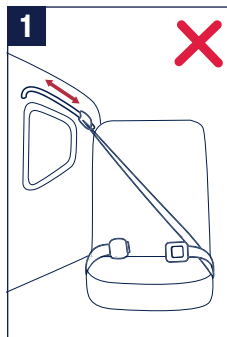

Parts List

Make sure all parts are available before assembly. If any part is missing, please contact Nuna (see page 5 for information). No tools are required for assembly.

- 1 Latch Guides
- 2 Vehicle Belt Lock Off
- 3 Lock Off Release Button
- 4 Belt Positioner
- 5 Rigid Latch (Lower Anchors)
- 6 Rigid Latch Release Button
- 7 Recline Indicator Window
- 8 Recline Adjustment Button
- 9 Child Restraint Release Button
- 10 Stability Leg
- 11 Stability Leg Adjustment Button
- 12 Stability Leg Indicator
- 13 Stability Leg Storage Release Button
- 14 Stability Leg Storage
- 15 Instruction Manual Storage (under Stability Leg)

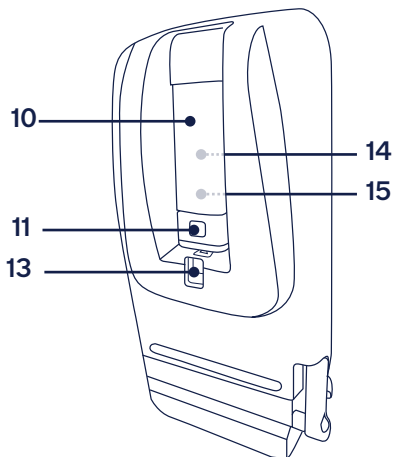
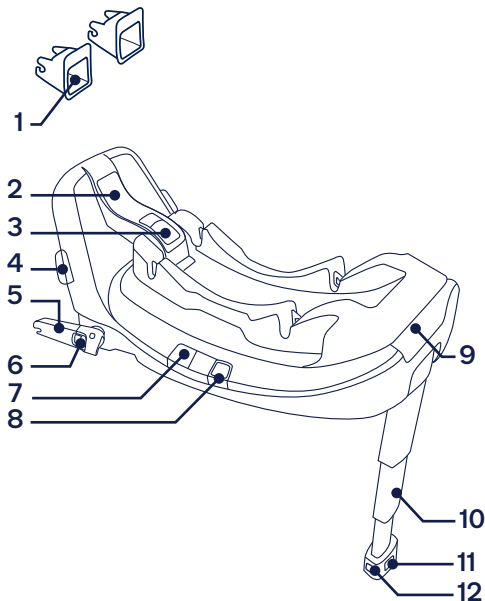

Stability Leg

Refer to vehicle owner's manual to determine if stability leg can be used.

- 1 - Press release button on bottom of base to release the stability leg from storage.
- 2 - Let the stability leg hang over the edge of the vehicle seat. After correctly installing the base on the vehicle seat, press the stability leg adjustment button and extend the stability leg perpendicular to the floor.
- 3 - Extend stability leg far enough that it contacts the floor, the stability leg indicator turns green, and the leg locks into position. Make sure the stability leg is firmly planted on the floor of the vehicle and does not easily slide around.
- 4 - Indicators should show green, meaning the stability leg is properly contacting the floor.

⚠ If the stability leg indicator shows red, the stability leg is not making firm contact with the vehicle floor. Adjust as needed. **Stability leg should be perpendicular to the floor.**

(continued on the next page)

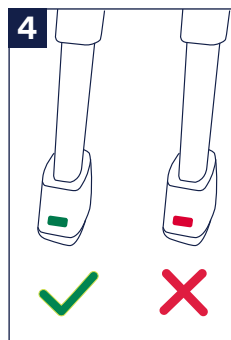
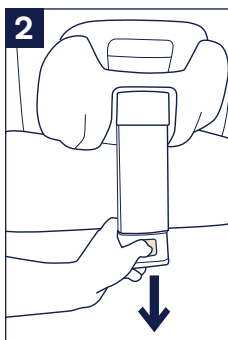
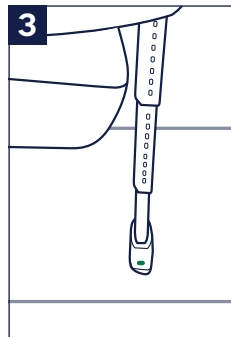
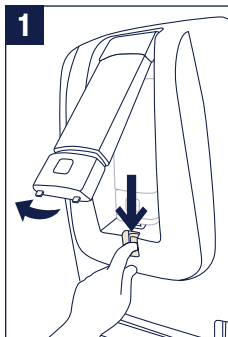

Stability Leg *(continued)*

1 - If stability leg lifts base more than 1 inch off the seat, adjust as needed to close the gap.

⚠ DO NOT use stability leg to recline the base. The recline adjustment feature is meant to recline the base.

2 - Always store stability leg when not in use. Press adjustment button to shorten stability leg, then push leg into storage area. Push until the release button clicks into place.

The stability leg can be used or stored for both rigid latch and vehicle belt installation.

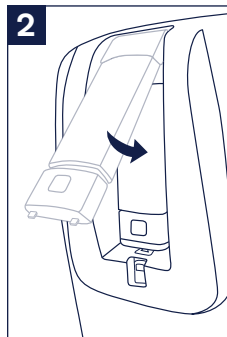
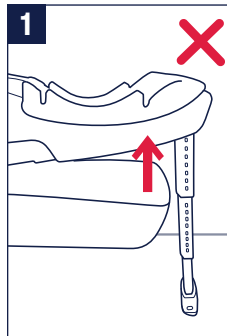

Installation

! If child is not secured properly, child could be ejected in a sudden stop or crash, resulting in serious injury or death.

PIPA RELX Base Installation Using Rigid Latch (Lower Anchors)

- 1 - Rotate rigid latch (lower anchors) down and point them away from base.
- 2 - Position base in a forward facing vehicle seat with the stability leg deployed (if using) (p.18).

It is recommended that you use the stability leg, which reduces crash forces in the event of an accident.

- 3 - If preferred, install latch guides on vehicle lower anchor bars.
- 4 - Grasp rigid latch anchors and push down and forward to connect to vehicle lower anchor bars.

Be sure that the base bottom is firmly seated on vehicle seating surface and there is no gap between the base bottom and vehicle seat.

(continued on the next page)

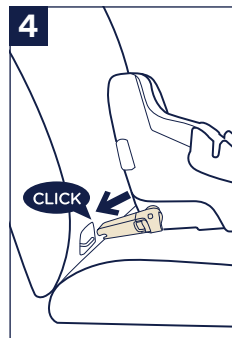
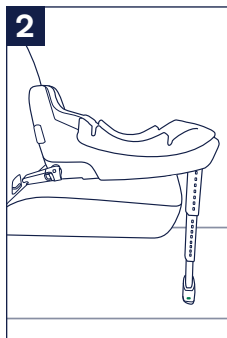
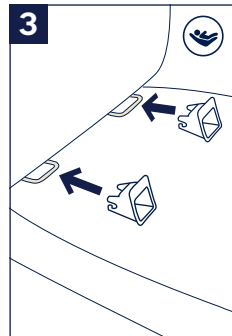
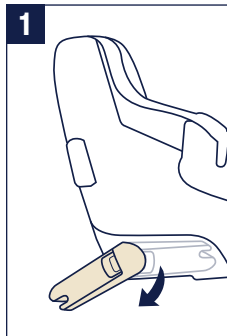

PIPA RELX Base Installation Using Rigid Latch (Lower Anchors) *(continued)*

- 1 - Check installation by pulling on the base **AND** seeing that green is indicated on the connectors.
- 2 -  The rigid latch must be attached and locked onto the vehicle anchor bars with the indicator showing green. If used, the stability leg indicator must show green.

Retracted Positions

- 3 - There are three positions to which the bottom of the base retracts. In some vehicles, this is necessary to allow the base to sit against the vehicle seat back.
- 4 - If there is a gap between the back of the base and the vehicle seat **after** the rigid latch lower anchors have been attached, push on the top and/or back of the base until it touches the vehicle seat and a “click” indicates it’s locked into a retracted position.

A gap is acceptable if the base clicks through **all** retracted positions but is still not fully against the vehicle seat.

(continued on the next page)

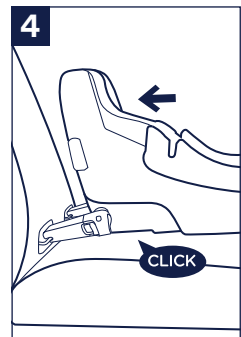
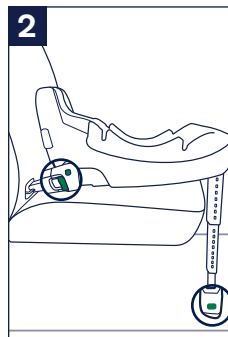
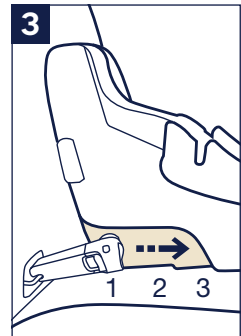
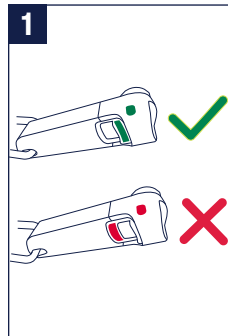

PIPA RELX Base Installation Using Rigid Latch (Lower Anchors) *(continued)*

- 1 - You can reset the retracted base back to its original position by unhooking the rigid latch from the vehicle lower anchor bars (p.34) and rotating the rigid latch up into the storage position.

Check the Installation

- 2 - Test the security of the installation **near the rigid latch (a)**, not **at the end of the base (or seat) (b)**.

- Some side-to-side movement on the lower anchor bars could occur. This does not create an unsafe condition if the rigid latch (lower anchors) are attached to these bars on both sides of the base.
- The rigid latch indicators must show green.
- The stability leg indicator (if using) must show green.
- Check that the base is pushed as close to the vehicle seat back as possible and any gap is reduced or eliminated.
- There should be no gap between the vehicle seat and the bottom of the base.

It is acceptable to install with both rigid latch and the vehicle belt. (See vehicle belt installation on the next page.)

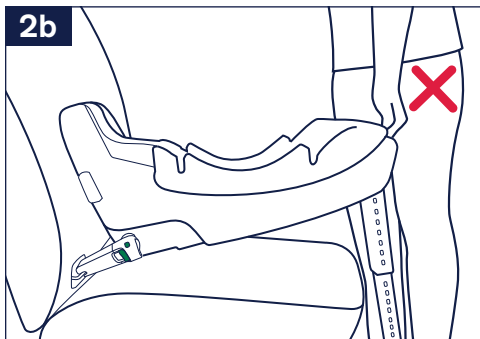
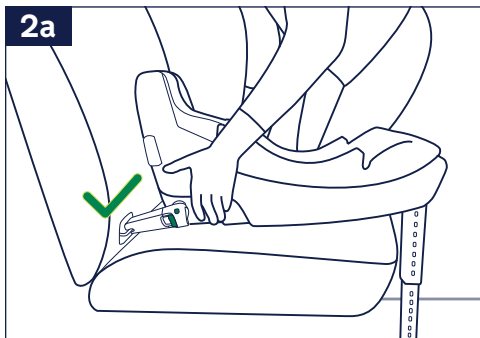
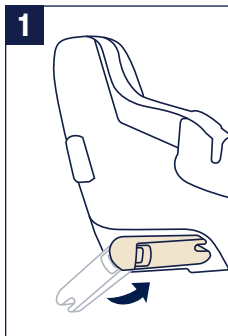

PIPA RELX Base Installation Using Lap/Shoulder or Lap Belt Only

- 1 - Position base in a forward facing vehicle seat with the stability leg deployed (if using) (p.18).

It is recommended that you use the stability leg, which reduces crash forces in the event of an accident.

- 2 - Lift the lock off release button.
- 3 - Route the **lap belt** across the area labeled “lap belt here.” Route the **shoulder belt** diagonally across the area labeled “shoulder belt here.”
- 4 - If the vehicle belt comes in contact with the belt positioner on the side of the base, route the belt under the positioner.
- 5 - Buckle the vehicle belt. Both the shoulder **AND** lap belt must be under the vehicle belt lock off and belts must lay flat.
- 6 - While pressing the base firmly downward onto the vehicle seat, (1) tighten the vehicle belt by pulling upward on the shoulder belt (2).

(continued on the next page)

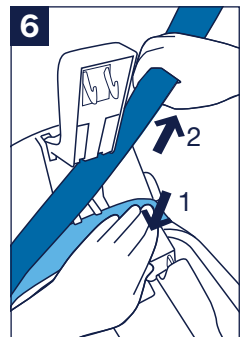
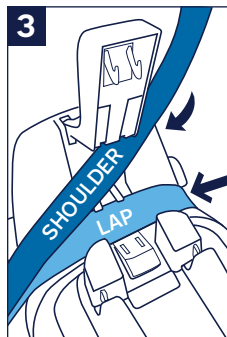
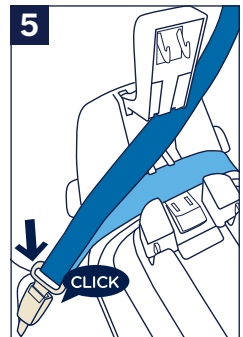
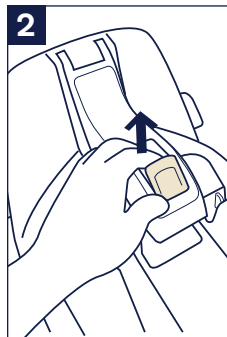
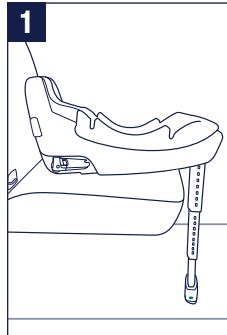

PIPA RELX Base Installation Using Lap/Shoulder or Lap Belt Only *(continued)*

1 - With the shoulder belt tight, push down on the lock off to close it.

If your vehicle belt locks (check your owner's manual), lock it **only after** the vehicle belt lock off on the base is closed.

Lap Belt Only

If vehicle has a lap belt only, route the lap belt along the lap belt path under the lock off.

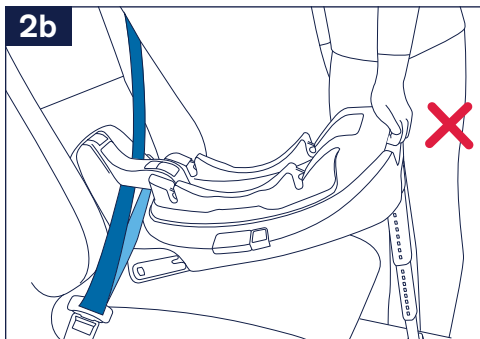
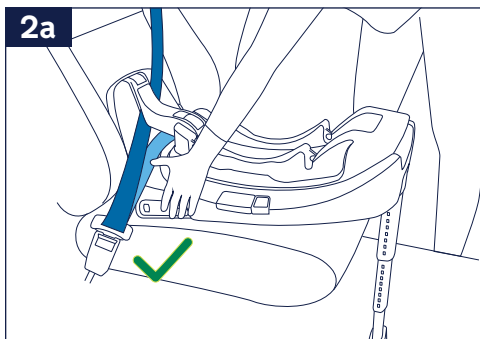
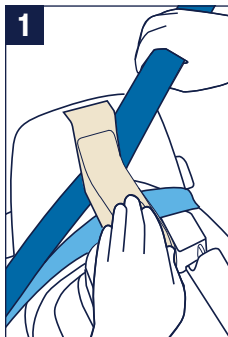

Check the Installation

2 - Test the security of the installation **near the belt path (a)**, not **at the end of the base (or seat) (b)**.

- Base should not move side to side more than 1" **at the belt path**.
- Belt(s) must be tight.
- Belt(s) and buckle must not interfere with attachment of child restraint to base.
- Vehicle belt(s) must lay flat under lock off.
- The stability leg indicator (if using) must show green.
- There should be no gap between the vehicle seat and the bottom of the base.

It is acceptable to install with both rigid latch (p.22) and the vehicle belt.

Attaching Child Restraint to PIPA RELX Base

Any USA PIPA series infant car seat can be used on PIPA RELX base.

- 1 - After child is properly secured in child restraint, lower child restraint onto base and listen for a click. Check that child restraint is locked onto the base by pulling up on the handle.

⚠ DO NOT allow child restraint or handle to contact the vehicle interior (side of car door or seat in front) when installed on base.

Recline Adjustment

PIPA RELX features a recline you can use on the go without uninstalling the seat. Choose a position that matches your child's weight and height.

Recline positions 1 & 2:

4–20 lb, up to 32 inches

Recline positions 3 & 4:

21–32 lb, up to 32 inches

- 2 - While firmly pushing the recline button all the way down, slide the top of the base. Release the button; if the button does not pop back up, the recline is not locked. Gently push or pull the top of the base until it locks into position.

(continued on the next page)

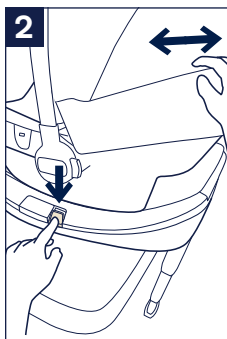

Recline Adjustment *(continued)*

Check the Installation

- After recline adjustment, check that the child restraint is still securely attached to the base by pulling up on the handle.

Releasing Child Restraint from PIPA RELX Base

- 1 - To release the child restraint, squeeze the child restraint release button (1) located on the base, then pull the child restraint up (2).

Uninstalling PIPA RELX Base

When Installed with Rigid Latch:

- 2 - Squeeze the rigid latch release buttons.
- 3 - Pull the base off of the bars.
- 4 - Rotate the rigid latch back into storage position.

When Installed with Lap and Shoulder Belt:

- 5 - Lift the lock off release button.
- 6 - Unbuckle the vehicle belt and un-route the shoulder and lap belt from the base. Remove the base.

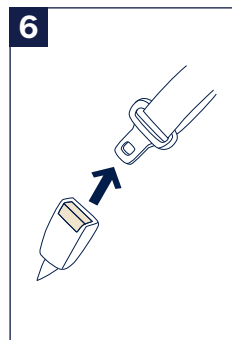
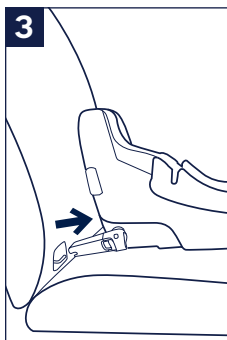
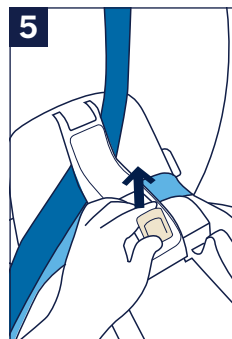
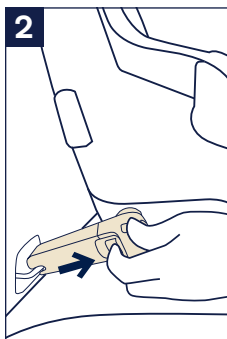
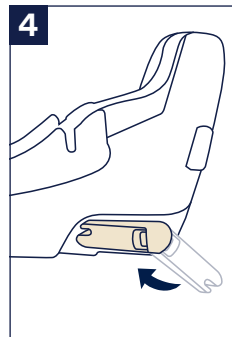
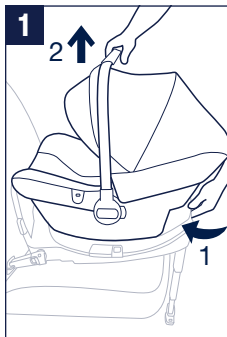

Cleaning and Maintenance

Use only mild detergent, water and a soft cloth to clean the base.

Air dry.

Check regularly if everything functions properly. If any parts are broken or missing, stop using this product.

For infant carrier cleaning and maintenance, see your carrier instruction manual.

Nuna Baby Essentials, Inc. Nuna and all associated logos are trademarks.