

nuna®



mixx™ series
child tray

Designed
around your life



**IMPORTANT!
KEEP THESE
INSTRUCTIONS
FOR FUTURE
REFERENCE:
*READ CAREFULLY***

Contents

Product Information	4
Warranty	
Contact	
Warnings	5
Product Use	6
Cleaning and Maintenance	6

Product Information

Model Number: _____

Manufactured in (date): _____

Please fill in the above information. The model number and the manufactured in date are located on the bottom of the carton.

Warranty

We have purposely designed our high-quality products so that they can grow with both your child and your family. Because we stand by our product, our gear is covered by a custom warranty per product, starting from the day it was purchased. Please have the proof of purchase, model number and manufactured in date available when you contact us.

For warranty information please visit:

www.nunababy.com/warranty

Contact

For replacement parts, service, or additional warranty questions, please contact our customer service department in your region.

www.nunababy.com

!WARNING

Failure to follow these warnings and instructions could result in serious injury or death.

A child's safety is your responsibility. **NEVER** leave your child unattended.

The child tray is not designed to restrain the child, use the stroller harness at all times.

To prevent a hazardous or unstable condition, do not place more than 1 lb (0.5 kg) in the child tray.

Only use with Nuna MIXX series strollers.

DO NOT use the child tray to lift or carry the stroller.

DO NOT use the child tray for foods or beverages above 110°F (43°C) and always wash before/after each use (see cleaning instructions).

Product Use

⚠ Always secure the child with the harness.
The child tray is not a restraint device.

Remove the arm bar before use of the child tray.

The child tray can only be used on the occupant's right side.

- 1** - Insert the end of the child tray into the arm bar mount on the occupant's right side. A "click" sound means the child tray is securely attached.
- 2** - To remove the child tray, press the arm bar release button **(1)** located under the seat pad, and pull the child tray out **(2)**.

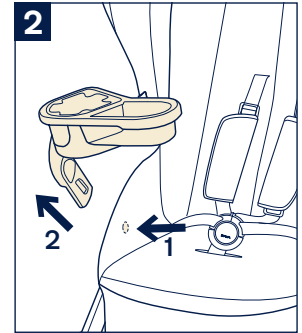
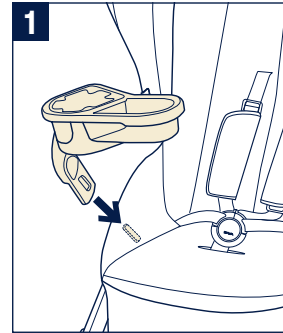

Cleaning and Maintenance

The child tray is not dishwasher safe. Wash with lukewarm water and a mild dish soap. Rinse, then drip dry or towel dry.

重要!
保留以備參照，
請詳細閱讀
使用產品前請仔細閱讀
本說明書，並妥善保存
說明書以便日後參考。

目錄

產品資訊	10
保固與售後服務	
保固條件	
聯絡我們	
警告	12
產品使用	12
維護與保養	12

產品資訊

產品名稱：_____

生產日期：_____

保固與售後服務

產品於保固期間內發生問題，請與零售商聯絡；若零售商無法提供服務，他們會聯絡當地的Nuna經銷商。請留意紙盒上的產品型號與生產日期序號。當有保固需求時，請提供以上產品資訊。請至www.nunababy.com/tw/gear-registration網站登記您購買的產品。

保固條件

保固始於產品購買日，我們提供維修服務，但不提供產品退換。保固期限不會因零件更換或維修而延長。Nuna有權利針對產品進行改善設計，此前製造的產品則無更換義務。

相關保固資訊，詳見官網：
www.nunababy.com/tw/warranty

聯絡我們

我們期望不斷改進並開發新的產品，請隨時告知您對Nuna產品的意見和建議。

taiwanservice@nunababy.com

www.nunababy.com/tw

產品名稱	MIXX 系列餐盤
材 質	塑膠、五金
尺寸(cm)	尺寸淨重依實際產品填入
淨 重(kg)	3.27
最大載重	0.5 公斤
委 製 商	巧兒宜國際股份有限公司
進 口 商	巧兒宜國際股份有限公司
原 產 地	中國
地 址	台北市內湖區瑞光路431號2樓
電 話	02-27973000
統一編號	52603333
代 理 商	杏豐實業股份有限公司
地 址	台北市中華路一段59號10樓之1
電 話	02-66358858
統一編號	16998578

⚠ 警告

此餐盤不具備保護寶寶的功能，請始終正確使用手推車安全帶。

在餐盤中請勿放置超過1磅（0.5千克），以免餐盤不穩定產生危險。

請勿使用餐盤抬起或是拉動手推車。

請勿放置超過110°F（43°C）的食物或熱飲在餐盤或置物杯中，並且在清洗之前/每次使用之後（參考清潔保養）

產品使用

⚠ 請正確使用手推車安全帶，餐盤不能作為束縛裝置使用。

安裝前需移除前扶手，餐盤僅能安裝於手推車右側。

- 1- 將餐盤支架插入手推車前扶手右側安裝孔中，聽到“喀”聲即安裝完成。
- 2- 按壓前扶手移除鈕(1)，將其向外移除(2)。

維修與保養

請勿機洗，請使用肥皂及溫水洗滌。

置於陰涼處晾乾和用乾燥的毛巾擦拭。

