

Designed
around your life

nuna®

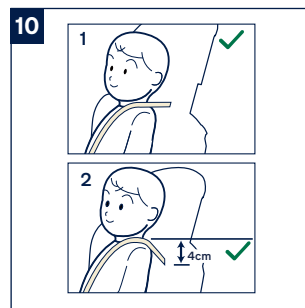

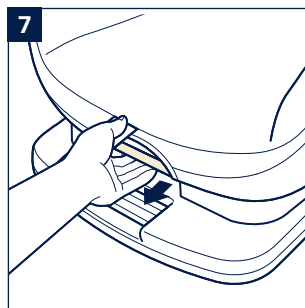

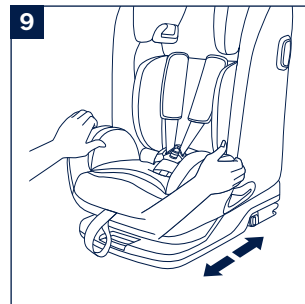
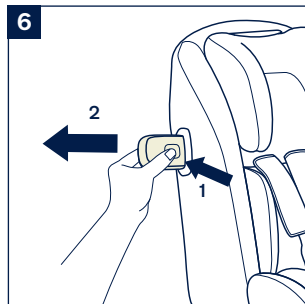
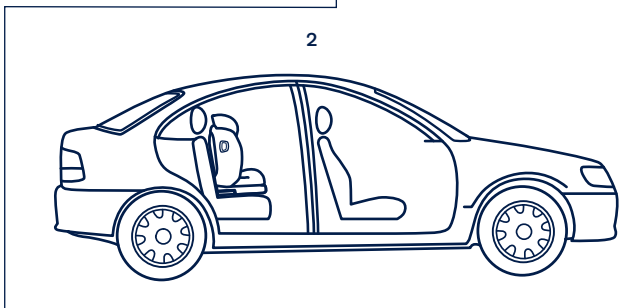
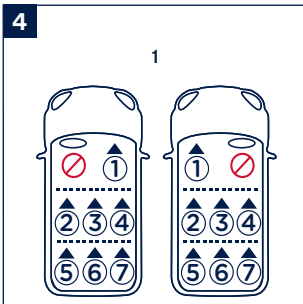
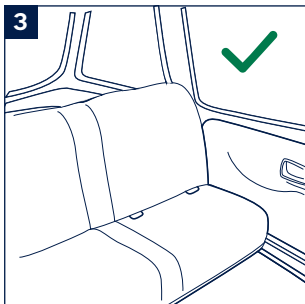
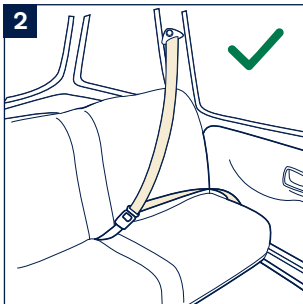
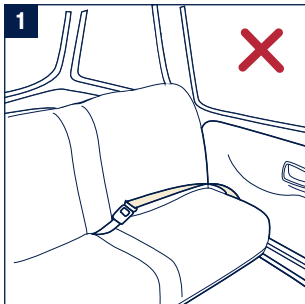
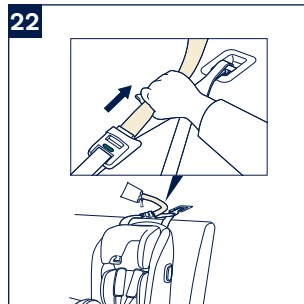
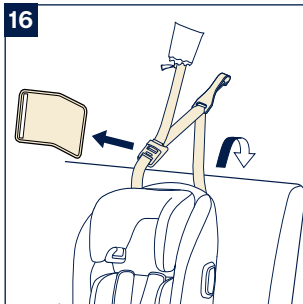
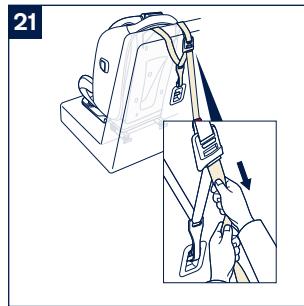
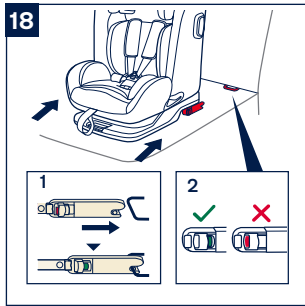
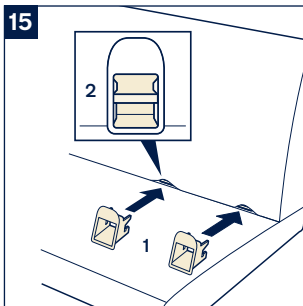
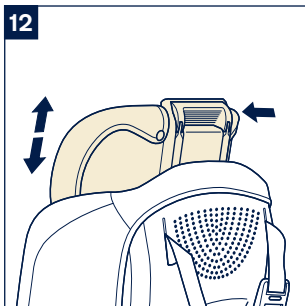
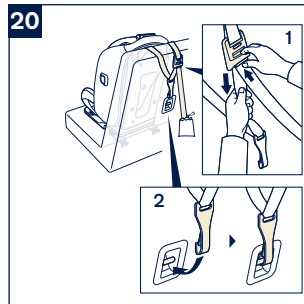
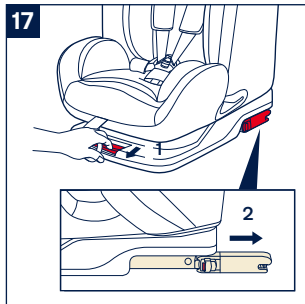
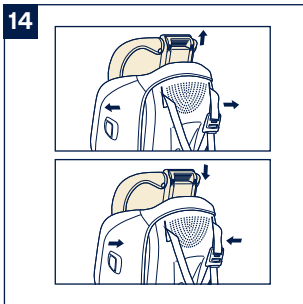
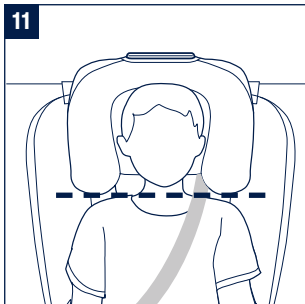
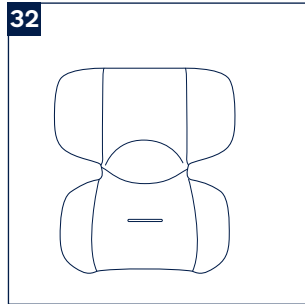
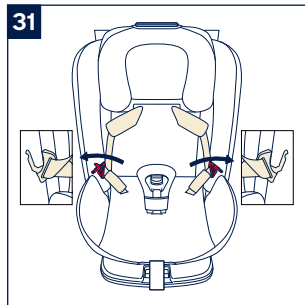
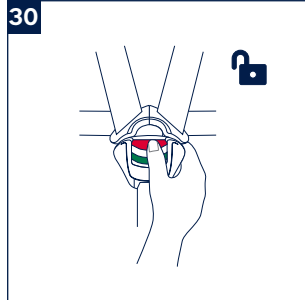
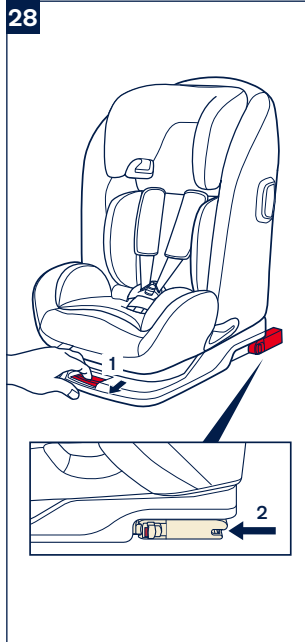
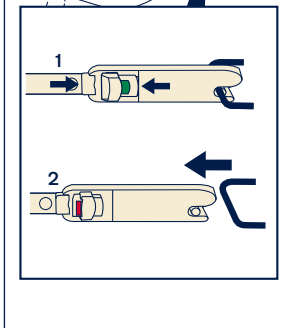
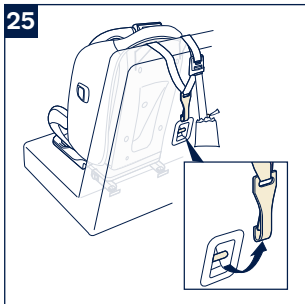
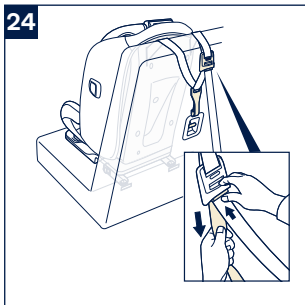
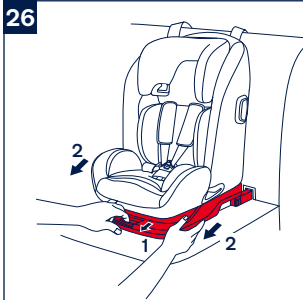

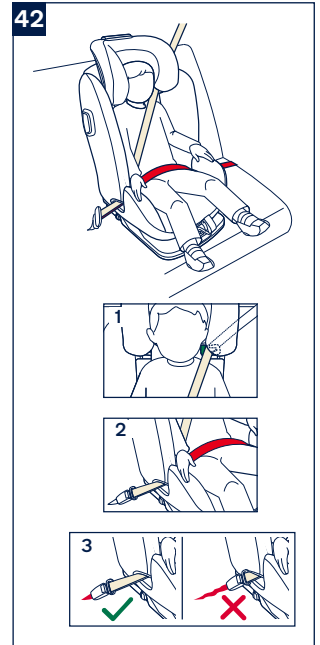
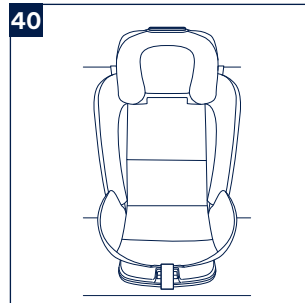
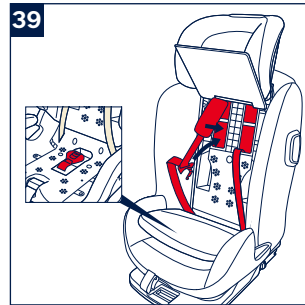
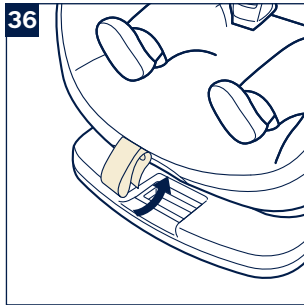
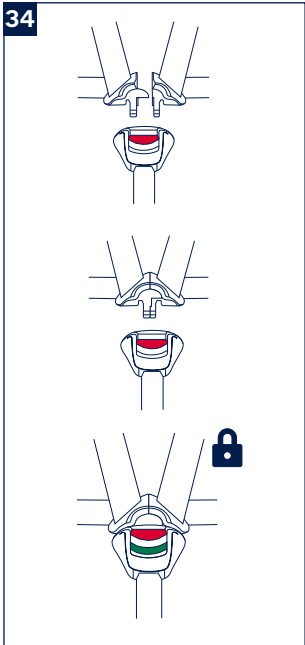
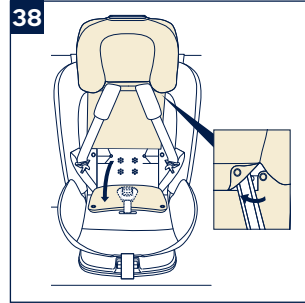
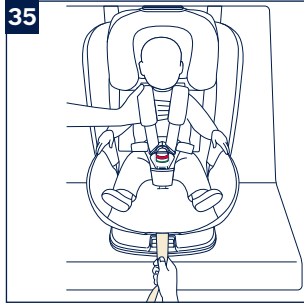
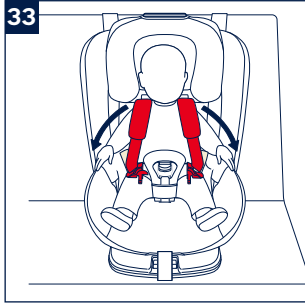

43

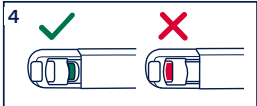
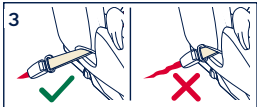

44

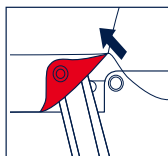
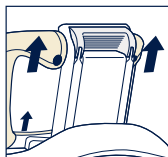

45

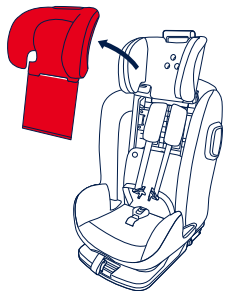

46

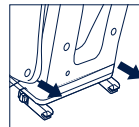
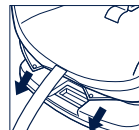
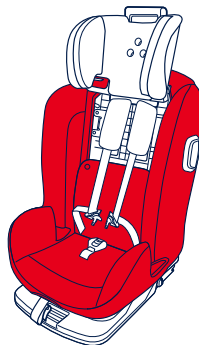

47

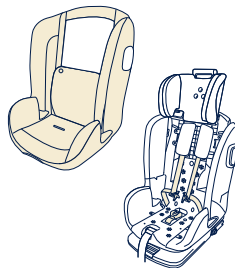

IMPORTANT!
KEEP THESE
INSTRUCTIONS FOR
FUTURE REFERENCE:
READ CAREFULLY

Contents

Product Information	3
Product Registration	
Warranty	
Contact	
Child Usage Requirement	4
Parts List	5
Warnings	7
Product Set Up	9
Product Use	9
Cleaning and Maintenance	14
Vehicle Fitting Information	15

Product Information

Model Number: _____

Manufactured in (date): _____

Product Registration

Please fill in the above information. The model number and the manufactured in date are located on the bottom of the MYTI.

To register your product please visit:

www.nunababy.com

Click the "Register Gear" link on the homepage.

Warranty

We have purposely designed our high-quality products so that they can grow with both your child and your family. Because we stand by our product, our gear is covered by a custom warranty per product, starting from the day it was purchased. Please have the proof of purchase, model number and manufactured in date available when you contact us.

For warranty information please visit:

www.nunababy.com

Click the "Warranty" link on the homepage.

Contact

For replacement parts, service, or additional warranty questions, please contact our customer service department.

info@nunababy.com

www.nunababy.com

In the United Kingdom:

infouk@nunababy.com

www.nunababy.com

NUNA International B.V.

Van der Valk Boumanweg 178 C



2352JD Leiderdorp

The Netherlands

Child Usage Requirements

This product is suitable for use with children who meet the following requirements:

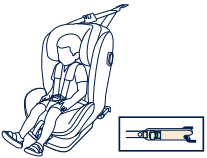
! IMPORTANT - DO NOT USE BEFORE THE CHILD'S AGE EXCEEDS 15 MONTHS (Refer to instructions)

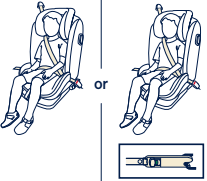
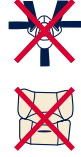
Child's Size	Installation Mode	Installation	Reference Age	Recline Position
76cm-105cm/ 9kg-19.5kg	Toddler mode		 Please use the infant insert to support the child if the child shoulders is lower than the headrest bottom edge.	15 months to approx 4 years Position 1-3
100cm-150cm/ 15kg-36kg	Junior mode			3 years to approx 12 years Position 1-3

For installation with ISOFIX system + Top Tether

- 1 - This is an i-Size Enhanced Child Restraint System. It is approved according to UN Regulation No.129, for use in, i-Size compatible vehicle seating positions as indicated by vehicle manufacturers in the vehicle users' manual.
- 2 - If in doubt, consult either the Enhanced Child Restraint System manufacturer or the retailer.

For installation with 3-point belt

For installation with 3-point belt + ISOFIX system

- 1 - This is an i-Size booster seat Enhanced Child Restraint System. It is approved according to UN Regulation No.129, for use primarily in "i-Size seating positions " as indicated by vehicle manufacturers in the vehicle user's manual.

- 2 - If in doubt, consult either the Enhanced Child Restraint System manufacturer or the retailer.
- 3 - When the applicable height is 135cm-150cm, it belongs "Specific vehicle booster seat".

Parts List

- 1 Head Support
- 2 Lower Back Support
- 3 Infant Insert
- 4 Shoulder Strap
- 5 Harness Buckle
- 6 Webbing Adjustment Button
- 7 Recline Adjustment Button
- 8 ISOFIX Releasing Button
- 9 Vehicle Shoulder Belt Guide
- 10 Side Impact Shield
- 11 Shoulder Harness Strap Cover
- 12 Vehicle Lap Belt Guide
- 13 Head Support Adjustment Lever
- 14 Top Tether Strap
- 15 Tether Strap Adjuster
- 16 Tether Hook
- 17 Pocket
- 18 ISOFIX Connector
- 19 ISOFIX Guides
- 20 Side Impact Shield
- 21 IM Storage Pocket (Please keep this IM in storage pocket anytime)

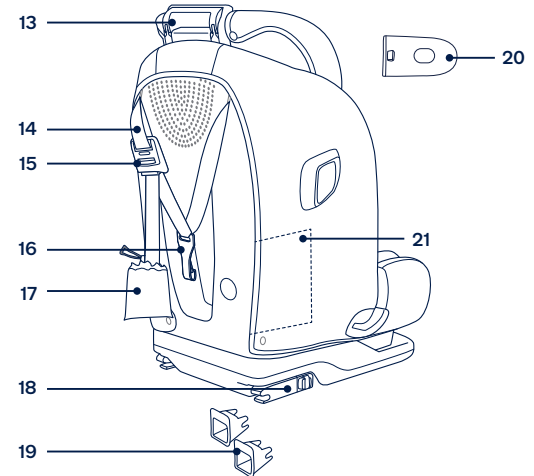
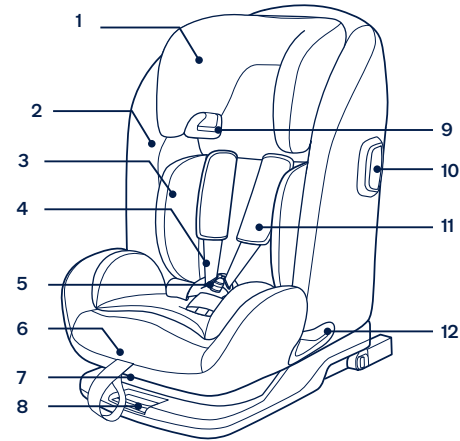

WARNING

DO BE cautious that the rigid items and plastic parts of the enhanced child restraint system shall be so located and installed that they are not liable to become trapped by a movable seat or in the door of the vehicle.

To use this enhanced child restraint according to the UN Regulation No.129, your child must meet the following requirements.

Forward Facing:

Child height 76cm -105cm / max. 19.5kg (harness system)

Forward Facing:

Child height 100cm - 150cm (vehicle belt)

IMPORTANT - DO NOT USE BEFORE THE CHILD'S AGE EXCEEDS 15 MONTHS (Refer to instructions)

When used for stature heights between 135cm and 150cm might not fit in all vehicles, due to a low position of the vehicle roof at the side.

The enhanced child restraint may not fit in all approved vehicles when used in any of these positions.

Any straps holding the enhanced child restraint to the vehicle should be tight.

Any straps restraining the child should be adjusted to the child's body, and straps should not be twisted.

DO NOT use any load bearing contact points other than those described in the instructions and marked on the enhanced child restraint.

After your child is placed in this enhanced child restraint, the safety belt must be used correctly. Ensure that any lap strap is worn low down, so that the pelvis is firmly engaged, shall be stressed.

This enhanced child restraint should be replaced when it has been subject to violent stresses in an accident. An accident can cause damage to it that you cannot see.

Consider the danger of making any alterations or additions to the device without approval of the adequate authority, and the danger of not following closely to the installation instructions provided by the enhanced child restraint manufacturer.

Please keep this enhanced child restraint away from sunlight, otherwise it may be too hot for child's skin. Always touch the enhanced child restraint before placing child in it.

DO NOT leave your child unattended in the enhanced child restraint system.

Any luggage or other objects liable to cause injuries in the event of a collision shall be properly secured.

The enhanced child restraint system shall **NOT BE USED** without the soft goods.

The soft goods should not be replaced with any other than the one recommended by the manufacturer, because the soft goods constitutes an integral part of the restraint performance.

Please check if this enhanced child restraint can be installed properly in your vehicle before you purchase it.

NO enhanced child restraint can guarantee full protection from injury in an accident. However, proper use of this enhanced child restraint will reduce the risk of serious injury or death to your child.

DO NOT install this enhanced child restraint without following the instructions in this manual or you may put your child at serious risk of injury or death.

DO NOT use this enhanced child restraint if it has damaged or missing parts.

DO NOT have your child in large/oversized clothes because this may prevent your child from being properly and securely fastened by the shoulder harness straps and the crotch strap between the legs.

Product Set Up

Installation Concerns

- ! DO NOT install this enhanced child restraint on vehicle seats with lab belts only. (1)
- ! This enhanced child restraint is suitable for vehicle seats with a 3-point retractor safety belt. (2) If your vehicle has ISOFIX anchor points, we strongly recommend that you connect the ISOFIX connector to the ISOFIX anchor points together. (3)
- ! DO NOT install this enhanced child restraint on vehicle seats that face sideways or rearward with respect to the moving direction of the vehicle.
- ! Please refer to your vehicle owner's manual for recommended or suggested installation positions. (4)-1
- ! This enhanced child restraint must be installed in the rear vehicle seat. (4)-2
- ! DO NOT install this on movable vehicle seats during installation.

Product Use

Use Side Impact Shield

- 1 - This enhanced child restraint is delivered with detachable side impact shield. This side impact shield must be used on the door side of the vehicle for best protection. Installation shown in fig. (5)
- 2 - Press the release button to remove side impact shield. (6)

Recline Adjustment

- 1 - Squeeze the recline adjustment button (7), to adjust the enhanced child restraint to the proper position. The recline angles are shown as (8).
- 2 - There are 3 recline positions for forward facing mode. (8)
 - ! Please confirm that the backrest adjustment engaged in place. (9)
 - ! The enhanced child restraint may not fit in all approved vehicles when used in one of these positions.

Height Adjustment

for Head Support and Shoulder Harnesses

- 1 - Please adjust the head support to proper height according to the child's height.
 - ! When used in toddler mode, the shoulder harness height must be even with child's shoulders. (10)-1
 - ! The maximum distance between the shoulder of baby and shoulder hole is 4 cm. (10)-2
 - ! When used in junior mode, the shoulder belt guides must be even with child's shoulders. (11)
- 2 - Squeeze the head support adjustment lever, meanwhile pull up or push down the head support until it snaps into one of the 9 positions. (12)(13)
 - ! Before adjusting the head support height have your child lean forward slightly.
 - ! As the head support is adjusted up (from 4th position), the sides of the child restraint automatically move outward to provide more shoulder room. (14)

Using in the Toddler Mode

(Child height 76cm-105cm/Child weight ≤ 19.5kg/15 months - approx. 4 years old)

- 1 - If required attach the ISOFIX guides onto the vehicle ISOFIX bars. (15)
 - ! Please adjust the seat to the most upright position before assembling enhanced child restraint.
- 2 - Open the tether storage cover, and place the top tether behind the vehicle seat. (16)
- 3 - Extend the ISOFIX connectors by pressing the release button whilst pulling on the connector. (17)
 - ! There are multiple positions for ISOFIX.
- 4 - Make sure that both ISOFIX connectors are securely attached to their ISOFIX anchor points. The colors of the indicators on both ISOFIX connectors should be completely green. (18)

- 5 - Press the ISOFIX release button and push the base back against the vehicle seat until tight. (19)
- 6 - To extend top tether for use, press button on tether adjuster and pull to lengthen. (20)
- 7 - Connect the tether hook securely to the anchorage fitting. (21)
 - ! Use top tether for installation if vehicle is equipped with a tether anchorage fitting and vehicle requirements are met (see vehicle owner's manual).
- 8 - Make sure that tether hook are securely attached to the anchorage fitting. (22) The colors of the indicators on tether strap adjuster should be completely green.
- 9 - The colors of the indicators on tether strap adjuster should be completely green. The colors of the indicators on both ISOFIX connectors should be completely green. (23)

Removing the enhanced child restraint

- 1 - Press the release button (24) to loosen the webbing and then detach the hook to remove the top tether. (25)
- 2 - To remove ISOFIX attachments from the vehicle's anchor points press the ISOFIX release button and pull the base back from the seat. (26)
- 3 - Then press and pull back on the ISOFIX connector on both sides. (27)
- 4 - For easy transporting, press the ISOFIX button and move the ISOFIX attachment back so it is stored completely. (28)

Securing your Child

- 1 - Press the webbing adjustment button, while pulling out the shoulder harnesses to the proper length. (29)
- 2 - Press the red button to disengage the buckle. (30)
- 3 - Place the buckle tongues against the magnetic area on the outer side of the child restraint so that the tongues are held in place. (31)
- 4 - Please use the infant insert to support the child if the child's shoulder is lower than the headrest bottom edge. (32)
- 5 - Place the child into the enhanced child restraint and pass both arms through the harnesses. (33)

- 6 - Engage the buckle. (34)

The green indicator shows that it has been buckled in place.

- 7 - Pull down the adjustment webbing and adjust it to the proper length so that your child is snugly secured. (35)

! Always keep child secured in harness and properly tightened by removing any slack.

! A too loose harness can cause severe injuries in case of an accident.

- 8 - The webbing is able to store under the soft goods. (36)

Using in the Junior Mode

(Child height 100cm-150cm/Approx. 3 years - 12 years old)

- 1 - Store the crotch belt cover, lap strap cover in a safe place. (37)
- 2 - Store the buckle and harness straps in a safe place. (38)(39)(40)

Securing your Child

For installation with 3-point belt

- 1 - Please check whether the vehicle shoulder belt guides are at the proper height that the bottom of the headrest **MUST** be even with the top of child's shoulders.
- 2 - Position the shoulder belt through the shoulder belt guide and pass the lap belt through the lap belt slots. Engage the vehicle buckle. (41).

! Shoulder belt must pass through shoulder belt guide. (42)-1

! Lap belt must pass through lap belt slots. (42)-2

! The enhanced child restraint can not be used if the vehicle safety belt buckle (female buckle end) is too long to anchor the enhanced child restraint securely. (42)-3

! **NEVER** use a 2-point vehicle belt (lap-belt only) to secure your child.

! **DO NOT** use shoulder belt loose or positioned under arm.

! **DO NOT** use shoulder belt behind child's back.

! **DO NOT** allow child to slide down in the enhanced child restraint in case of strangulation.

For installation with 3-point belt+ISOFIX system

- 1 - Installation with ISOFIX system as (15) - (19)
- 2 - Please check whether the vehicle shoulder belt guides are at the proper height that the bottom of the headrest **MUST** be even with the top of child's shoulders.
- 3 - Correctly assembled 3-point-belt is shown as (43)
 - ! Shoulder belt must pass through shoulder belt guide. (43)-1
 - ! Lap belt must pass through lap belt slots. (43)-2
 - ! The enhanced child restraint can not be used if the vehicle safety belt buckle (female buckle end) is too long to anchor the enhanced child restraint securely. (43)-3
 - ! Make sure that both ISOFIX connectors are securely attached to their ISOFIX anchor points. The colors of the indicators on both ISOFIX connectors should be completely green. (43)-4
 - ! Check to make sure the enhanced child restraint is securely installed by pulling on the both ISOFIX connectors. (43)-4
 - ! **NEVER** use a 2-point vehicle belt (lap-belt only) to secure your child.
 - ! **DO NOT** use shoulder belt loose or positioned under arm.
 - ! **DO NOT** use shoulder belt behind child's back.
 - ! **DO NOT** allow child to slide down in the enhanced child restraint in case of strangulation.

Detach Soft Goods

- 1 - Store the crotch belt cover, waist strap cover in a safe place. (44)
- 2 - Remove the Soft Goods shown as (45)(46)(47).
 - To assemble soft goods, reverse the steps above.

Cleaning and Maintenance

Wash the soft goods with cold water under 30°C.

DO NOT iron the soft goods.

DO NOT bleach or dry clean the soft goods.

DO NOT use undiluted detergents, gasoline or other organic solvents to wash the enhanced child restraint. It may cause damage to the product.

DO NOT twist the soft goods and inner padding to dry with great force. It may leave the soft goods and inner padding with wrinkles.

Please hang dry the soft goods and inner padding in the shade.

Please remove the enhanced child restraint from the vehicle seat if not in use for a long period of time. Put the enhanced child restraint in a cool, dry place and somewhere your child can not access it.

Vehicle Fitting Information

The numbers on the diagram below correspond with the vehicle fitting positions listed in the following pages.

Before you purchase the vehicle, check that it is equipped with the appropriate anchorages.



IMPORTANT-DO NOT USE BEFORE THE CHILD'S AGE EXCEEDS 15 MONTHS. (Refer to instructions)

- Your enhanced child restraint can be fitted
- ✗ Your enhanced child restraint can not be fitted

Please consult your vehicle user manual or dealer when fitting this seat in a vehicle with under-floor storage boxes.

! Vehicles with a cabin roof height which could restrict the seat being installed forward facing.

If your vehicle is not listed in this manual or it is not marked with either a • or ✗ then please refer to your vehicle's handbook or contact the manufacturer for further information. Seat positions in other cars may also be suitable to accept the enhanced child restraint.

This fitting-list was carefully prepared using scientific data collected from both vehicle and car seat. No liability is accepted for the accuracy of the list, which is for guidance purposes only. You are advised to check that the seat you purchase is compatible with your car at the time of purchase.

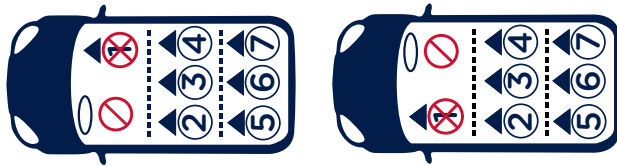

NOTE