

Designed
around your life

**重要!保留以備參照，
請詳細閱讀**

**使用產品前請仔細閱讀本說明書，並妥
善保存說明書以便日後參考。**

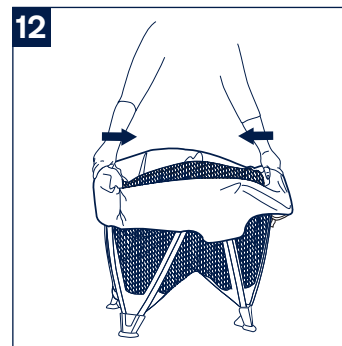

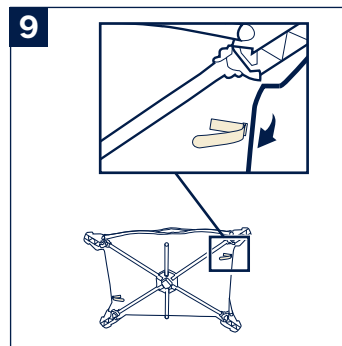
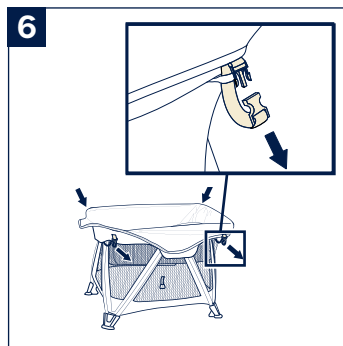
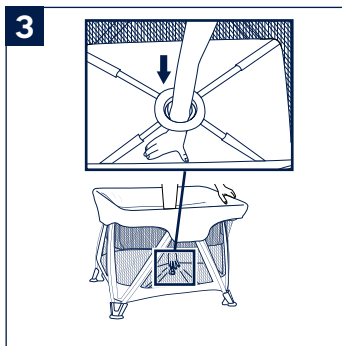
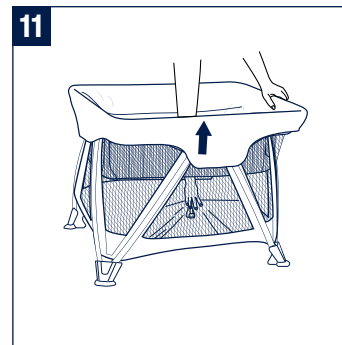
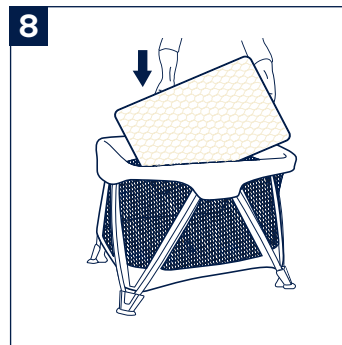
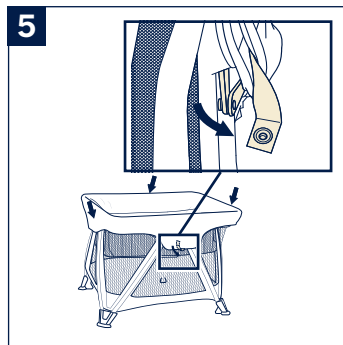
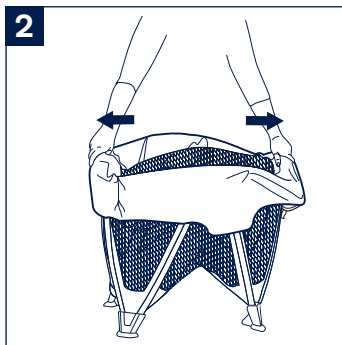
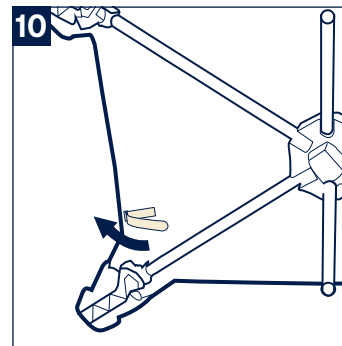
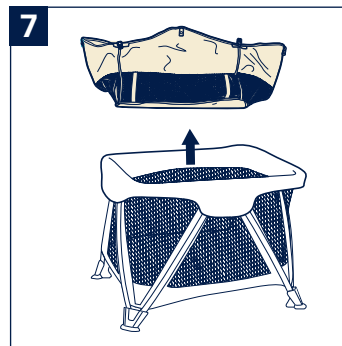
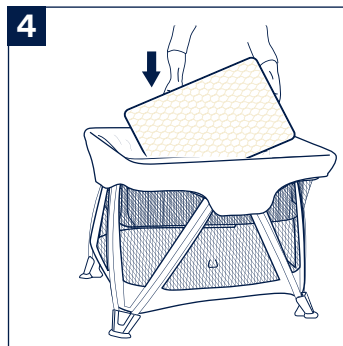
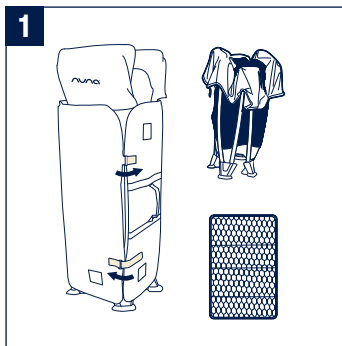

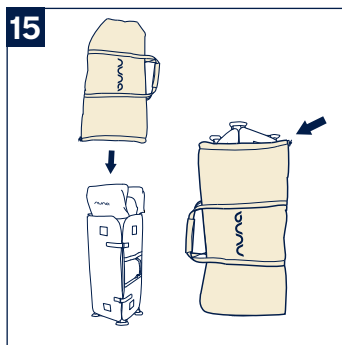
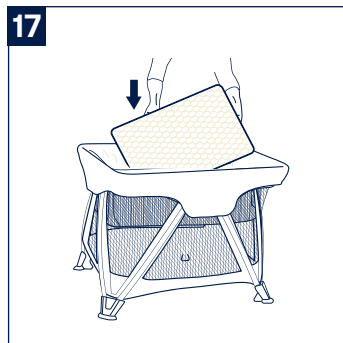
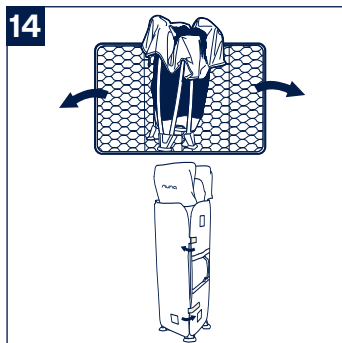
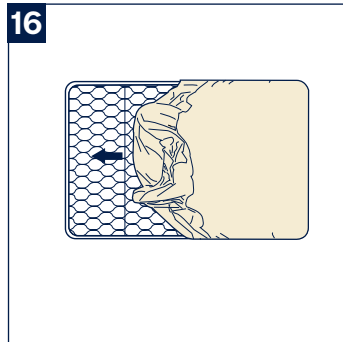
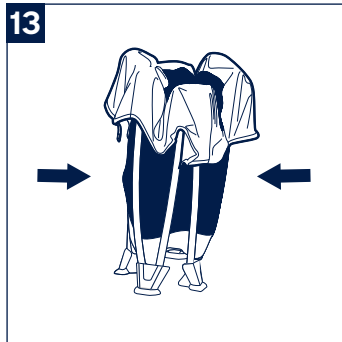

目錄

產品資訊	2
保固與售後服務	
保固條件	
聯絡我們	
適用範圍	4
緊急情況處理	4
警告	5
紙箱內含物	7
打開嬰兒床	8
組裝吊床	8
安裝嬰兒床	8
收合嬰兒床	9
收納嬰兒床	9
安裝床墊罩	10
維護與保養	10
English	12

產品資訊

產品名稱：_____

生產日期：_____

保固與售後服務

產品於保固期間內發生問題，請與零售商聯絡；若零售商無法提供服務，他們會連絡當地的NUNA經銷商。請留意嬰兒床底部的產品型號與生產日期序號。當有保固需求時，請提供以上產品資訊。

請至www.nunababy.com/tw/gear-registration網站登記您購買的產品。

保固條件

保固始於產品購買日，我們提供維修服務，但不提供產品退換。保固期限不會因零件更換或維修而延長。Nuna有權利針對產品進行改善設計，此前製造的產品則無更換義務。

相關保固資訊，詳見官網：
www.nunababy.com/tw/warranty

聯絡我們

我們期望不斷改進並開發新的產品，請隨時告知您對Nuna產品的意見和建議。

taiwanservice@nunababy.com
www.nunababy.com/tw

品 名
型 號

材 質

尺寸(cm)

淨重(kg)

床板厚度

最大容與載重量

委 製 商

進 口 商

地 址

電 話

統一編號

代 理 商

地 址

電 話

統一編號

原 產 地

SENA aire 嬰兒床

SENA aire

鋁/鐵、布、塑膠

105.6 x 77 x 74.5

10

25mm

15kg

巧兒宜國際股份有限公司

巧兒宜國際股份有限公司

台北市內湖區瑞光路431號2樓

02-27973000

52603333

杏豐實業股份有限公司

台北市中華路一段59號10樓之1

02-66358858

16998578

中國

適用範圍

為防止跌落的危險，本產品專為以下小朋友設計：

適用年齡：0-36個月

身高：不超過86cm

體重：不超過15kg

此產品符合歐洲標準 EN 16890:2017+A1:2021相關規範。

當小朋友能爬出嬰兒床時，請停止使用本產品。

緊急情況處理

意外發生時，應盡速送醫急救處理。

警告

Nuna嬰兒床擁有專利，並符合安全標準CNS 11676:2019相關規範。

請務必依照產品說明書和警告以避免導致嚴重傷害甚至是死亡事件發生。

- ! 請隨時照看好您的小朋友，切勿讓小朋友單獨留在嬰兒床內而無人看護。
- ! 將小朋友放入嬰兒床前，請確保嬰兒床已完全直立，所有鎖定裝置都已完全鎖定。
- ! 小朋友在嬰兒床內時，請勿移動嬰兒床。
- ! 應遠離火源。要注意嬰兒床周圍附近的明火與其他如電熱棒、瓦斯燃火等強熱源之風險。
- ! 每次使用本產品前，請檢查嬰兒床是否損壞、零件部件是否丟失、是否有銳邊，並確認所有固定裝置都已正確安裝。請隨時檢查螺絲是否鬆動，因為小朋友的身體或衣服(如繩子、項鍊、洋娃娃的絲帶等)會被夾到，從而導致勒斃危險。
- ! 嬰兒床如有任何零件破損、扯裂或遺失，切勿使用，並僅能使用製造廠商認可之備用零件。
- ! 本產品只能搭配NUNA原廠專門配件使用。
- ! 切勿在嬰兒床內留下任何物品，或將嬰兒床放置於可提供踩踏或存有窒息或纏繞危險之其他產品附近，例：繩索，百葉窗/窗簾拉繩等。
- ! 請在水平地面上使用本產品。

- ！ 本產品必須配合床墊使用。
- ！ 請遠離小朋友組裝和收合本產品，收合後須存放到小朋友接觸不到的地方。
- ！ 無人看管時，請勿讓小朋友在嬰兒床附近玩耍。
- ！ 為安全使用本產品，床墊長度和寬度應分別大於94cm和67.3cm，只有滿足此條件，床墊和嬰兒床四周的空隙才不會超過30mm。床墊的厚度須滿足以下條件：將床墊置於嬰兒床底部時，床墊上表面到嬰兒床頂端的距離應不小於500mm，將床墊置於吊床內時，床墊上表面到嬰兒床頂端的距離應不小於200mm。
- ！ 警告：最低使用狀態為最安全，且一旦嬰兒長大到可以坐立時，嬰兒床底板應一直使用在此最低使用狀態。
- ！ 嬰兒床內使用之床墊勿超過一個。僅能使用隨此嬰兒床一起出售之床墊，不要在此嬰兒床上加入第二個床墊，會產生窒息危害。
- ！ 請勿讓小朋友爬出嬰兒床或把外袋當玩具玩耍。
- ！ 當小朋友能夠坐立、爬行或站立時，請停止使用吊床。
- ！ 只能在吊床內放置一張床墊，吊床只能搭配Nuna原廠專門配備的床墊使用。
- ！ 床墊未組裝到吊床或嬰兒床上時，請勿使用。
- ！ 無人看管時，請勿讓小朋友在吊床附近玩耍。

- ！ 所有組裝連接固定件應正確的固定且必要時必須定期對這些固定件進行檢查及重新固定。
- ！ 當嬰兒能攀越嬰兒床時，嬰兒床不得再供該嬰兒使用，以防止跌落傷害。
- ！ 僅當鎖定機構嚙合時，並在使用前小心檢查完全嚙合後，嬰兒床方可使用。
- ！ 所有組裝配件須正確旋緊，且配件須定期檢查，必要時重新旋緊。

紙箱內含物

使用之前請確保本產品有包含所有零件。產品需成年人組裝。

工具：不需要工具

1 嬰兒床

2 床墊

3 外袋

4 床墊罩

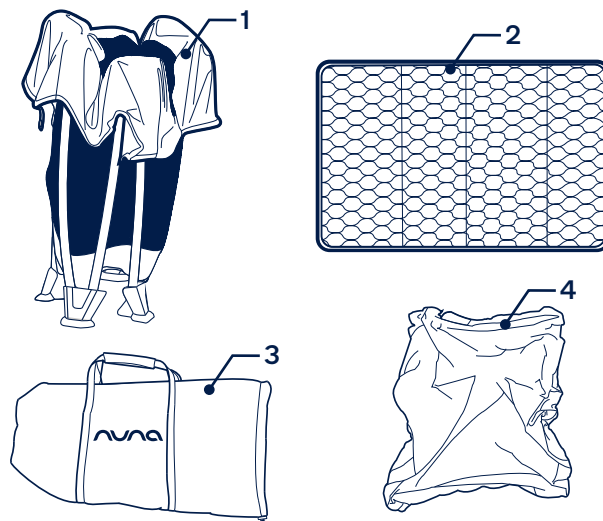

打開嬰兒床

- 1- 打開嬰兒床時，鬆開床墊上的黏扣帶，並展開床墊。(1)
 - 2- 將嬰兒床低的兩側向外推。(2)
 - 3- 穿過吊床按壓嬰兒床底中央，壓下嬰兒床內的底部收合塑膠。(3)
- ！ 確保床架的底座有被完全推下至地面。

組裝吊床

- 1- 安裝時床墊軟的一面須始終朝上，吊床安裝完成。(4)

安裝嬰兒床

- 1- 從吊床內移出床墊。解開四邊中間的鐵片上的吊床固定鈕扣。(5)
 - 2- 解開四個角落布環固定的安全扣。(6)
 - 3- 拆下吊床，並且妥善保存。(7)
 - 4- 將床墊置入嬰兒床底時，請將床墊上黏扣帶穿過嬰兒床內的孔，並黏緊黏扣帶。(8)
 - 5- 將帶子穿過嬰兒床底部的孔，然後繞過管件並扣合，其他幾個角重複以上步驟。(9)
- ！ 按壓床墊的四個角落，黏牢床墊與嬰兒床的黏扣帶。

收合嬰兒床

- 1- 解開黏扣帶。將床墊從嬰兒床內取出。(10)
- 2- 將嬰兒床底部的織帶拉起。吊床在嬰兒床上時，可穿過吊床底部中間的開口，拉起織帶。(11)
- 3- 將嬰兒床四面向中間緩緩靠攏。請勿強迫靠攏。(12)

收納嬰兒床

- 1- 收納嬰兒床前，需先將嬰兒床收合。(13)
- 2- 用床墊包住收合的床架，並黏合床墊上的黏扣帶。(14)
- 3- 將產品放入袋子內並拉緊繩子。(15)

安裝床墊罩

警告

為防止窒息或纏繞危險，床墊罩有牢固的固定在床墊上才可以使用。

- 1- 將床墊罩套在床墊上，請確保床墊罩有牢固地連接在四個角上。(16)
- 2- 將裝有床墊罩的床墊放置在吊床內時，請確保床墊罩上的四對黏扣帶有牢固地連接在嬰兒床的四個角上。(17)

維護與保養

可用沾上肥皂水的海綿擦拭嬰兒床。座布不可移除。請勿浸泡。請勿使用漂白劑或強腐蝕性洗滌劑。

使用或收納本產品前，須使產品完全乾燥。請勿將本產品曝露在熱源附近或陽光下。

吊床和外袋可用溫水和家用肥皂洗滌並晾乾。請勿使用漂白劑。

維護與保養(床墊)

清洗床墊前，需將拉鏈拉開，然後將床板抽出。

清洗床墊前請將拉鏈拉起來。可以用溫和的家用肥皂清洗床墊並晾乾。不可使用漂白劑。

重新安裝床板，將床墊黑色板上的數字與床板上的標對應安裝。

如圖，床板安裝時數字要朝上。

！ 沒有安裝床板的床墊不可以使用。

將床板安裝到正確的槽內後拉上拉鏈。

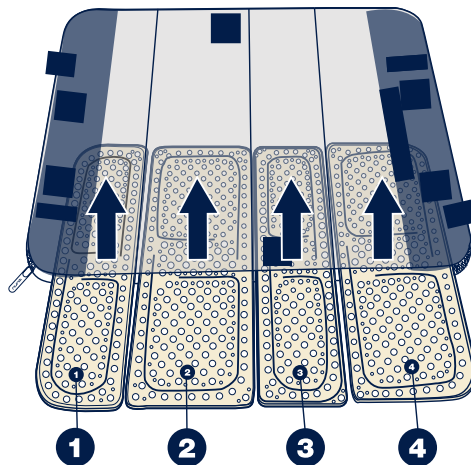
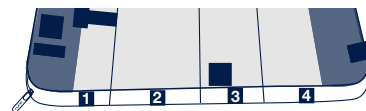

IMPORTANT!
KEEP THESE
INSTRUCTIONS FOR
FUTURE REFERENCE!
READ CAREFULLY

Contents

Product Information	14
Product Registration	
Warranty	
Contact	
Child Usage Requirements	15
Warnings	16
Parts List	20
Opening the Nuna Travel cot	21
To Set Up the Bassinet	21
To Set Up the Travel cot	21
Folding the Travel cot	22
Storing the Travel cot	22
Attaching the Sheet (on certain models)	22
Cleaning and Maintenance	23

Product Information

Model Number: _____

Manufactured Date: _____

Product Registration

All products include a serial label which lists the product model number and serial number. This label is located on the bottom of the travel cot. Before contacting customer service, please have these numbers available for reference.

To register your product please visit:

www.nunababy.com

Click the “Register Gear” link on the homepage.

Warranty

We have purposely designed our high-quality products so that they can grow with both your child and your family. Because we stand by our product, our gear is covered by a custom warranty per product, starting from the day it was purchased. Please have the proof of purchase, model number and manufactured date available when you contact us.

For warranty information please visit:

www.nunababy.com

Click the “Warranty” link on the homepage.

Contact

For replacement parts, service, or additional warranty questions, please contact our customer service department.

info@nunababy.com

www.nunababy.com

In the United Kingdom:

infouk@nunababy.com

www.nunababy.com

NUNA International B.V.

Van der Valk Boumanweg 178 C

2352JD Leiderdorp

The Netherlands

Child Usage Requirements

This travel cot is suitable for use with children who meet the following requirements:

Child: from birth

Weight: 15 kg

Height: 86 cm

This product complies to EN 16890:2017+A1:2021

Discontinue use of the SENA aire travel cot when the child is able to climb out.

⚠ WARNING

Failure to follow these warnings and the instructions could result in serious injury or death.

Be sure the product is completely set up before use, including side rails fully erected, center of the floor pushed down completely, and mattress/pad flat.

To prevent from falls, discontinue use of this product when child is able to climb out, reaches the height of 86 cm, or weighs more than 15 kg.

Child can become entrapped and die when improvised netting or covers are placed on top of product. Never add such items to confine child in product.

The bassinet must be fully assembled and installed before using, including 4 corner buckles, 4 snaps under center flaps, and mattress/pad is flat, before using.

If a sheet is used with the pad, use only the one provided by Nuna or one specifically designed to fit the dimension of the pad.

To help prevent falls, do not use the bassinet when the infant begins to push up on hands and knees.

Strings can cause strangulation! Do not place items with a string around a child's neck, such as hood strings or pacifier cords. Do not suspend strings over a bassinet or attach strings to toys.

Use bassinet with only one child at a time.

Do not place the SENA aire travel cot close to another product which could provide a foothold or present a danger of suffocation or strangulation, e.g. strings, blind/curtain cords, etc.

Always use on a flat, level floor.

Keep all children away from the SENA aire travel cot during assembly and folding. When folded store away from children.

Once the child can sit up, the SENA aire travel cot mattress should be used in it's lowest position which is the safest position.

Do not allow children to climb inside or play with the carry bag.

When a child is able to sit, kneel or to pull itself up, the bassinet must not be used anymore for this child.

Young children should not be allowed to play unsupervised in the vicinity of a travel cot.

All assembly fittings should always be tightened properly and that fittings should be checked regularly and re-tightened as necessary.

The travel cot should be locked in the fixed position when a child is unsupervised in it.

DO NOT use the bassinet when it is not attached to the SENA aire travel cot frame.

DO NOT move the SENA aire travel cot with your child in it.

DO NOT add anything to the inside of the SENA aire travel cot that will allow your child to climb out, or any article that may pose a risk of suffocation or strangulation.

DO NOT modify travel cot or add any attachments that are not listed in the owner's manual.

NEVER use this product if there are any loose or missing fasteners, loose joints, broken parts, or torn mesh/fabric. Check before assembly and periodically during use. Use only spare parts approved by the manufacturer.

NEVER add a mattress, pillow, comforter, or padding. Use **ONLY** mattress/pad provided by Nuna. Using a thicker or a different sized mattress/pad may allow a child's head to get between mattress/pad and side of the travel cot causing suffocation.

NEVER use plastic shipping bags or other plastic film as mattress covers not sold and intended for that purpose. They can cause suffocation.

NEVER use the mattress without the boards installed.

NEVER place the product near a window where cords from blinds or drapes can strangle a child.

NEVER leave bassinet in place when child is in travel cot.

NEVER place a child under the bassinet.

NEVER use a water mattress with this product.

Strings and cords can cause strangulation! **NEVER** place items with a string around a child's neck such as hood strings, pacifier cords, etc. Keep strings and cords away from child.

NEVER suspend strings on or over the product or attach strings to toys.

NUNA SENA aire travel cot is **NOT** for commercial use.

WARNING Do not use more than one mattress in the SENA aire travel cot. Only use the base mattress supplied by the manufacturer for use with the SENA aire travel cot.

WARNING Do not use more than one mattress in the bassinet. Only use the base mattress supplied by the manufacturer for use with the bassinet.

WARNING Ensure that the SENA aire travel cot is fully erected and all the locking mechanisms engaged before placing your child in this SENA aire travel cot.

WARNING DO NOT Place the travel cot close to an open fire and other sources of strong heat, such as electric bar fires, gas fires etc. in the near vicinity of the travel cot.

WARNING ALWAYS provide the supervision necessary for the continued safety of your child. When used for playing, never leave child unattended.

WARNING Only use the mattress sold with this travel cot, do not add a second mattress on this one, suffocation hazards.

Parts List

Check that you have all the parts for this product before using it. The assembly must be performed only by adults
Tools : No tools required.

- | | |
|--------------|---------------|
| 1 Travel cot | 3 Storage bag |
| 2 Mattress | 4 Sheet |

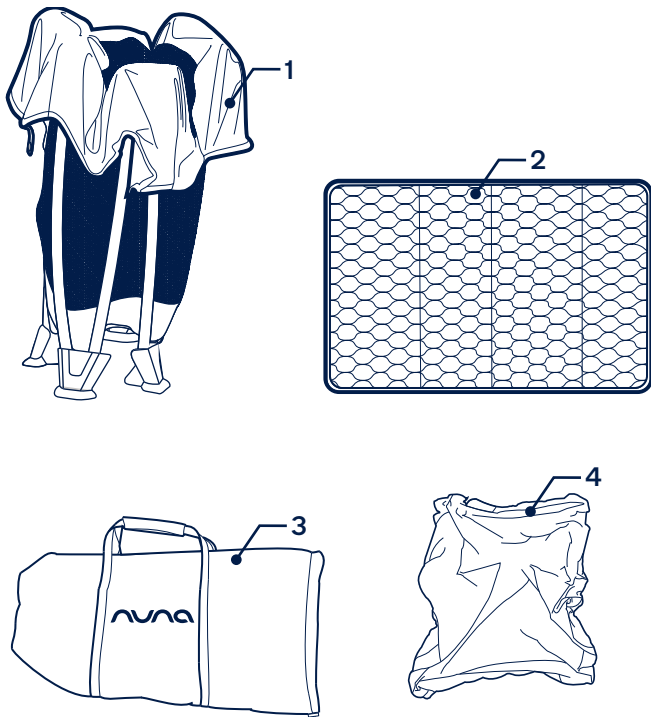

Opening the Nuna Travel Cot

- 1 - To open the travel cot frame, unfasten hook and loop straps from the mattress and unfold. (1)
 - 2 - Pull the short sides of the travel cot frame outward. (2)
 - 3 - Reach through bassinet and push down on the center hub at the bottom of travel cot. (3)
- ! MAKE SURE bottom of travel cot is pushed all the way to the floor.

To Set Up the Bassinet

- 1 - Install mattress soft side up. Bassinet set up is complete. (4)

To Set Up the Travel Cot

- 1 - Remove mattress from the bassinet. Remove the 4 snaps on the bassinet fabric from the snaps at the center of each side of the travel cot. (5)
 - 2 - Release the 4 buckles on the four corners of the travel cot. Once the buckle is separated, remove long strap from the loop on the travel cot. (6)
 - 3 - Remove the bassinet from travel cot. (7)
 - 4 - Place the mattress on the bottom of the Travel cot. (8)
 - 5 - Feeding the straps on the corners through the holes. Fasten the hook and loop. Repeat on other corners. (9)
- ! Push down on all four corners of the mattress to assure the mattress is secured to the bottom of travel cot.

Folding the Travel Cot

- 1 - Release the hook and loop straps. Remove mattress from the travel cot. (10)
- 2 - Grab strap on bottom of travel cot and pull up. (11)
- 3 - Push sides together towards the center. Do not force. (12)

Storing the Travel cot

- 1 - To store the travel cot frame, fold the frame. (13)
- 2 - Wrap the unit with the mattress, guide the hook and loop fasteners straps through the rings and attach them. (14)
- 3 - Place the bag over the unit and pull the drawstring together. (15)

Attaching the Sheet (on certain models)

WARNING

Prevent possible suffocation or entanglement. **NEVER** use travel cot sheet unless it fits securely on travel cot mattress.

- 1 - Wrap the sheet around the mattress on all four corners. **MAKE SURE** sheet is securely attached to the four corners. (16)
- 2 - Once the sheet is attached place the mattress inside the travel cot. **MAKE SURE** that the four hook and loop patches on the sheet are securely attached to the four corners of the travel cot. (17)

Cleaning and Maintenance

Your travel cot can be spot cleaned with a sponge and mild soapy water. The covering material is not removable.

DO NOT soak.

DO NOT use bleach or harsh detergents.

The travel cot must be thoroughly dried before using or storing – Avoid exposure to heat and sunlight.

Your storage bag can be washed in lukewarm water using mild household soap and then drip-dry.

DO NOT USE BLEACH.

Cleaning and Maintenance (Cont.)

To wash your mattress, you will need to remove your boards by unfastening the zipper and pulling the boards out.

ALWAYS fasten the zipper on the mattress before washing. Your mattress can be washed in lukewarm water using mild household soap and then drip-dry. **DO NOT USE BLEACH.**

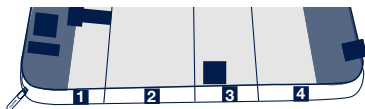

To re-install boards, match the number on the black tag on the mattress with the label on the board.

Boards should be installed with the numbers facing up exactly as shown in the illustrations.

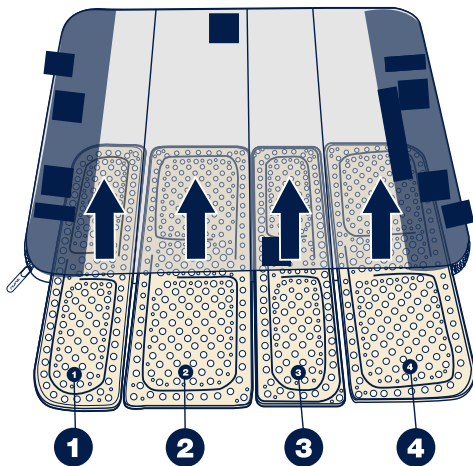

! **NEVER** use the mattress without the boards installed. Once boards are installed in their correct slots, refasten the zipper.

NUNA International B.V. Nuna and all associated logos are trademarks.