

Designed
around your life

nuna®

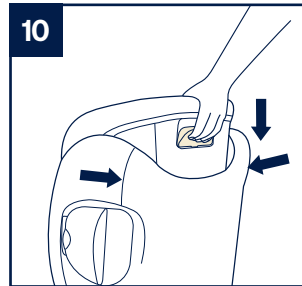

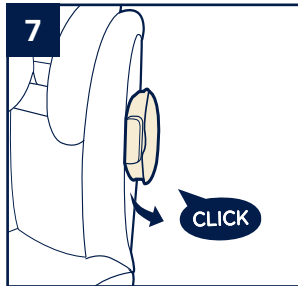

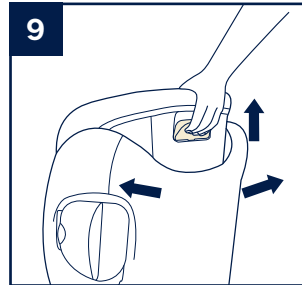
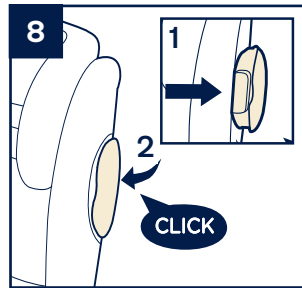
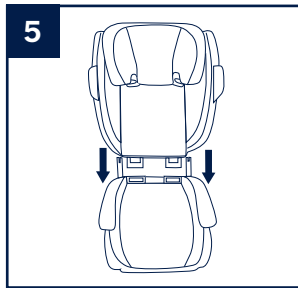
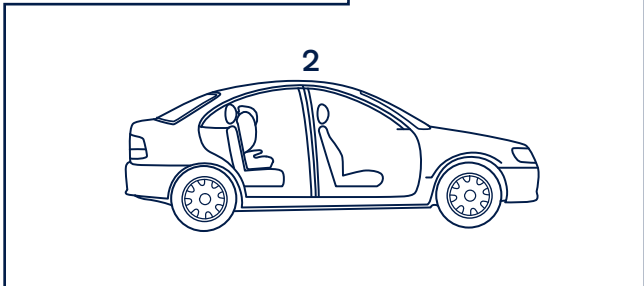
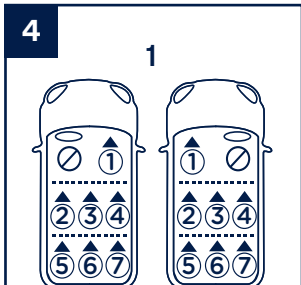
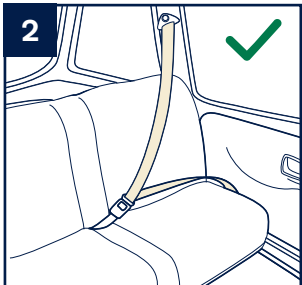
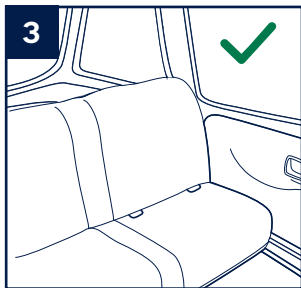
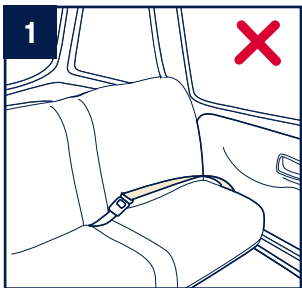
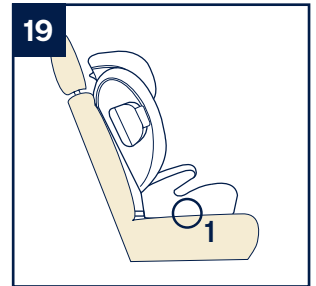
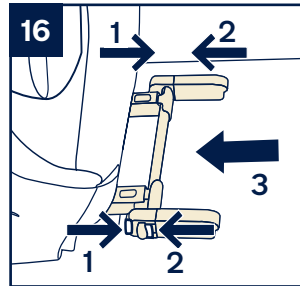
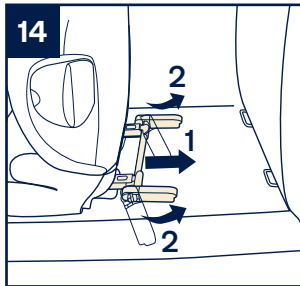
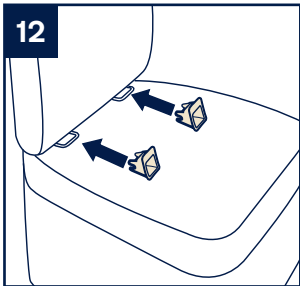
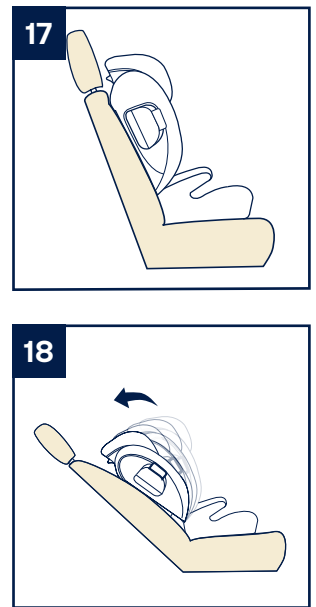
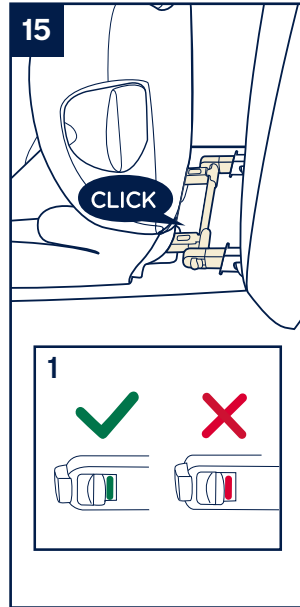
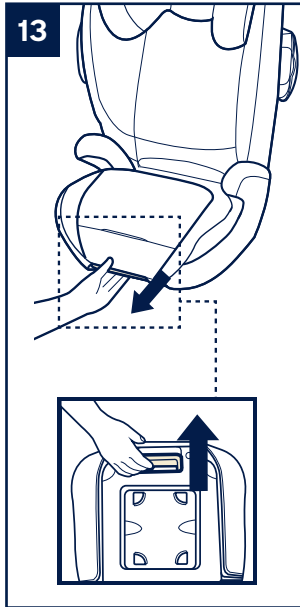
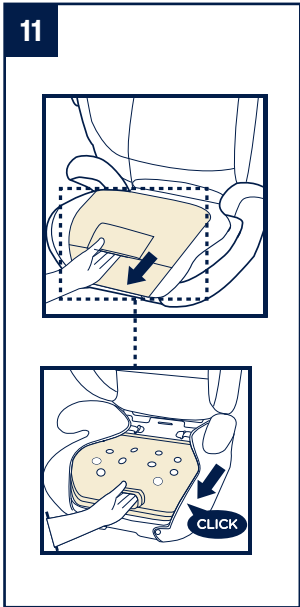
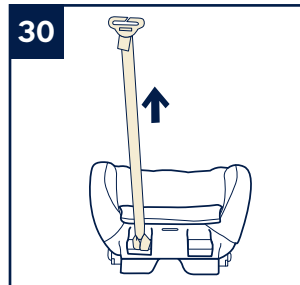
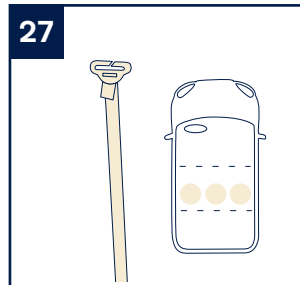
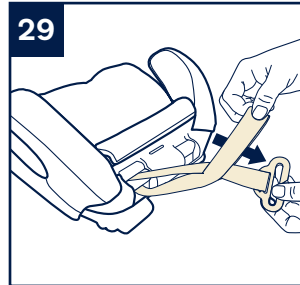
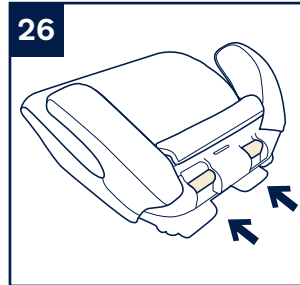
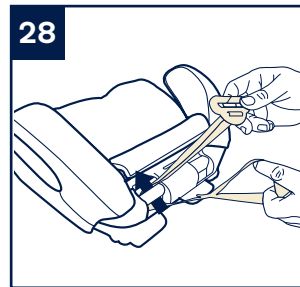
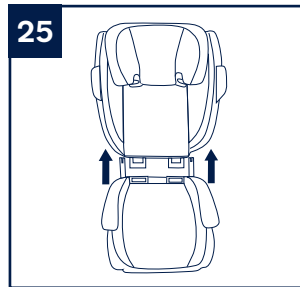
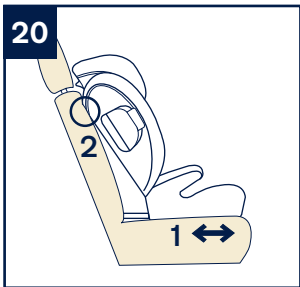

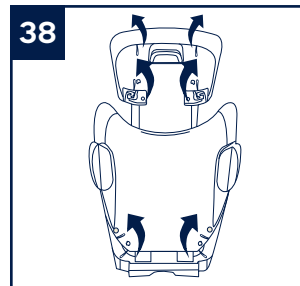
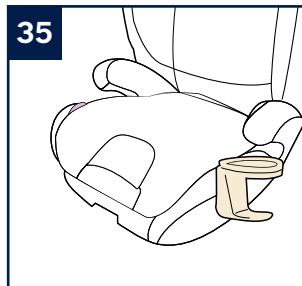
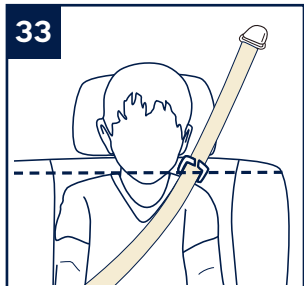
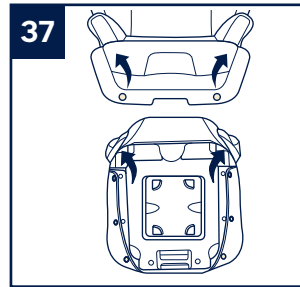
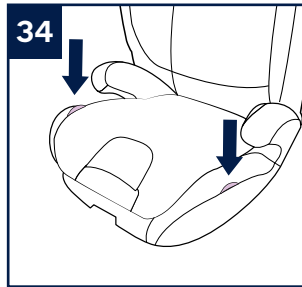
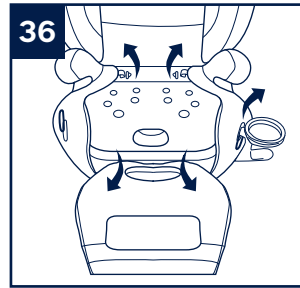
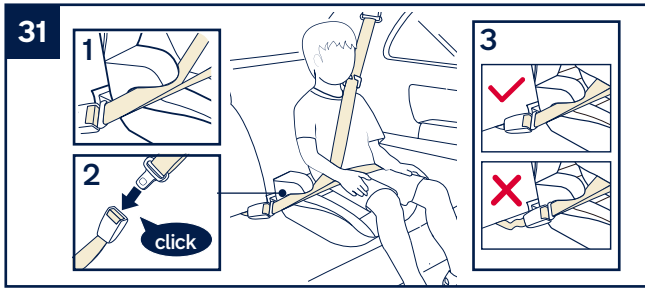

IMPORTANT!
KEEP THESE
INSTRUCTIONS FOR
FUTURE REFERENCE:
READ CAREFULLY

Contents

Product Information	3
Warranty	
Contact	
Child Usage Requirement	4
For Use with Base	5
Parts List	6
Warnings	7
Product Set Up	9
Product Use	9
Cleaning and Maintenance	13
Vehicle Fitting Information	14
繁中	15

Product Information

Model Number: _____

Manufactured in (date): _____

Product Registration

Please fill in the above information. The model number and the manufactured in date are located on the bottom of the AACE.

To register your product please visit:
www.nunababy.com

Warranty

We have purposely designed our high-quality products so that they can grow with both your child and your family. Because we stand by our product, our gear is covered by a custom warranty per product, starting from the day it was purchased. Please have the proof of purchase, model number and manufactured in date available when you contact us.

For warranty information please visit:
www.nunababy.com

Contact

For replacement parts, service, or additional warranty questions, please contact our customer service department.

info@nunababy.com
www.nunababy.com

In the United Kingdom:
infouk@nunababy.com
www.nunababy.com

NUNA International B.V.
 Van der Valk Boumanweg 178 C
 2352JD Leiderdorp
 The Netherlands

Child Usage Requirements

This product is suitable for use with children who meet the following requirements:

Mass Group: 2, 3

Weight: 15 - 36 kg (approximately 3 - 12 years old).

This booster is approved to UN ECE regulation 44, 04 series of amendments. This booster can be installed using a 3-point retractable adult seat belt, approved to UN ECE regulation 16 or other equivalent standards.

For Use with Base



For Installation with 3-point-belt

- 1 - This booster is a 'Universal' child restraint. It is approved to UN ECE regulation 44, 04 series of amendments, for general use in vehicles and it will fit most, but not all car seats.
- 2 - A correct fit is likely if the vehicle manufacturer has declared in the vehicle handbook that the vehicle is capable of accepting a 'Universal' child restraint for this age group.
- 3 - This booster has been classified as 'Universal' under more stringent conditions than those which applied to earlier designs which do not carry this notice. If in doubt, consult either the booster manufacturer or the retailer.

For Installation with ISOFIX anchor points and 3-point-belt

- 1 - This booster is a 'Semi-Universal' child restraint. It is approved to UN ECE regulation 44, 04 series of amendments for general use in vehicles fitted with ISOFIX anchor points.
- 2 - It will fit vehicles with positions approved as ISOFIX positions (as detailed in the vehicle handbook), depending on the category of the booster and of the fixture.
- 3 - If in doubt, consult either Nuna or vehicle manufacturer.

Parts List

- | | | | |
|---|----------------------|----|-----------------------------------|
| 1 | Head Support | 9 | Head Support Adjustment Lever |
| 2 | Lower Back Support | 10 | Side Impact Protection (SIP) Pod |
| 3 | Soft Goods | 11 | ISOFIX Latch |
| 4 | Shoulder Belt Guides | 12 | ISOFIX Guides |
| 5 | Seat Back | 13 | ISOFIX Release Lever (under seat) |
| 6 | Armrest | 14 | Instructional Manual (under seat) |
| 7 | Seat Bottom | 15 | Shoulder Belt Positioning Clip |
| 8 | Cupholder | | |

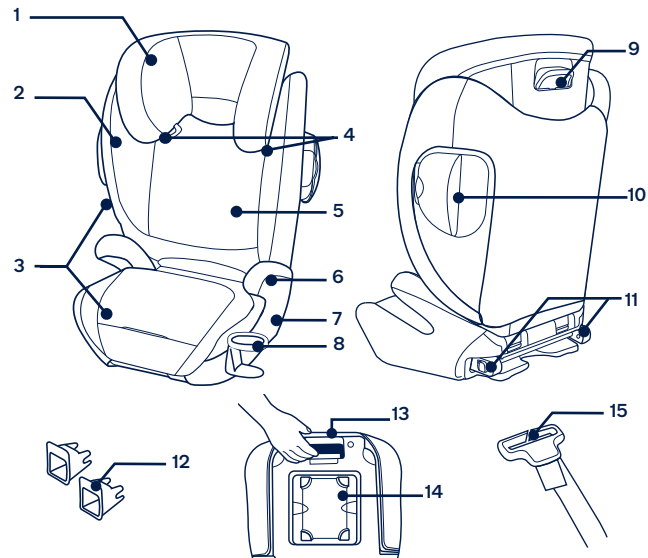

! WARNINGS

Failure to properly use this booster increases the risk of serious injury or death in a sharp turn, sudden stop or crash.

This booster is designed **ONLY** for child weighing 15–36 kg (approximately 3–12 years old).

Take care to locate and install the booster so that it is not liable to become trapped by a moveable seat or in a door of the vehicle.

Vehicle seat belt straps should be tight against child and not twisted.

Properly position the Vehicle Lap & Shoulder Belt on your child. A loose or improperly positioned Vehicle Lap & Shoulder Belt could cause the child to be ejected in a sudden stop, turn or crash and cause serious injury or death.

Make sure the Vehicle Lap & Shoulder Belt are not loose.

The Vehicle Shoulder Belt should rest on the child's shoulder and across the center of the chest.

The Vehicle Lap Belt must remain snug across the child's thighs.

Replace the booster after an accident of any kind. An accident can cause damage to the booster that you cannot see.

The booster can become very hot if left in the sun. Contact with these parts can burn your child's skin. Always touch the surface of any metal or plastic parts before putting your child in the booster.

According to accident statistics, children are safer when properly restrained in rear vehicle seating positions, rather than front seating positions. For a vehicle with a front passenger air bag, refer to your vehicle owner's manual as well as these instructions for a booster installation.

The soft goods should not be replaced with any besides the ones recommended by the manufacturer, because the soft goods constitute an integral part of the booster performance.

To avoid burns, never put hot liquids in your booster's cupholder.

DO NOT modify your booster or use any accessories or parts supplied by other manufacturers.

DO NOT use another manufacturer's soft goods with this booster. See your retailer for Nuna replacement parts only.

DO NOT use in any configuration not shown in the instructions.

DO NOT use this booster without the soft goods.

DO NOT use any load bearing contact points other than those described in the instructions and marked on the booster.

DO NOT face your booster toward the rear of the vehicle.

NEVER leave your child unattended.

NEVER give this booster to someone else without also giving them this manual.

NEVER use a second-hand child restraint or a booster whose history you do not know.

NEVER use a booster if it has damaged or missing parts. **DO NOT** use a cut, frayed or damaged vehicle seat belt.

NEVER leave a booster unsecured in your vehicle. An unsecured booster can be thrown around and may injure occupants in a sharp turn, sudden stop or crash. Remove it or make sure that it is secured in the vehicle.

NEVER leave luggage or other objects unsecured in a vehicle, they are liable to cause injuries in the event of a collision.

Product Set Up

Installation Concerns

- ! DO NOT install this booster on vehicle seats with Lap Belts only. **(1)**
- ! This booster is suitable for vehicle seats with a 3-point Retractor Safety Belt. **(2)** If your vehicle has ISOFIX Anchor Points, we strongly recommend that you connect the ISOFIX connector to the ISOFIX Anchor Points together. **(3)**
- ! DO NOT install this booster on vehicle seats that face sideways or rearward with respect to the moving direction of the vehicle.
- ! Please refer to your vehicle owner's manual for recommended or suggested installation positions. **(4)**-1
- ! This booster must be installed in the rear vehicle seat. **(4)**-2
- ! DO NOT install this on movable vehicle seats during installation.

Seat Assembly

- 1 - With the seat lying flat, attach the seat back to the booster seat bottom by hooking the seat back hooks over the seat bottom as shown. **(5)**
- 2 - Now rotate the seat back up until it clicks into position and the seat is fully upright as shown. **(6)**

Product Use

Side Impact Protection (SIP) Pods

- 1 - To open the SIP Pods pull out on the side tab **(7)**.
 - 2 - To close push button **(8)**-1 and push in **(8)**-2.
- ! SIP Pods should be deployed whenever the booster is installed in a vehicle. You may push in the inboard SIP pod if it interferes with an inboard passenger.

Height Adjustment for Head Support

- 1 - The Head Support height can be adjusted for best fit to your child and proper placement of the Vehicle Shoulder Belt.
- 2 - To adjust, squeeze the Head Support Adjustment Lever, then pull up **(9)** or push down **(10)** the Head Support until it locks into one of the 11 positions as shown.
 - ! Before adjusting the head support height have your child lean forward slightly.
 - ! As the Head Support is adjusted up, the sides of the seat automatically move outward to provide more shoulder room.

Seat Adjustment for Seat Bottom

The seat bottom depth can be adjusted for added comfort for the child. Three positions are provided for best fit.

- 1 - Reach under the cover as shown to adjust the seating surface in or out. **(11)**
- 2 - Slide the seating surface in or out as needed for additional thigh support. **(11)**

Use of ISOFIX Connectors

If vehicle is equipped with ISOFIX, the vehicle lower anchor points may be visible at the vehicle seat crease. See your vehicle owner's manual for exact locations, anchor identification, and requirements for use.

- 1 - Fit the ISOFIX guides with the ISOFIX anchor points **(12)**. The ISOFIX guides can protect the surface of the vehicle seat from being torn. They can also guide the ISOFIX connectors.
- 2 - Press the releasing button **(13)**, then pull the ISOFIX connectors out and rotate them by 180 degrees until they are pointing in the direction of the ISOFIX guides. **(14)**
- 3 - Line up the ISOFIX connectors with the ISOFIX guides, and then click both ISOFIX connectors into the ISOFIX anchor points. **(15)**
 - ! Make sure that both ISOFIX connectors are securely attached to their ISOFIX anchor points. The colors of the indicators on both ISOFIX connectors should be completely green. **(15)**-1

- ! Check to make sure the base is securely installed by pulling on both ISOFIX connectors.
- 4 - Press the releasing buttons on the ISOFIX connectors, and then pull the ISOFIX connectors out to remove the base. (16)
- 5 - Rotate the ISOFIX connectors by 180 degrees, and then press the releasing button to fold the ISOFIX connectors.
- 6 - The back of the booster MUST fit tight against the vehicle seat back as shown. (17)
 - ! The front of booster MUST NOT hang over front of vehicle seat.
 - ! Do not use with seat back beyond position 2. (18)
 - ! Connect booster to vehicle ISOFIX anchor points (See Use of ISOFIX Connectors). Ensure bottom of booster is in full contact with vehicle seat. (19)-1
 - ! Adjust the seat bottom by holding the ISOFIX Release Lever and moving the seat in or out to obtain desired angle as shown in (20)-1. Ensure the back of the booster is in contact with vehicle seat as shown in (20)-2.
- 7 - If you remove your vehicle headrest, be sure to stow it in a secure place; check your vehicle owner's manual.

Securing a Child in Booster

- ! Place the booster firmly against the back of a forward-facing vehicle seat equipped with a lap/shoulder belt.
- ! Have your child sit in the booster with their back flat against back of the booster seat.
- ! Position shoulder belt through the shoulder belt guide shown in (21)-1 (22)
- ! DO NOT position vehicle belt over top of the armrests. It must pass underneath the armrests. (21)-2

Route the vehicle safety belt through the belt path (21), and lock it into the buckle. (21)-3

- ! The booster can not be used if the vehicle safety belt buckle (female buckle end) is too long to anchor the booster securely. (21)-4
- ! The lap belt must be down low on pelvis.

- ! To ensure the correct head support height is obtained, the bottom of the headrest MUST be even with the top of child's shoulders as shown in (22).

- ! The Vehicle Shoulder Belt must route completely through the RED Shoulder Belt Guide and not fall off the child's shoulder. (23)

- ! If the belt lays across child neck, head or face, readjust head support height.

- ! Belt must not be twisted. Without back support

Adjust backrest to flat position, then one hand to detach backrest as (24)(25) to use base assembly independently.

- ! Please take good care of back support and head support.

- 1 - The Shoulder Belt Positioning Clip must be attached to the horizontal bar located on either side of the booster seat bottom. (26)
- 2 - The Shoulder Belt Positioning Clip can be installed on either side of the booster to achieve the best fit for your child in your vehicle. (27)
- 3 - Insert the loop end of the strap around the horizontal bar on the back of the booster. (28)
- 4 - Pass the Shoulder Belt Positioning Clip through the loop. (29)
- 5 - Pull up on the strap. (30)

Securing a Child in Booster

Route the Vehicle Belt through the RED lower belt path, located under the armrest (31)-1 and toward the vehicle buckle then secure the vehicle buckle and listen for a "click" (31)-2. The Vehicle Shoulder Belt should lie flat across the child's chest and the Vehicle Lap Belt should be snug across the child's thighs. The shoulder belt must lie across the child's shoulder.

- ! The booster can not be used if the vehicle safety belt buckle (female buckle end) is too long to anchor the booster securely. (31)-3

- ! It is important for the Vehicle Shoulder Belt to fall within the blue zone, shown in (32).

- ! Route the Vehicle Shoulder Belt through the Shoulder Belt Positioning Clip. Adjust the Shoulder Belt Positioning Clip by pulling down on the strap so the Shoulder Belt Positioning Clip is slightly above the child's shoulder as shown. (33)

Cupholder Assembly

Insert the Cupholder clip into the opening on either side of seat. **(34)** Make sure the Cupholder clip is fully inserted into both the fabric and plastic slot on booster. **(35)**

Soft Goods Disassembly

- 1 - Remove the Cupholder and pull out the seat bottom fabric by removing the 3 plastic attachments. **(36)**
- 2 - Open 8 snaps on seat bottom and remove soft goods. **(37)**
- 3 - On the main seat back cover, open the 2 snaps and unhook 4 elastic bands on the back side and remove. **(38)**
- 4 - On the Head Support, raise to highest position, then unhook 4 elastic bands and remove. **(38)**

To reassemble the soft goods simply reverse the steps above.

Cleaning and Maintenance

Wash the soft goods with cold water under 30°C.

DO NOT iron the soft goods.

DO NOT bleach or dry clean the soft goods.

DO NOT use undiluted detergents, gasoline or other organic solvents to wash the booster. It may cause damage to the product.

DO NOT twist the soft goods and inner padding to dry with great force. It may leave the soft goods and inner padding with wrinkles.

Please hang dry the soft goods and inner padding in the shade.

Please remove the booster from the vehicle seat if not in use for a long period of time. Put the booster in a cool, dry place and somewhere your child can not access it.

Vehicle Fitting Information

The booster with latch is classified for “Semi-Universal” child restraint system use. It is suitable for fixing into the seat positions of most cars. The figures on the diagram below correspond with the vehicle fitting positions listed in the following pages.

Seat positions in other cars may also be suitable to accept the booster. If in doubt, consult either the booster manufacturer or the distributor.

DO NOT install this booster on the front vehicle seats.

If your booster can be fitted, it is marked with •

If your booster cannot be fitted, it is marked with x

Electric or hybrid vehicles are marked with ⚡

If your vehicle is not listed in this manual or it is not marked with either a • or x then please refer to your vehicle’s handbook or contact the manufacturer for further information.



請妥善保存本說明書 以備不時之需!

使用產品前請仔細閱讀本說明書，並妥善保存以供日後參照。不依照本說明書的指示操作，可能會影響到您寶寶的安全。

目錄

產品資訊	17
保固條件	
聯絡我們	
兒童使用要求	19
安全須知與注意事項	19
產品組件及各部件名稱	21
警告安裝注意事項	24
兒童安全座椅使用	24
維修與保固	28
汽車安裝資訊	29

產品資訊

產品名稱：_____

生產日期：_____

保固與售後服務

產品於保固期間內發生問題，請與零售商聯絡；若零售商無法提供服務，他們會聯絡當地的Nuna經銷商。請留意產品底部的產品型號與生產日期序號。當有保固需求時，請提供以上產品資訊。

請至nunababy.com網站登記您購買的產品。

保固條件

保固始於產品購買日，我們提供維修服務，但不提供產品退換。保固期限不會因零件更換或維修而延長。Nuna有權利針對產品進行改善設計，此前製造的產品則無更換義務。

相關保固資訊，詳見官網：www.nunababy.com

聯絡我們

我們期望不斷改進並開發新的產品，請隨時告知您對Nuna產品的意見和建議。

info@nunababy.com
www.nunababy.com

產品名稱	汽車用兒童保護裝置
產品型號	AACE、CS-40-001TW
適用範圍	15-36公斤(約3 - 12歲)的寶寶
質量等級	II級、III級
主要材質	塑膠、五金、布
原產地	中國
委製商	巧兒宜國際股份有限公司
進口商	巧兒宜國際股份有限公司
地址	台北市內湖區瑞光路431號2樓
電話	02-27973000
統一編號	52603333
代理商	杏豐實業股份有限公司
地址	台北市中華路一段59號10樓之1
電話	02-66358858
統一編號	16998578

兒童使用要求

配合靠背頭靠使用

您的孩子必須完全符合以下要求，才可以使用本產品：

- 年齡: 約3-12歲
- 體重: 15-36公斤
- 身高: 96-150公分

不配合靠背頭靠使用

您的孩子必須完全符合以下要求，才可以使用本產品：

- 年齡: 約4-12歲
- 體重: 15-36公斤
- 身高: 101-150公分

安全須知與注意事項

使用本產品前，請仔細閱讀說明書。如有疑問，請諮詢兒童安全座椅製造商和進口商。

本兒童安全座椅適用符合CNS 3972或其他等效標準的三點式安全帶(不含兩點式安全帶)的汽車座椅，因本兒童安全座椅是依安全標準CNS 11497去做測試和認證的。

用三點式安全帶安裝

- 1- 這是“通用型”兒童保護裝置，符合安全標準CNS 11497。作為通用兒童保護裝置，適合大多數，而不是全部的汽車座椅。
- 2- 如果汽車製造商在使用手冊中述明可以讓適用此年齡段的“通用型”兒童保護裝置配合的話，那麼更容易達到正確的匹配。
- 3- 此兒童保護裝置歸類為“通用型”，比其他無標示此注意事項的兒童保護裝置可適用於較多車輛。

用三點式安全帶和連接器安裝

- 1- 這是“半通用型”兒童保護裝置，符合安全標準CNS 11497，可安裝在有二點式安全帶和有ISOFIX固定裝置的汽車座椅上。
- 2- 根據兒童保護裝置的類別和固定裝置的種類，安裝在ISOFIX固定的位置(如汽車手冊所述)。
- 3- 其他車輛型式亦有可能適用此兒童保護裝置，如有疑問，請諮詢兒童保護裝置製造商或車輛使用手冊。
- 4- 22-36公斤不配合背靠頭靠使用時，請勿使用連接器安裝。

產品組件及各部件名稱

- | | |
|---------|--------------|
| 1 頭靠 | 9 頭靠調整拉桿 |
| 2 背靠側翼 | 10 側向保護塑膠 |
| 3 座布 | 11 連接器 |
| 4 肩帶導向器 | 12 連接器導向器 |
| 5 背靠 | 13 連接器拉桿 |
| 6 扶手 | 14 說明書(底座下方) |
| 7 底座 | 15 肩帶固定夾 |
| 8 置物杯 | |

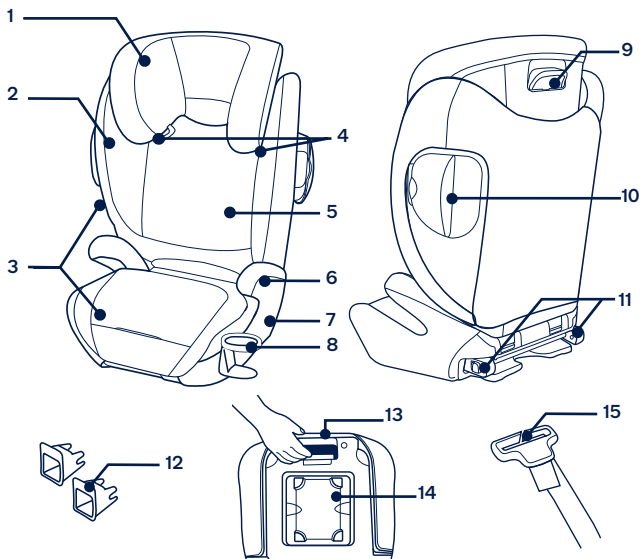

⚠ 警告

必須小心定位和安裝兒童安全座椅，以免被活動式座椅或車門卡住。

兒童安全座椅適用於體重15–36公斤(大約3–12歲的兒童)。

勿提供2歲以下兒童乘坐。

任何束縛兒童保護裝置至車輛之織帶應束緊，任何束縛兒童之織帶應根據兒童身體進行調節，且此織帶不應扭曲。

不正確使用或安裝本兒童安全座椅，當緊急剎車和急轉彎時，可能會導致嚴重受傷或死亡的危險。

請勿使用其它廠商生產的兒童安全座椅座布。請與進口商聯繫只可使用NUNA配件更換零件。

請勿使用說明中未有顯示的任何配件。

請勿將此產品安裝在前座上，防止意外發生時造成乘坐的兒童傷亡。

請勿讓您的孩童單獨留在兒童安全座椅內而無人照顧。

請勿將未使用汽車安全帶固定住的兒童座椅留在車內，以免緊急剎車時，傷害到其他乘客。若不經常使用兒童安全座椅時，請將其搬離汽車座椅。

任何行李或其他可能在碰撞中造成傷害之物品應適當牢固。

本兒童保護裝置若於意外中遭受劇烈撞擊後，不可繼續使用，應立即更換兒童保護裝置。意外可能導致兒童保護裝置產生潛在危險。

請勿擅自改造本兒童保護裝置，或使用其他廠商生產的零件來配合本兒童保護裝置使用。兒童保護裝置的性能會被影響，從而導致受傷或死亡。

將寶貴放在本兒童安全座椅後，必須正確的扣合安全帶，並確保腰部織帶能有效束縛骨盆部位。

請勿使用已經損壞或缺失零件的兒童安全座椅。請勿使用切割過的、磨損的或損壞的車輛安全座椅。

請讓座椅遠離日光，以免產品溫度過高對兒童的皮膚造成傷害。

請勿在未閱讀或了解本兒童安全座椅說明書及汽車說明書之前，使用或安裝本兒童安全座椅。說明書閱讀使用完畢後需放置回說明書儲存空間。

請勿使用二手兒童安全座椅或來歷不明的兒童安全座椅，因為它們可能存在危害乘坐兒童安全的潛在危險。

當本兒童安全座椅沒有座布時，請勿使用。

請勿使用非本製造商推薦的座布，否則會影響兒童成長汽車安全座椅的總體性能。

不要使用非說明書中所述以及兒童保護裝置中所標示的其他受力點。

請勿後向使用兒童安全座椅。

請勿將熱飲放入置物杯內，避免燙傷兒童。

安裝注意事項

安裝資訊

- ! 請勿將此汽車安全座椅安裝在二點式安全帶的汽車座椅上(1)
- ! 此汽車安全座椅適合安裝在設置有三點式安全帶的汽車座椅上(2)，如果有ISOFIX連接系統，強烈建議安裝在三點式安全帶和ISOFIX連接系統上(3)
- ! 請勿將此汽車安全座椅安裝在相對於汽車的行駛方向橫向。
- ! 關於汽車安全座椅安裝位置請參考汽車說明的相關說明(4)-1
- ! 請將此產品安裝在後座上，防止意外發生時造成乘坐兒童傷亡(4)-2
- ! 請勿將此汽車安全座椅安裝於可移動的汽車座椅上。

組裝底座

- 1- 當背靠安裝到底座上時先用力把背靠下壓，背靠上的U型鉤與底座上橫桿會相互卡合，安裝如圖(5)所示。
- 2- 當背靠正確安裝在底座上時，請依圖向前推起背靠(6)

兒童安全座椅使用

打開側向保護塑膠

- 1- 打開側向保護塑膠(7)
 - 2- 按壓按鈕(8)-1即可關閉側向保護塑膠(8)-2
- ! 必須打開側向保護塑膠才能更好的保護兒童的安全。如果汽車座椅乘車空間不足，可將靠近內側的側向保護塑膠關閉。

頭靠高度調整

- 1- 請根據兒童的身高，將頭靠調整到合適高度。頭靠的底部必須與兒童肩膀最高點平行。
- 2- 按壓頭靠調整拉桿，同時向上(9)或向下(10)滑動頭靠到合適高度，頭靠高度共有11個段位。
 - ！ 在頭靠調整高度之前，請讓乘坐的兒童稍微向前傾。
 - ！ 當頭靠向上調整時，背靠側翼會逐步打開，可增加使用空間。

座椅段位調整

座椅共有3個段位可供調節，符合不同兒童的身形。

- 1- 按壓座布下方的按鈕，同時拉或推可以調整座椅的位置(11)
- 2- 調整座椅的位置，更方便兒童大腿的支撐(11)

使用連接器安裝底座

如果在汽車座椅背靠下方有ISOFIX接口，可以使用連接器去連接。對它的位置和使用要求可以參考汽車使用說明。

- 1- 如需要請將連接器導向器固定到ISOFIX固定點上(12)，連接器導向器既可防止汽車座椅表面被刮破，又可為連接器安裝導向。
- 2- 按壓底座下方的連接器釋鎖按鈕(13)，將連接器拉出，並旋轉180度指向ISOFIX固定點上(14)
- 3- 將連接器固定在ISOFIX固定點上(15)
 - ！ 請保證連接器兩端已正確固定在ISOFIX固定點上。當正確固定時，連接器上的指示器應顯示綠色。(15)-1
 - ！ 同時往外拉兩邊的連接器，以檢查連接器已正確固定。
- 4- 移除底座時，按壓連接器上的第二道安全鎖和釋鎖按鈕，然後將底座往外拉即可(16)
- 5- 將連接器旋轉180度收納在底座下方。
- 6- 兒童安全座椅背靠必須緊貼汽車座椅。請按需要調整或移動汽車座椅頭靠，避免與兒童安全座椅有干涉(17)

- ！ 兒童安全座椅不能超過汽車座位的前方。
 - ！ 請勿將背靠調整到兒童安全座椅的兩個段位之外的位置使用本兒童安全座椅(18)
 - ！ 將汽車座椅調整為垂直狀況。將連接器固定在ISOFIX固定點上（參考“使用連接器安裝底座”），兒童安全座椅底部必須緊貼汽車座椅(19)-1
 - ！ 通過操作兒童安全座椅調整連接器拉桿來調整底座位置，將底座向內或向外移動來達到需要的背靠角度如圖(20)-1。確保兒童安全座椅背靠與汽車座椅接觸如圖(20)-2。
- 7- 請按需要調整或移動汽車座椅頭靠，避免與兒童安全座椅有干涉。

兒童乘坐

- ！ 兒童安全座椅必須正確安裝，肩帶必須要穿過紅色肩帶導向器。
 - ！ 正確調整頭靠位置，當您的孩子坐在兒童安全座椅時，讓他的背部平貼在兒童安全座椅背上。
 - ！ 肩帶必須要穿過紅色肩帶導向器並不從孩子肩膀上滑落(21)-1(22)
 - ！ 安全帶請勿從扶手上方通過。安全帶必須通過扶手下方(21)-2
- 安全帶安裝如圖(21)所示，扣合安全帶插扣座(21)-3
- ！ 汽車安全帶母扣段若太長，汽車安全帶無法綁緊不能使用(21)-4
 - ！ 腰帶穿過孩子大腿上方，必須固定在孩子骨盆較低的地方。
 - ！ 為保證正確的頭靠高度，頭靠的底部必須與兒童肩膀的最高點水平或略高(22)
 - ！ 肩帶必須要穿過紅色肩帶導向器並不從孩子肩膀上滑落(23)
 - ！ 如果安全帶橫跨了兒童的脖子、頭部或面孔，須重新調整頭靠高度。
 - ！ 請確保汽車安全帶沒有鬆弛或扭曲。

不配合背靠頭靠使用

平躺背靠，用手按住底座拆開背靠(24)(25)，底座可以單獨使用。

！請妥善保管背靠和頭靠。

- 1- 肩帶固定夾的織帶末端必須固定在底座的固定桿上(26)
- 2- 請正確選擇肩帶固定夾的織帶末端穿過底座固定桿的位置。保證該處是肩帶跨過孩子肩膀的最遠位置(27)
- 3- 肩帶固定夾的織帶末端穿過底座的固定桿(28)
- 4- 肩帶固定夾的夾器穿過織帶(29)
- 5- 向上拉緊織帶(30)

兒童乘坐

安全帶必須通過肩帶固定夾和扶手下方(31)-1，並扣合安全帶插扣座(31)-2。肩帶必須通過肩帶固定夾並不從孩子肩膀上滑落。腰帶穿過孩子大腿上方，必須固定在孩子骨盆較低的地方。

- ！汽車安全帶母扣段若太長，汽車安全帶無法綁緊不能使用(31)-3
- ！肩帶必須穿過藍色區域橫跨兒童肩膀，肩帶必須穿過肩帶固定夾(32)
- ！請確認肩帶穿過肩帶固定夾的位置，通過調整肩帶固定夾的織帶長短，保證肩帶固定夾略微超過兒童肩膀上方(33)

組裝置物杯

向下將置物杯裝入底座兩側(34)。保證置物杯固定點卡入底座座布和塑膠卡槽內(35)

拆卸座布

- 1- 移除置物杯並拆卸底座座布內的3個固定片(36)
 - 2- 打開8個鈕扣移除底座座布(37)
 - 3- 打開背靠的2個鈕扣和4根松緊帶(38)
 - 4- 將頭靠調到最高檔位，移除4根松緊帶(38)
- 依相反步驟即可重新組裝座布。

維修與保固

請以30度以下水溫清洗。

請勿使用熨斗熨燙。

請勿使用漂白劑及乾洗。

請勿使用未經稀釋的中性清潔劑、汽油或其他有機溶劑清洗兒童保護裝置，否則可能對兒童保護裝置造成損壞。

使用溫和的洗滌劑，水和柔軟的布清洗兒童安全座椅。

請勿大力扭乾，過大力扭乾可能留下皺褶。

請於陰涼處鋪平晾乾。

當長時間不使用本兒童安全座椅時，請將本兒童安全座椅從汽車座椅上拆除，並存放於陰涼處及貴賓不易接觸的地方。

汽車安裝資訊

本兒童安全座椅與連接器一起構成“半通用型”，適合大多數，而不是全部的汽車座椅。下圖中的數字與“汽車安裝資訊”內的數字相對應。其他汽車內的座椅位置也可能可以安裝本兒童保護裝置，以下車型為車款安裝適配性資料。如有疑問，請諮詢兒童保護裝置製造商或進口商。

請勿將本兒童安全座椅安裝在汽車前座上。

• 表示汽車座椅可安裝本兒童約束系統。

x 表示汽車座椅不可安裝本兒童約束系統。

⚡ 表示用電或其它混合驅動的車輛。

如果您的汽車品牌未被列入本說明書或未用“•”或“x”進行標示，請查閱您的汽車手冊或聯絡兒童約束系統製造商，以進一步了解相關資訊。

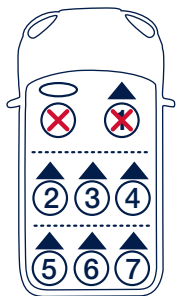

Installation with Latch System

① ② ③ ④ ⑤ ⑥ ⑦

Alfa Romeo

Giulietta (2010 >) x • x • - - -
Mito (2009 >) x • x • - - -

Audi

A1 (2011 >) x • x • - - -
A1 Sportback (2012 >) x • x • - - -
A3 Hatchback (2012 >) x • x • - - -
A3 (1996 - 2003) x • x • - - -
A3 S3 (2012 >) x • x • - - -
⚡ A3 e-Tron Sportback (2015 >) x • x • - - -
A3 Saloon (2014 >) x • x • - - -
A4 Allroad (2009 >) x • x • - - -
A4 Avant (2008 >) x • x • - - -
A4 Saloon (2008 >) x • x • - - -
A4 S4 (2009 >) x • x • - - -
A4 S4 Avant (2009 >) x • x • - - -
A5 (2007 >) x • x • - - -
A5 Sportback (2009 >) x • x • - - -
A5 S5 Sportback (2007 >) x • x • - - -
A6 (2011 >) x • x • - - -
A6 Allroad (2011 >) x • x • - - -
A6 Avant (2011 >) x • x • - - -
A6 S6 (2011 >) x • x • - - -
A7 Sportback (2011 >) x • x • - - -
A8 (2011 >) x • x • - - -
A8 S8 (2011 >) x • x • - - -
Q3 (2013 >) x • x • - - -
Q5 (2009 >) x • x • - - -
Q7 (2006 >) x • x • - - -
TT Coupe (2006 >) x • x • - - -

Bentley

Continental GT (2003 - 2011) x • x • - - -
Continental Flying Spur (2005 - 2012) x • x • - - -
Continental GTC (2005 - 2012) x • x • - - -
Mulsanne (2010 >) x • x • - - -

BMW

1 Series Convertible (2008 >) x • x • - - -
1 Series Coupe (2008 >) x • x • - - -
1 Series F20 (2011 >) x • x • - - -
2 Series Active Tourer x • x • - - -
2 Series Coupe x • x • - - -

		①	②	③	④	⑤	⑥	⑦
	3 Series Coupe (2007 >)	X	X
	3 Series F30 (2012 >)	X	X
	5 Series Saloon (2003 - 2010)	X	X
	5 Series Touring (2003 - 2010)	X	X
	5 Series Touring (2011 >)	X	X
	5 Series Saloon (2011 >)	X	X
	5 Series (2011 >)	X	X
	6 Series Coupe (2011 >)	X	X
	6 Series Convertible (2011 >)	X	X
	6 Series Gran Coupe (2011 >)	X	X
	7 Series (2010 >)	X	X
	i3 (2014 >)	X	X
	X1 (2010 >)	X	X
	X3 F25 (2011 >)	X	X
	X4 (2014 >)	X	X
	X5 (2007 >)	X
	X5 (2015)	X
	X6 (2008 >)	X	X
	X6 (2015)	X	X
	3-GT (2013 >)	X	X
	5-GT (2010 >)	X	X
Cadillac								
	BLS Saloon (2006 - 2011)	X	.	X
Chevrolet								
	Aveo (2012 >)	X	X
	Captiva (2007 >)	X	X
	Cruze (2009 >)	X	X
	Spark (2012 >)	X	X
	Volt (2011 >)	X	X
	Orlando (2011 >)	X	X
	Traxx (2013 >)	X	X
Chrysler								
	Grand Voyager (2008 >)	X	.	X
	300 C (2012 >)	X	.	X
	Delta (2011 >)	X	.	X
	Ypsilon (2011 >)	X	.	X
Citroen								
	Berlingo Multispace (2007 >)	X	.	X
	C1 (2006 >)	X	.	X
	C1 (2015)	X	.	X
	C3 5 Door (2009 >)	X	.	X
	C3 Picasso (2009 >)	X	.	X
	C4 (2010 >)	X	.	X

		①	②	③	④	⑤	⑥	⑦
	C4 Picasso (2007 >)	X
	C4 Picasso (2014 >)	X
	C5 Saloon (2008 >)	X	.	X
	C5 Tourer (2008 >)	X	.	X
	C-Cactus (2015 >)	X	.	X
	DS3 (2011 >)	X	.	X
	DS4 (2011 >)	X	.	X
	DS5 (2013 >)	X	.	X
Dacia								
	Duster (2012 >)	X	.	X
	Sandero (2013 >)	X	.	X
Fiat								
	500 (2008 >)	X	.	X
	500 C (2009 >)	X	.	X
	Abarth 500 (2009 >)	X	.	X
	Bravo (2007 >)	X	.	X
	500L (2013 >)	X	.	X
	Panda (2012 >)	X	.	X
	Grande Punto (2006 >)	X	.	X
	Abarth Grande Punto (2008 - 2011)	X	.	X
Ford								
	B Max (2012 >)	X	.	X
	C Max (2003 - 2012)	X	.	X
	Fiesta (2004 - 2008)	X	.	X
	Fiesta (2008 >)	X	.	X
	Focus (2010 >)	X	.	X
	Focus (2015 >)	X	.	X
	Focus CMax (2003 - 2010)	X	.	X
	Galaxy (2006 >)	X	.	X
	KA (2009 >)	X	.	X
	Kuga (2013 >)	X	.	X
	Mondeo Estate (2007 >)	X	.	X
	Mondeo Hatchback (2007 >)	X	.	X
	Mondeo Saloon (2007 >)	X	.	X
	Mondeo (2014 >)	X	.	X
	S Max (2006 >)	X	.	X
	CMax (2013 >)	X	.	X
Honda								
	Accord Saloon (2008 >)	X	.	X
	Accord Tourer (2008 >)	X	.	X
	Civic (2012 >)	X	.	X
	Civic (2006 - 2011)	X	.	X

	①	②	③	④	⑤	⑥	⑦
Civic Hybrid Saloon (2006 - 2010)	X	•	X	•	•	•	•
Civic Type R (2007 - 2010)	X	•	X	•	•	•	•
Civic Tourer (2014 >)	X	•	X	•	•	•	•
CRV (2007 - 2013)	X	•	X	•	•	•	•
CRV (2012 >)	X	•	•	•	•	•	•
Elysion (2012 >)	X	•	X	•	•	•	•
FRV (2006 - 2011)	X	•	X	•	•	•	•
Insight (2009 >)	X	•	X	•	•	•	•
Jazz (2008 >)	X	•	X	•	•	•	•
Odyssey (2010 >)	X	•	X	•	•	•	•

Hyundai

i10 Hatchback (2008 >)	X	•	X	•	•	•	•
i20 Hatchback (2009 >)	X	•	X	•	•	•	•
i30 (2012 >)	X	•	X	•	•	•	•
i40 (2011 >)	X	•	X	•	•	•	•
iX20 (2011 >)	X	•	X	•	•	•	•
iX35 (2010 >)	X	•	X	•	•	•	•
SantaFe (2012 >)	X	•	X	•	•	•	•
Tucson (2010 >)	X	•	X	•	•	•	•
Veloster (2012 >)	X	•	X	•	•	•	•

Infiniti

EX (2009 >)	X	•	X	•	•	•	•
FX (2009 >)	X	•	X	•	•	•	•
G Coupe (2009 >)	X	X	X	X	•	•	•
G Saloon (2009 >)	X	•	X	•	•	•	•
M (2010 >)	X	•	X	•	•	•	•

Jaguar

X-Type (2001 - 2010)	X	•	X	•	•	•	•
X-Type Estate (2004 - 2010)	X	•	X	•	•	•	•
XF (2008 >)	X	•	X	•	•	•	•
XF R (2009 >)	X	•	X	•	•	•	•
XF Sportbrake (2013 >)	X	•	X	•	•	•	•
XJ (2010 >)	X	•	X	•	•	•	•
XK (2006 >)	X	•	X	•	•	•	•
XK Convertible (2006 >)	X	•	X	•	•	•	•
XK R (2006 >)	X	•	X	•	•	•	•

Jeep

Grand Cherokee (2011 >)	X	•	X	•	•	•	•
Compass (2011 >)	X	•	X	•	•	•	•
Cherokee (2014 >)	X	•	X	•	•	•	•

Kia

	①	②	③	④	⑤	⑥	⑦
Carens (2013 >)	X	•	•	•	•	•	•
Ceed Hatchback (2012 >)	X	•	X	•	•	•	•
Optima (2011 >)	X	•	X	•	•	•	•
Picanto (2008 >)	X	•	X	•	•	•	•
Rio (2012 >)	X	•	X	•	•	•	•
Sorento (2012 >)	X	•	X	•	•	•	•
Sorento (2015)	X	•	X	•	•	•	•
Soul (2009 >)	X	•	X	•	•	•	•
⚡ Soul (2015 >)	X	•	X	•	•	•	•
Sportage (2011 >)	X	•	X	•	•	•	•
Venga (2010 >)	X	•	X	•	•	•	•

Land Rover

Discovery Sport (2015 >)	X	•	X	•	•	•	•
Discovery 4 (2009 >)	X	•	X	•	•	•	•
Freelander 2 (2006 >)	X	•	X	•	•	•	•
Range Rover (2013 >)	X	•	X	•	•	•	•
Range Rover (2002 - 2012)	X	•	X	•	•	•	•
Range Rover Sport (2005 - 2012)	X	•	X	•	•	•	•
Range Rover Sport (2013 >)	X	•	X	•	•	•	•
Range Rover Evoque (2011 >)	X	•	X	•	•	•	•

Lancia

Thema (2012 >)	X	•	X	•	•	•	•
Voyager (2010 >)	X	•	X	•	•	•	•
Ypsilon (2012 >)	X	•	X	•	•	•	•

Lexus

CT (2011 >)	X	•	X	•	•	•	•
⚡ GS (2013 >)	X	•	X	•	•	•	•
IS Saloon (2005 - 2012)	X	•	X	•	•	•	•
RX (2010 >)	X	•	X	•	•	•	•

Mazda

CX-5 (2011 >)	X	•	X	•	•	•	•
CX-7 (2007 - 2011)	X	•	X	•	•	•	•
2 (2007 >)	X	•	X	•	•	•	•
3 Hatchback (2009 >)	X	•	X	•	•	•	•
3 Saloon (2009 >)	X	•	X	•	•	•	•
3 Hatchback (2014 >)	X	•	X	•	•	•	•
5 (2005 - 2010)	X	•	X	•	•	•	•
6 Estate (2008 - 2012)	X	•	X	•	•	•	•
6 Hatchback (2007 - 2012)	X	•	X	•	•	•	•
6 Saloon (2007 - 2009)	X	•	X	•	•	•	•
6 Saloon (2013 >)	X	•	X	•	•	•	•
6 Estate (2012 >)	X	•	X	•	•	•	•

		①	②	③	④	⑤	⑥	⑦
Mercedes-Benz								
	A Class (2005 - 2012)	x	x
	A Class (2013 >)	x	x
	B Class (2012 >)	x
	⚡ B Class (2015 >)	x
	C Class (2008 >)	x	x
	C Class Estate (2008 >)	x	x
	C Class Coupe (2011 >)	x	x
	CLA (2013 >)	x	x
	CLS Shootingbrake (2012 >)	x	x
	CLS Coupe (2011 >)	x	x
	E Class Saloon (2009 - 2012)	x	x
	E Class Coupe (2009 >)	x	x
	E Class Estate (2013)	x	x
	E Class Saloon (2013 >)	x	x
	GL Class (2006 - 2012)	x
	M/ML Class (2005 - 2012)	x
	R Class (2006 - 2012)	x
	S Class (2006 - 2013)	x	x
	SL Class (2012 >)	x
	SLK (2011 >)	x
	V Class (2003 - 2014)	x
	V Class (2015 >)	x
Mini								
	Mini (Cooper) Hatchback (2006 - 2013)	x	.	x
	Mini (Cooper) Hatchback (2014 >)	x	.	x
	Mini Coupe (2009 >)	x
	Mini Countryman (2010 >)	x	.	x
	Mini Paceman (2013 >)	x	.	x
	Mini 5dr (2015 >)	x	.	x
Mitsubishi								
	ASX (2010 >)	x	.	x
	Colt (2007 - 2013)	x	.	x
	Lancer (2008 - 2011)	x	.	x
	Lancer Sportback (2008 - 2011)	x	.	x
	Lancer Ralliart (2009 - 2011)	x	.	x
	Outlander (2007 - 2013)	x	.	x
	Outlander (2013 >)	x	.	x
	⚡ Outlander (2015 >)	x	.	x
	Shogun (2007 >)	x	.	x
Nissan								
	Evalia (2012 -2014)	x
	Juke (2010 >)	x	.	x
	Micra (2011 >)	x	.	x

		①	②	③	④	⑤	⑥	⑦
	Note (2006 - 2013)	x	.	x
	Note (2014 >)	x	.	x
	Qashqai+2 (2008 >)	x	.	x
	Qashqai (2014 >)	x	.	x
	Quest MPV (2012 >)	x	.	x
	X-Trail (2007 >)	x	.	x
Opel								
	Adam (2013 >)	x	.	x
	Agila (2008 >)	x	.	x
	Ampera (2011 >)	x	.	x
	Antara (2007 >)	x	.	x
	Astra 5dr (2010 >)	x	.	x
	Astra Estate (2010 >)	x	.	x
	Astra GTC (2011 >)	x	.	x
	Corsa 3dr Hatchback (2006 >)	x	.	x
	Corsa 5dr Hatchback (2006 >)	x	.	x
	Corsa 5dr (2015 >)	x	.	x
	Corsa VXR (2007 >)	x	.	x
	Insignia Hatchback (2009 >)	x	.	x
	Insignia Saloon (2009 >)	x	.	x
	Insignia Sports Tourer (2009 >)	x	.	x
	Meriva (2010 >)	x	.	x
	Mokka (2013 >)	x	.	x
	Vivaro (2014 >)	x	x	x
	Zafira (2005 >)	x
	Zafira VXR (2005 >)	x
	Zafira Tourer (2014 >)	x
Peugeot								
	107 (2005 >)	x	.	x
	108 (2015 >)	x	.	x
	207 3dr (2006 - 2012)	x	.	x
	207 5dr (2006 - 2012)	x	.	x
	207 SW (2007 - 2012)	x	.	x
	2008 (2013 >)	x	.	x
	208 3dr (2013 >)	x	.	x
	208 5dr (2013 >)	x	.	x
	307 (2001 - 2007)	x	.	x
	307 Estate (2002 - 2007)	x	.	x
	308 Hatchback (2007 >)	x	.	x
	308 SW (2008 >)	x	.	x
	308 (2014 >)	x	.	x
	3008 (2009 >)	x	.	x
	508 (2011 >)	x	.	x
	508 SW (2011 >)	x	.	x
	⚡ 508 RXH (2013 >)	x	.	x
	5008 (2011 >)	x	.	x
	RCZ (2011 >)	x	.	x

	①	②	③	④	⑤	⑥	⑦
Porsche							
⚡ Cayenne (2011 >)	x	•	x	•	-	-	-
⚡ Panamera (2011 >)	x	•	x	•	-	-	-
Cayenne (2015 >)	x	•	x	•	-	-	-
Panamera (2015 >)	x	•	x	•	-	-	-
Renault							
Captur (2015 >)	x	•	x	•	-	-	-
Clio (2005 - 2012)	x	•	x	•	-	-	-
Clio Renault Sport (2006 - 2012)	x	•	x	•	-	-	-
Clio Sport Tourer (2007 - 2012)	x	•	x	•	-	-	-
Clio (2013 >)	x	•	x	•	-	-	-
Laguna (2008 - 2012)	x	•	x	•	-	-	-
Laguna Sport Tourer (2008 - 2012)	x	•	x	•	-	-	-
Megane Hatchback (2008 >)	x	•	x	•	-	-	-
Megane Sport Tourer (2009 >)	x	•	x	•	-	-	-
Modus (2004 - 2012)	x	•	x	•	-	-	-
Grand Modus (2008 - 2012)	x	•	x	•	-	-	-
Scenic (2009 >)	x	•	•	•	•	•	•
Trafic (2001 - 2014)	x	•	•	•	•	•	•
Twingo (2007 >)	x	•	x	•	-	-	-
Twingo (2012 >)	x	•	x	•	-	-	-
Twingo (2015 >)	x	•	x	•	-	-	-
Saab							
9-3 (2002 - 2012)	x	•	x	•	-	-	-
9-3 Sport Wagon (2005 - 2012)	x	•	x	•	-	-	-
9-3 X (2009 - 2012)	x	•	x	•	-	-	-
9-5 Estate (2005 - 2010)	x	•	x	•	-	-	-
9-5 (2011 - 2012)	x	•	x	•	-	-	-
Seat							
Alhambra (2010 >)	x	•	•	•	•	•	•
Altea (2004 - 2011)	x	•	x	•	-	-	-
Altea XL (2007 - 2011)	x	•	x	•	-	-	-
Altea Freetrack4 (2007 - 2009)	x	•	x	•	-	-	-
Exeo (2008 >)	x	•	x	•	-	-	-
Exeo ST Estate (2008 >)	x	•	x	•	-	-	-
Ibiza Cupra (2009 >)	x	•	x	•	-	-	-
Ibiza FR (2009 >)	x	•	x	•	-	-	-
Ibiza Hatchback (2008 - 2013)	x	•	x	•	-	-	-
Leon Cupra (2007 - 2011)	x	•	x	•	-	-	-
Leon FR (2006 - 2012)	x	•	x	•	-	-	-
Leon Hatchback (2005 - 2012)	x	•	x	•	-	-	-
Leon (2013 >)	x	•	x	•	-	-	-
Mii (2011 >)	x	•	x	•	-	-	-
Toledo (2013 >)	x	•	x	•	-	-	-

	①	②	③	④	⑤	⑥	⑦
Skoda							
Citigo (2012 >)	x	•	x	•	-	-	-
Fabia Estate Combi (2008 >)	x	•	x	•	-	-	-
Fabia Hatchback (2007 >)	x	•	x	•	-	-	-
Octavia Estate Combi (2005 - 2013)	x	•	x	•	-	-	-
Octavia Hatchback (2004 - 2012)	x	•	x	•	-	-	-
Octavia Scout (2007 - 2013)	x	•	x	•	-	-	-
Octavia Hatchback (2013 >)	x	•	x	•	-	-	-
Rapid (2013 >)	x	•	x	•	-	-	-
Roomster (2006 >)	x	•	x	•	-	-	-
Superb Combi Estate (2008 >)	x	•	x	•	-	-	-
Superb (2008 >)	x	•	x	•	-	-	-
Yeti (2009 >)	x	•	x	•	-	-	-
Smart							
For Two Coupe (2007 >)	x	-	-	-	-	-	-
Suzuki							
Alto (2009 >)	x	•	x	•	-	-	-
Grand Vitara (2006 >)	x	•	x	•	-	-	-
Splash (2008 >)	x	•	x	•	-	-	-
Swift Sport (2011 >)	x	•	x	•	-	-	-
SX-4 (2006 >)	x	•	x	•	-	-	-
SX-4 Saloon (2009 >)	x	•	x	•	-	-	-
Subaru							
BRZ (2012 >)	x	•	x	•	-	-	-
Forester (2013 >)	x	•	x	•	-	-	-
Impreza 5 Door (2013 >)	x	•	x	•	-	-	-
Legacy (2012 >)	x	•	x	•	-	-	-
Outback (2012 >)	x	•	x	•	-	-	-
XV Hatchback (2011 >)	x	•	x	•	-	-	-
Toyota							
Auris (2007 - 2012)	x	•	x	•	-	-	-
Auris (2013 >)	x	•	x	•	-	-	-
Avensis Hatchback (2003 - 2011)	x	•	x	•	-	-	-
Avensis Tourer (2009 >)	x	•	x	•	-	-	-
Aygo (2005 >)	x	•	x	•	-	-	-
Aygo (2014 >)	x	•	x	•	-	-	-
EZ MPV (2013 >)	x	•	x	•	-	-	-
GT86 (2012 >)	x	•	x	•	-	-	-
Highlander (2013 >)	x	•	x	•	-	-	-
Land Cruiser (2003 - 2009)	x	•	x	•	-	-	-

	1	2	3	4	5	6	7
⚡ Land Cruiser (2009 >)	X	X
Prius (2004 - 2009)	X	X
Prius (2010 >)	X	X
Prius (2015 >)	X	X
Prius Plus + (2012 >)	X	X
Rav 4 MK3 (2006 - 2011)	X	X
RAV4 (2013 >)	X	X
Verso (2009 - 2012)	X	X
Verso (2013 >)	X	X
Yaris Hatchback (2011 >)	X	X

Vauxhall

Adam (2013 >)	X	.	X
Agila (2008 >)	X	.	X
Ampera (2011)	X	.	X
Antara (2007 >)	X	.	X
Astra 5dr (2010 >)	X	.	X
Astra Estate (2010 >)	X	.	X
Astra GTC (2011 >)	X	.	X
Corsa D (2007 >)	X	.	X
Corsa 3dr Hatchback (2006 >)	X	.	X
Corsa 5dr Hatchback (2006 >)	X	.	X
Corsa 5dr (2015 >)	X	.	X
Corsa VXR (2007 >)	X	.	X
Insignia Hatchback (2009 >)	X	.	X
Insignia Saloon (2009 >)	X	.	X
Insignia Sports Tourer (2009 >)	X	.	X
Meriva (2010 >)	X	.	X
Mokka (2013 >)	X	.	X
Vivaro (2014 >)	X	.	.	.	X	X	X
Zafira (2005 >)	X
Zafira VXR (2005 - 2010)	X
Zafira Tourer (2012 >)	X

Volkswagen

Beetle (2012 >)	X	.	X
Multivan Caravelle (2008)	X	.	X
Golf Cabriolet (2009 - 2012)	X	.	X
Golf Hatchback (2009 - 2012)	X	.	X
⚡ Golf Hatchback MK7 (2012 >)	X	.	X
Golf Plus (2009 - 2011)	X	.	X
Jetta (2011 >)	X	.	X
Passat (2010 >)	X	.	X
Passat (2005 - 2010)	X	.	X
Passat Saloon (2015 >)	X	.	X
Passat Alltrack (2012 >)	X	.	X
Passat CC (2008 >)	X	.	X

	1	2	3	4	5	6	7
Passat Estate (2005 - 2011)	X	.	X
Passat Estate (2015 >)	X	.	X
Polo 3dr (2009 >)	X	.	X
Polo 5dr (2009 >)	X	.	X
Scirocco (2011)	X	.	X
Sharan (2010 >)	X	.	X
Tiguan (2008 >)	X	.	X
Touareg (2012 >)	X	.	X
Touran (2010 >)	X	.	X
Transporter 5 (2003 >)	X
UP! (2012 >)	X	.	X

Volvo

C30 (2007 - 2013)	X	.	X
S60 (2010 >)	X	.	X
S80 (2007 >)	X	.	X
V40 (2013 >)	X	.	X
V40 Cross Country (2012 >)	X	.	X
V60 (2011 >)	X	.	X
⚡ V60 (2015 >)	X	.	X
V70 (2008 >)	X	.	X
XC60 (2008 >)	X	.	X
XC70 (2008 >)	X	.	X
XC90 (2003 - 2013)	X	.	X	.	.	.	X